

1976 KX400-A2 PARTS DIAGRAM

SWING ARM/SHOCK ABSORBERS

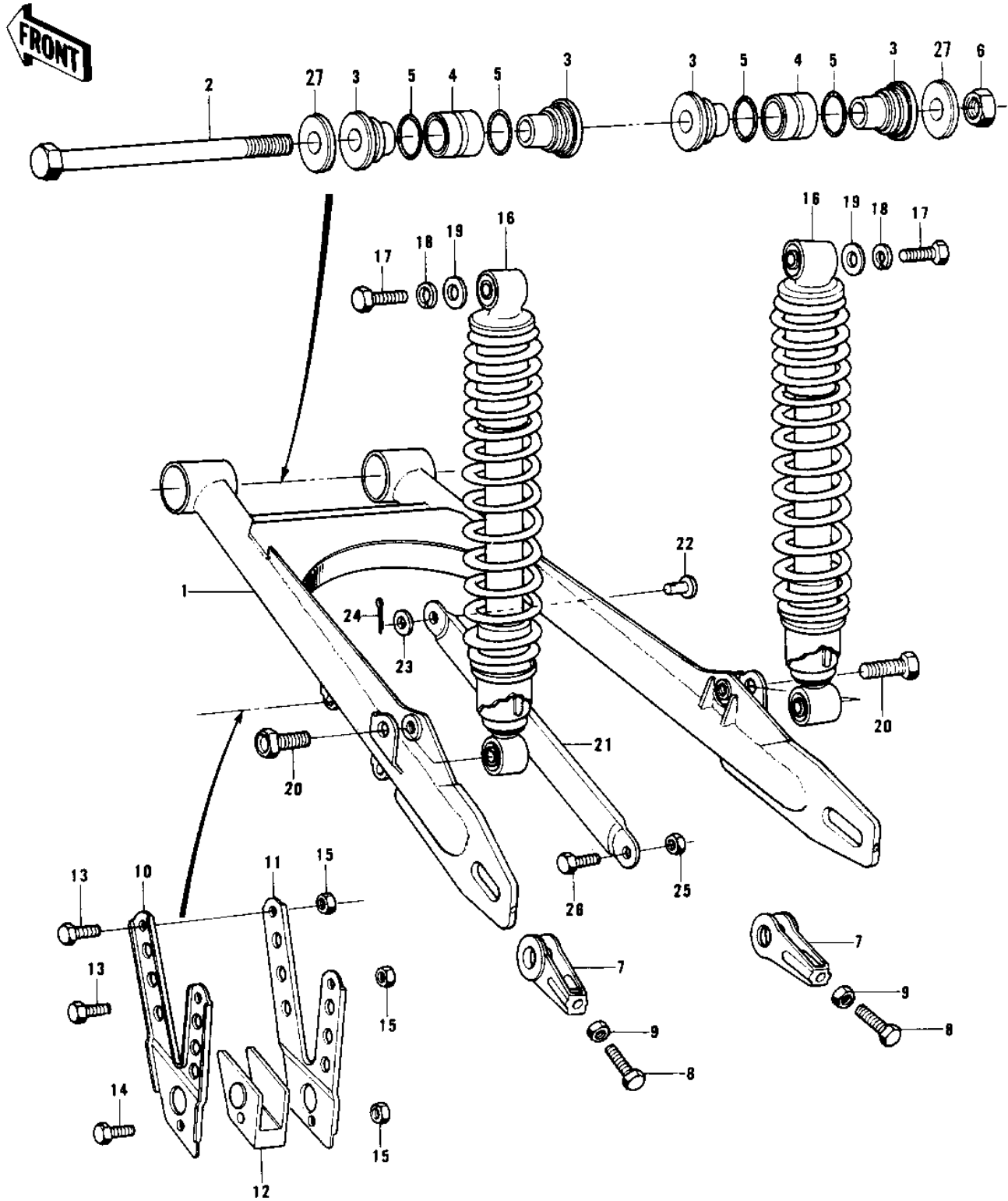

1976 KX400-A2 PARTS LIST

SWING ARM/SHOCK ABSORBERS

ITEM NAME	PART NUMBER	QUANTITY
ARM,SWING (Ref # 1)	33001-079	
SHAFT,SWING ARM PIVOT (Ref # 2)	33032-042	
SHAFT,SWING ARM PIVOT (Ref # 2)	33032-048	
SLEEVE,SWING ARM (Ref # 3)	33034-020	
BEARING,NEEDLE (Ref # 4)	92046-047	
"0" RING,22MM (Ref # 5)	670B3022	
OIL SEAL (Ref # 5)	92056-008	
NUT,12MM (Ref # 6)	92019-017	
ADJUSTER,CHAIN (Ref # 7)	33040-067	
BOLT,CHAIN ADJUSTER (Ref # 8)	92001-132	
NUT,8MM (Ref # 9)	312G0800	
GUARD,CHAIN,L.H (Ref # 10)	55020-017	
GUARD,CHAIN,R.H (Ref # 11)	55020-018	
GUARD,CHAIN (Ref # 12)	55020-019	
BOLT 6X35 (Ref # 13)	110R0635	
BOLT-UPSET,6X40 (Ref # 14)	112G0640	
NUT,6MM (Ref # 15)	92019-019	
SHOCK ABSBR RR (Ref # 16)	45014-104	
SHOCK ABSBR RR (Ref # 16)	45014-112	
BOLT-UPSET,6X12 (Ref # 17)	112G0612	
WASHER SPRING 6MM (Ref # 18)	461F0600	
WASHER,PLAIN,7MM (Ref # 19)	92022-228	
BOLT,HEX HEAD,12X35 (Ref # 20)	92001-133	
TORQUE LINK,RR BRAKE (Ref # 21)	43007-040	
PIN,TORQUE LINK (Ref # 22)	92043-105	
WASHER,PLAIN (Ref # 23)	92022-239	
PIN COTTER 2.0X20 (Ref # 24)	550D2020	
NUT,10MM (Ref # 25)	92019-016	
BOLT,10X28 (Ref # 26)	113G1028	

1976 KX400-A2 PARTS LIST

SWING ARM/SHOCK ABSORBERS

ITEM NAME	PART NUMBER	QUANTITY
WASHER PLAIN 12MM (Ref # 27)	411B1200	