

1980 KZ440-B1 PARTS DIAGRAM

FRAME FITTINGS ('80 B1)

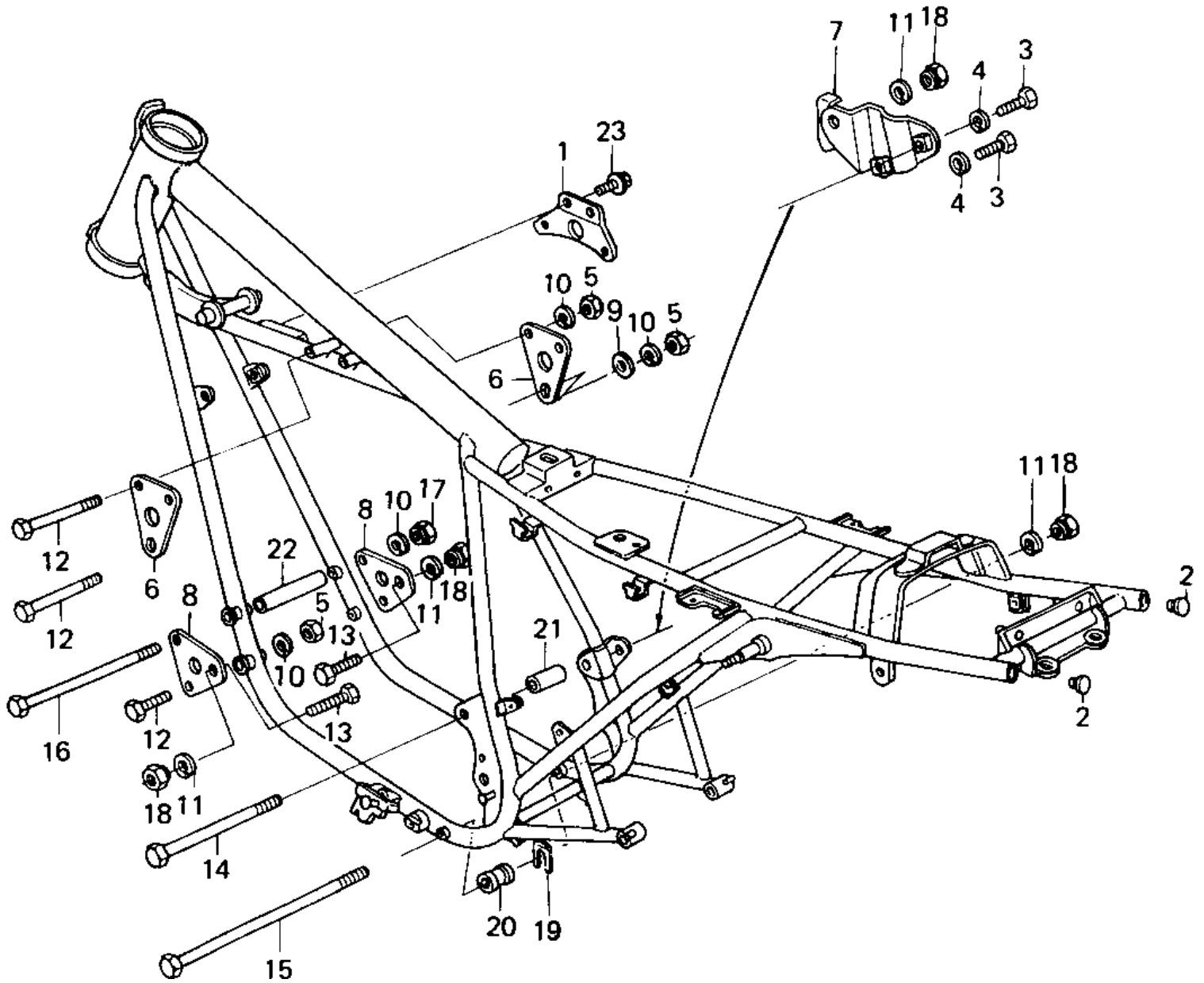

1980 KZ440-B1 PARTS LIST

FRAME FITTINGS ('80 B1)

ITEM NAME	PART NUMBER	QUANTITY
BRACKET,IGNITON COIL (Ref # 1)	32058-049	1
PLUG,FRAME RUBBER (Ref # 2)	32112-008	2
BOLT-SMALL-UPSET 8X25 (Ref # 3)	115G0825	2
WASHER SPRING 8MM (Ref # 4)	461F0800	2
NUT,8MM (Ref # 5)	311B0800	5
BRACKET,ENGINE (Ref # 6)	32029-1016	2
PLATE,ENG MOUNT,REAR (Ref # 7)	32030-034	1
PLATE,ENG MOUNT,FRNT (Ref # 8)	32030-044	2
WASHER PLAIN 8MM (Ref # 9)	411B0800	1
WASHER SPRING 8MM (Ref # 10)	461F0800	6
WASHER SPRING 10MM (Ref # 11)	461F1000	4
BOLT,FLANGED,8X60 (Ref # 12)	92001-1581	5
BOLT,HEX HEAD,10X50 (Ref # 13)	92001-1254	2
BOLT FLANGED 10X220 (Ref # 14)	92002-1197	1
BOLT,HEX HEAD,10X292 (Ref # 15)	92003-162	1
BOLT,HEX HEAD,8X253 (Ref # 16)	92003-171	1
NUT,LOCK,8MM (Ref # 17)	92015-1124	1
NUT,LOCK,10MM (Ref # 18)	92019-021	4
SHIM-ENG FIT FR,0.5MM (Ref # 19)	92025-053	AR
SHIM-ENG FIT FR,0.8MM (Ref # 19)	92025-054	AR
SHIM-ENG FIT FR,1.0MM (Ref # 19)	92025-055	AR
SHIM-ENG FIT FR,1.6MM (Ref # 19)	92025-056	AR
SHIM-ENG FIT FR,2.0MM (Ref # 19)	92025-057	AR
SHIM-ENG FIT FR,2.3MM (Ref # 19)	92025-058	AR
COLLAR,ENG MOUNTING (Ref # 20)	92027-160	AR
COLLAR (Ref # 20)	92027-250	AR
COLLAR,ENG MOUNT UPPE (Ref # 21)	92027-228	1
COLLAR,ENG PLAT,FRNT (Ref # 22)	92027-233	1
BOLT,SPROCKET FITTING (Ref # 23)	92003-208	2