

1978 SR PARTS DIAGRAM

TRANSMISSION

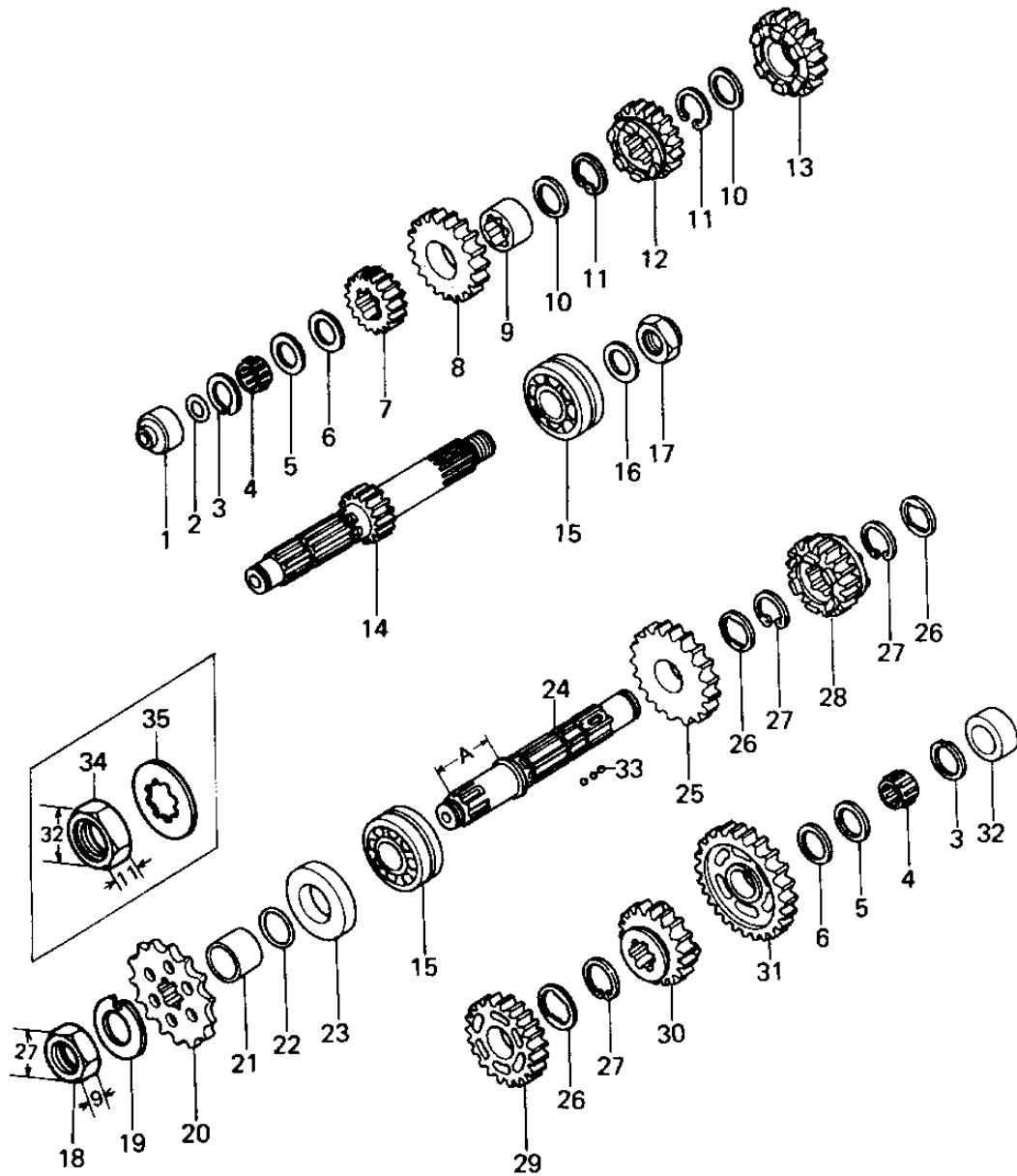

1978 SR PARTS LIST

TRANSMISSION

ITEM NAME	PART NUMBER	QUANTITY
BUSHING,DRIVE SHAFT (Ref # 1)	92028-179	1
"O" RING,7MM (Ref # 2)	670B1507	1
CIRCLIP (Ref # 3)	92033-015	2
BEARING,VS20/14A (Ref # 4)	92046-1030	2
WASHER THRUST (Ref # 5)	92022-112	AR
SHIM-KICK SHAFT (Ref # 5)	92022-144	AR
WASHER,PLAIN (Ref # 5)	92022-1026	AR
WASHER THRUST (Ref # 6)	92022-113	2
2ND GEAR,DRIVE (Ref # 7)	13130-041	1
TOP GEAR,DRIVE SHAFT (Ref # 8)	13129-1045	1
BUSHING,DRV SHFT TOP (Ref # 9)	92028-1007	1
BUSHING,DRV SHFT TOP (Ref # 9)	92028-1007	1
WASHER PLAIN (Ref # 10)	92022-161	2
CIRCLIP (Ref # 11)	92033-026	2
3RD GEAR,DRIVE SHAFT (Ref # 12)	13129-1032	1
4TH GEAR,DRIVE SHAFT (Ref # 13)	13129-1044	1
SHAFT,DRIVE (Ref # 14)	13127-051	1
BEARING,BALL (Ref # 15)	92045-035	2
WASHER (Ref # 16)	92125-002	1
NUT,20MM (Ref # 17)	92015-1555	1
NUT 20MM (Ref # 18)	92016-028	1
WASHER,LOCK,20MM (Ref # 19)	92024-044	1
ENGINE SPROCKET,16T (Ref # 20)	13144-063	1
ENGINE SPROCKET,17T (Ref # 20)	13144-1009	(1
COLLAR,ENG SPROCKET (Ref # 21)	92027-288	1
"O" RING (Ref # 22)	92055-035	1
OIL SEAL SC325210 (Ref # 23)	92050-024	1
SHAFT,OUTPUT (Ref # 24)	13128-5005	1
SHAFT,OUTPUT (Ref # 24)	13128-1012	1

1978 SR PARTS LIST

TRANSMISSION

ITEM NAME	PART NUMBER	QUANTITY
2ND GEAR,OUTPUT SHAFT (Ref # 25)	13129-1047	1
WASHER,LOCK (Ref # 26)	92024-069	3
CIRCLIP,30MM (Ref # 27)	480J3000	3
TOP GEAR,OUTPUT SHAFT (Ref # 28)	13129-1033	1
3RD GEAR,OUTPUT SHAFT (Ref # 29)	13129-1048	1
4TH GEAR,OUTPUT SHAFT (Ref # 30)	13129-1049	1
LOW GEAR,OUTPUT SHAFT (Ref # 31)	13129-1046	1
BUSHING,OUTPUT SHAFT (Ref # 32)	92028-180	1
BALL STEEL 5/32' (Ref # 33)	600A0500	3
NUT,20MM (Ref # 34)	92015-1254	1
WASHER (Ref # 35)	92200-1065	1