

1980 KZ650-F1 PARTS DIAGRAM

FRAME FITTINGS

F
—

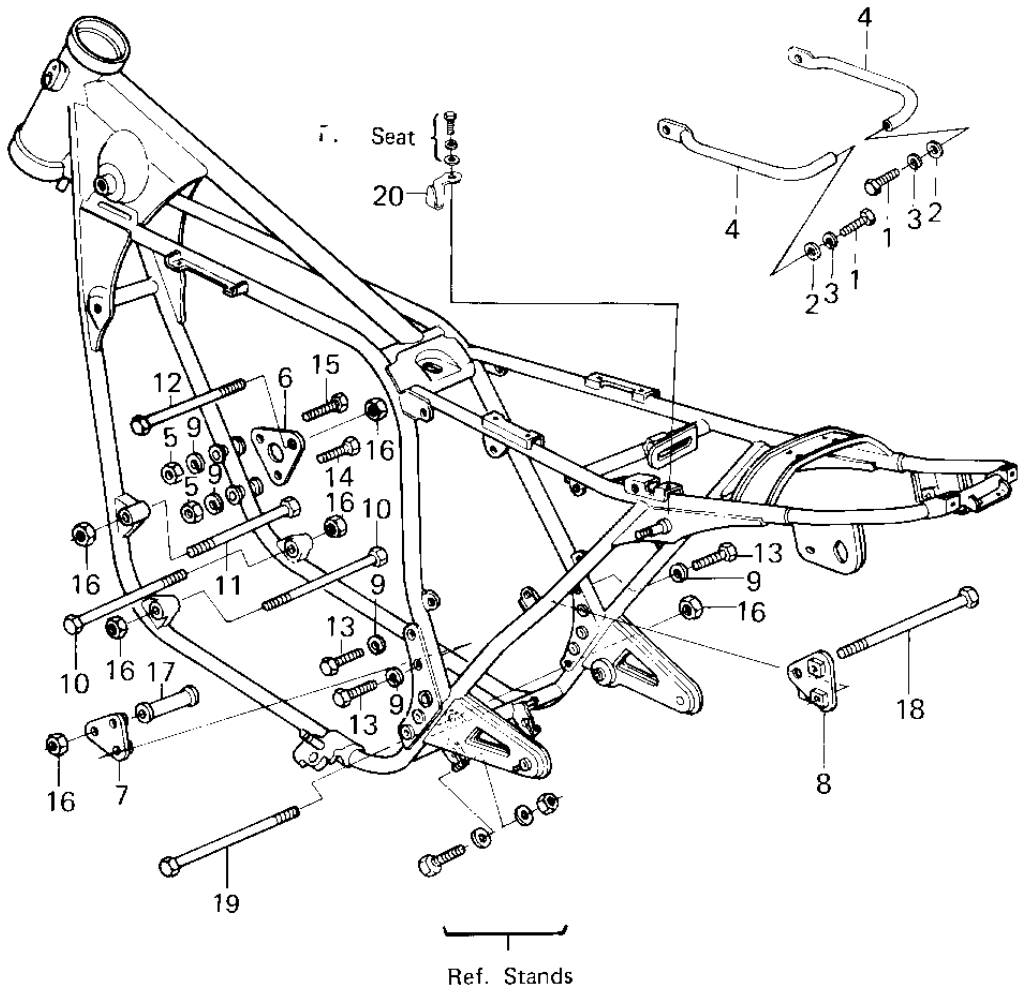

1980 KZ650-F1 PARTS LIST

FRAME FITTINGS

ITEM NAME	PART NUMBER	QUANTITY
BOLT-SMALL-UPSET,8X16 (Ref # 1)	115G0816	2
WASHER PLAIN 8MM (Ref # 2)	410B0800	2
WASHER SPRING 8MM (Ref # 3)	461F0800	2
GRIP,FRAME (Ref # 4)	32109-016	2
NUT,8MM (Ref # 5)	311B0800	2
PLATE,FRONT ENG.MOUNT (Ref # 6)	32030-063	1
PLATE,RR ENG MONT,L.H (Ref # 7)	32030-064	1
PLATE,RR ENG MONT,R.H (Ref # 8)	32030-065	1
WASHER SPRING 8MM (Ref # 9)	461F0800	6
BOLT,HEX HEAD,10X84 (Ref # 10)	92001-1048	2
BOLT,HEX HEAD,10X72 (Ref # 11)	92001-1049	1
BOLT,HEX HEAD,10X46 (Ref # 12)	92001-1050	1
BOLT,HEX HEAD,8X40 (Ref # 13)	92001-1230	4
BOLT,FLANGED,8X60 (Ref # 14)	92001-1581	1
BOLT-8X63 (Ref # 15)	92001-1397	1
NUT,LOCK,10MM (Ref # 16)	92019-021	6
COLLAR,L=54MM. (Ref # 17)	92027-275	1
BOLT,ENGINE MOUNTING (Ref # 18)	92091-023	1
BOLT,HEX HEAD,10X219 (Ref # 19)	92091-032	1
BRACKET,HELMET HOLDER (Ref # 20)	32122-057	1