

1968 W1SS PARTS DIAGRAM

FRAME/FRAME FITTINGS

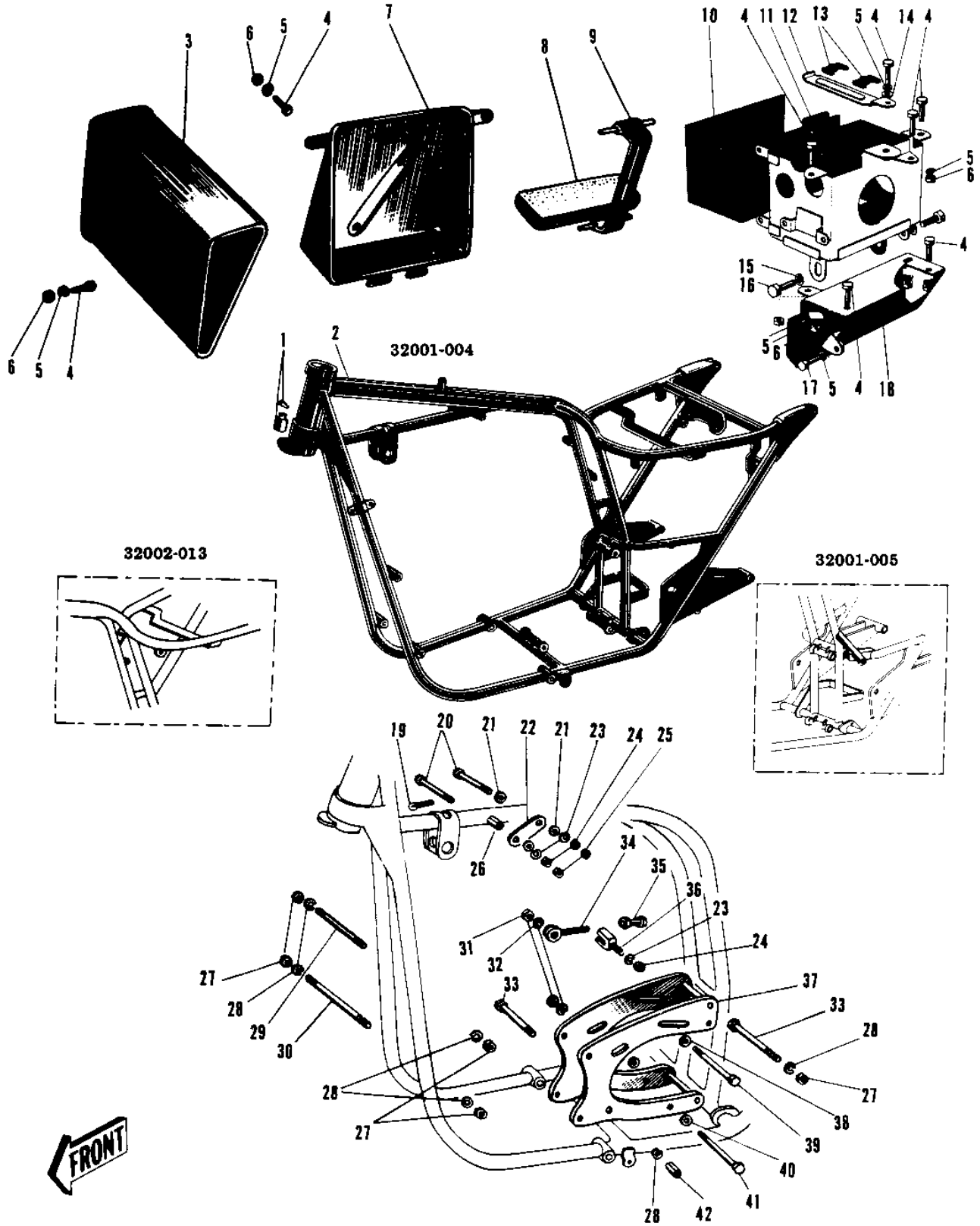

1968 W1SS PARTS LIST

FRAME/FRAME FITTINGS

ITEM NAME	PART NUMBER	QUANTITY
LOCK ASSY STEERING (Ref # 1)	27016-013	1
FRAME (Ref # 2)	32001-004	1
FRAME (Ref # 2)	32001-005	1
BOX TOOL (Ref # 3)	32098-003	(1
BOX TOOL (Ref # 3)	32098-005	1
BOLT-UPSET,6X12 (Ref # 4)	112G0612	4
WASHER SPRING 6MM (Ref # 5)	461F0600	4
NUT 6MM (Ref # 6)	311B0600	3
CASE BATTERY (Ref # 7)	32097-006	1
MAT BATTERY (Ref # 8)	32103-006	1
BAND BATTERY CLAMP (Ref # 9)	92072-017	1
PIN COTTER 2.0X20 (Ref # 19)	550D2020	2
BOLT ENG UPPER MOUNT (Ref # 20)	92091-015	(2
BOLT HEX HEAD 8X63 (Ref # 20)	114G0863	2
WASHER PLAIN 8MM (Ref # 21)	410B0800	6
BRACE CYLINDER HEAD (Ref # 22)	32030-010	2
WASHER SPRING 8MM (Ref # 23)	461F0800	3
NUT,8MM (Ref # 24)	311B0800	3
NUT 8MM (Ref # 25)	318B0800	2
PIECE-CYL HEAD BRACE (Ref # 26)	32030-009	1
NUT,10MM (Ref # 27)	314B1000	8
WASHER SPRING 10MM (Ref # 28)	461F1000	9
BOLT ENGINE MOUNT A (Ref # 29)	92091-006	1
BOLT ENGINE MOUNT B (Ref # 30)	92091-007	1
NUT MISSION CASE LOW (Ref # 31)	92016-020	2
WASHER SPRING 12MM (Ref # 32)	461F1200	2
BOLT HEX HEAD 10X95 (Ref # 33)	113B1095	5
SCREW PRMRY CHAIN ADJ (Ref # 34)	32107-001	1
NUT PRIMARY CHAIN ADJ (Ref # 35)	92016-017	1

1968 W1SS PARTS LIST

FRAME/FRAME FITTINGS

ITEM NAME	PART NUMBER	QUANTITY
HOLDER PRI CHAIN ADJ (Ref # 36)	32108-001	1
PLATE MISSION CSE HLD (Ref # 37)	32031-001	2
WSHR MISSION CASE UPP (Ref # 38)	92022-094	1
BOLT MISSION CASE UPP (Ref # 39)	92003-021	1
WASHER PLAIN 12MM (Ref # 40)	411B1200	(2
WASHER PLAIN 12MM (Ref # 40)	411B1200	1
BOLT MISSION CASE LOW (Ref # 41)	92003-020	1
NUT CHAIN CASE MOUNT (Ref # 42)	92016-018	1