

1968 W1SS PARTS DIAGRAM

SWING ARM/SHOCK ABSORBERS

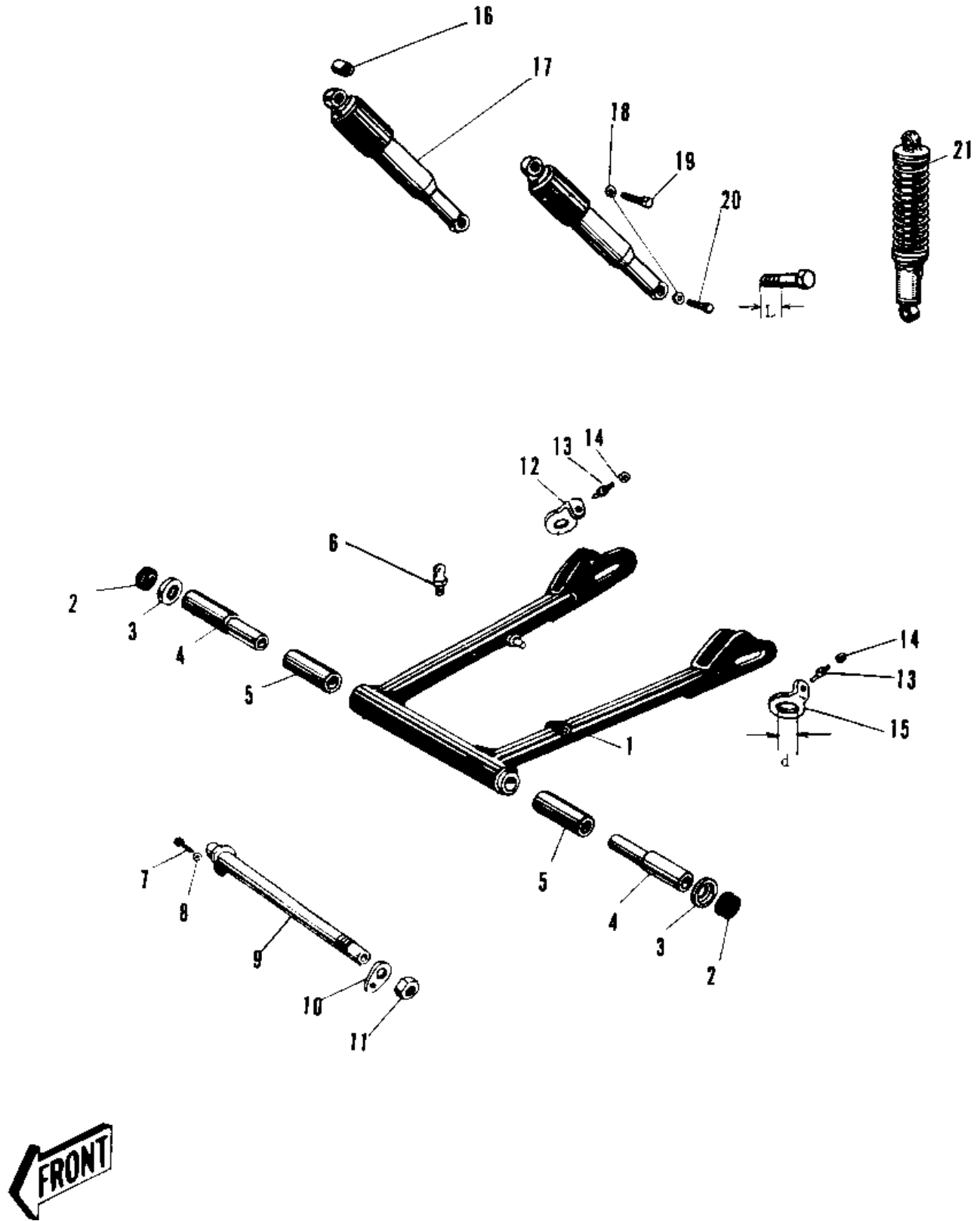

1968 W1SS PARTS LIST

SWING ARM/SHOCK ABSORBERS

| ITEM NAME | PART NUMBER | QUANTITY |
|--------------------------------------|-------------|----------|
| ARM SWING (Ref # 1) | 33001-005 | 1 |
| DUST SHIELD PIVOT SHT (Ref # 2) | 92093-005 | 2 |
| HOLDER PV SHT DST SHD (Ref # 3) | 33035-002 | 2 |
| SLEEVE PIVOT SHAFT (Ref # 4) | 33034-005 | 2 |
| BUSH SWING ARM PIVOT (Ref # 5) | 33033-003 | 2 |
| GREASE NIPPLE (Ref # 6) | 92005-002 | 1 |
| BOLT-UPSET,6X12 (Ref # 7) | 112G0612 | 1 |
| WASHER SPRING 6MM (Ref # 8) | 461F0600 | 1 |
| SHAFT SWING ARM PIVOT (Ref # 9) | 33032-019 | 1 |
| WASHER SWING ARM SHT (Ref # 10) | 33037-002 | 1 |
| NUT SWING ARM PV SHT (Ref # 11) | 92016-022 | 1 |
| ADJUSTER CHAIN R.H (Ref # 12) | 33040-026 | 1 |
| BOLT CHAIN ADJUSTER (Ref # 13) | 92001-045 | 2 |
| NUT 8MM (Ref # 14) | 314B0800 | 2 |
| ADJUSTER CHAIN L.H (Ref # 15) | 33040-025 | 1 |
| BUSH SHCK ABS RUBBER (Ref # 16) | 45017-001 | 4 |
| UNAVAILABLE IN PRICE BOOK (Ref # 17) | 45014-029 | 2 |
| SHOCK ABSBR RR (Ref # 17) | 45014-041 | 2 |
| WASHER SPRING 10MM (Ref # 18) | 461F1000 | 4 |
| BOLT RR SHOCK ABSRBR (Ref # 19) | 92007-017 | 2 |
| BOLT HEX HEAD 10X38 (Ref # 20) | 113N1038 | 2 |