

1969 W1SS PARTS DIAGRAM

OIL TANK

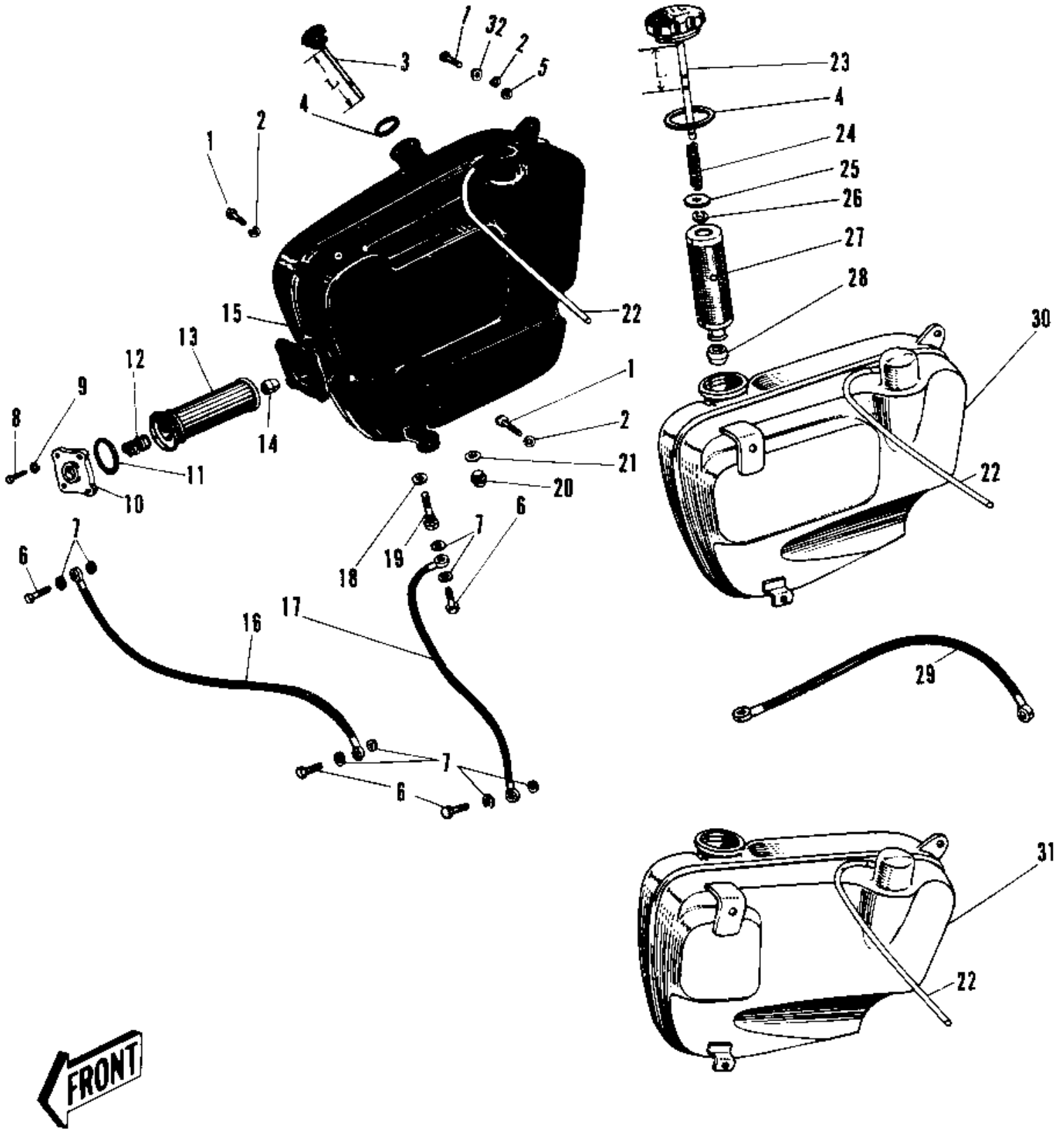

1969 W1SS PARTS LIST

OIL TANK

| ITEM NAME | PART NUMBER | QUANTITY |
|--------------------------------------|--------------|----------|
| BOLT-SMALL-UPSET,8X16 (Ref # 1) | 115G0816 | 3 |
| WASHER SPRING 8MM (Ref # 2) | 461F0800 | 3 |
| CAP OIL TANK (Ref # 3) | 52003-013 | 1 |
| "0" RING,36MM (Ref # 4) | 670B3036 | 1 |
| NUT,8MM (Ref # 5) | 311B0800 | 1 |
| BOLT BANJO (Ref # 6) | 92060-003 | 4 |
| BOLT BANJO (Ref # 6) | 92060-007 | 4 |
| GASKET OIL PIPE BANJO (Ref # 7) | 92065-037 | 8 |
| BOLT-UPSET (Ref # 8) | 112G0618 | 4 |
| WASHER SPRING 6MM (Ref # 9) | 461F0600 | 4 |
| UNAVAILABLE IN PRICE BOOK (Ref # 10) | 52012-001 | 1 |
| "0" RING,65MM (Ref # 11) | 671B2565 | 1 |
| SPRING-OIL FILT ELMNT (Ref # 12) | 16100-001 | 1 |
| ELEMENT OIL FILTER (Ref # 13) | 52010-002 | 1 |
| BUSH OIL FILTER (Ref # 14) | 52011-002 | 1 |
| TANK,OIL,BLACK (Ref # 15) | 52001-009-10 | 1 |
| TANK OIL C.RED (Ref # 15) | 52001-009-24 | 1 |
| UNAVAILABLE IN PRICE BOOK (Ref # 15) | 52001-009-27 | 1 |
| PIPE RETURN (Ref # 16) | 52008-001 | 1 |
| PIPE OUTLET (Ref # 17) | 52007-001 | 1 |
| GASKET OIL FILTER (Ref # 18) | 92065-038 | 1 |
| FILTER OUTLET PIPE (Ref # 19) | 52009-001 | 1 |
| BOLT OIL TANK DRAIN (Ref # 20) | 92003-023 | 1 |
| GASKET DRAIN PLUG (Ref # 21) | 92065-039 | 1 |
| TUBE-VINYL 5X470 (Ref # 22) | 700Q05470 | 1 |
| CAP OIL TANK (Ref # 23) | 52003-005 | (1 |
| UNAVAILABLE IN PRICE BOOK (Ref # 23) | 52003-010 | (1 |
| CAP OIL TANK (Ref # 23) | 56019-008 | 1 |
| SPRING OIL FILTER (Ref # 24) | 52013-001 | 1 |

1969 W1SS PARTS LIST

OIL TANK

| ITEM NAME | PART NUMBER | QUANTITY |
|--------------------------------------|--------------|----------|
| CAP OIL FILTER (Ref # 25) | 52012-002 | 1 |
| CIRCLIP 3MM (Ref # 26) | 482K3000 | 1 |
| ELEMENT OIL FILTER (Ref # 27) | 52010-003 | 1 |
| ELEMENT-OIL FILTER (Ref # 27) | 52010-004 | 1 |
| BUSH OIL FILTER (Ref # 28) | 52011-002 | 1 |
| PIPE OIL TANK RETURN (Ref # 29) | 52008-002 | 1 |
| UNAVAILABLE IN PRICE BOOK (Ref # 30) | 52001-011-10 | 1 |
| TANK OIL C.RED (Ref # 30) | 52001-011-24 | 1 |
| TANK OIL C.BLUE (Ref # 30) | 52001-011-27 | 1 |
| TANK OIL C.RED (Ref # 31) | 52001-017-24 | 1 |
| TANK OIL C.BLUE (Ref # 31) | 52001-017-27 | 1 |
| WASHER PLAIN 8MM (Ref # 32) | 410B0800 | 1 |