

# 1968 Commander PARTS DIAGRAM

## OIL TANK

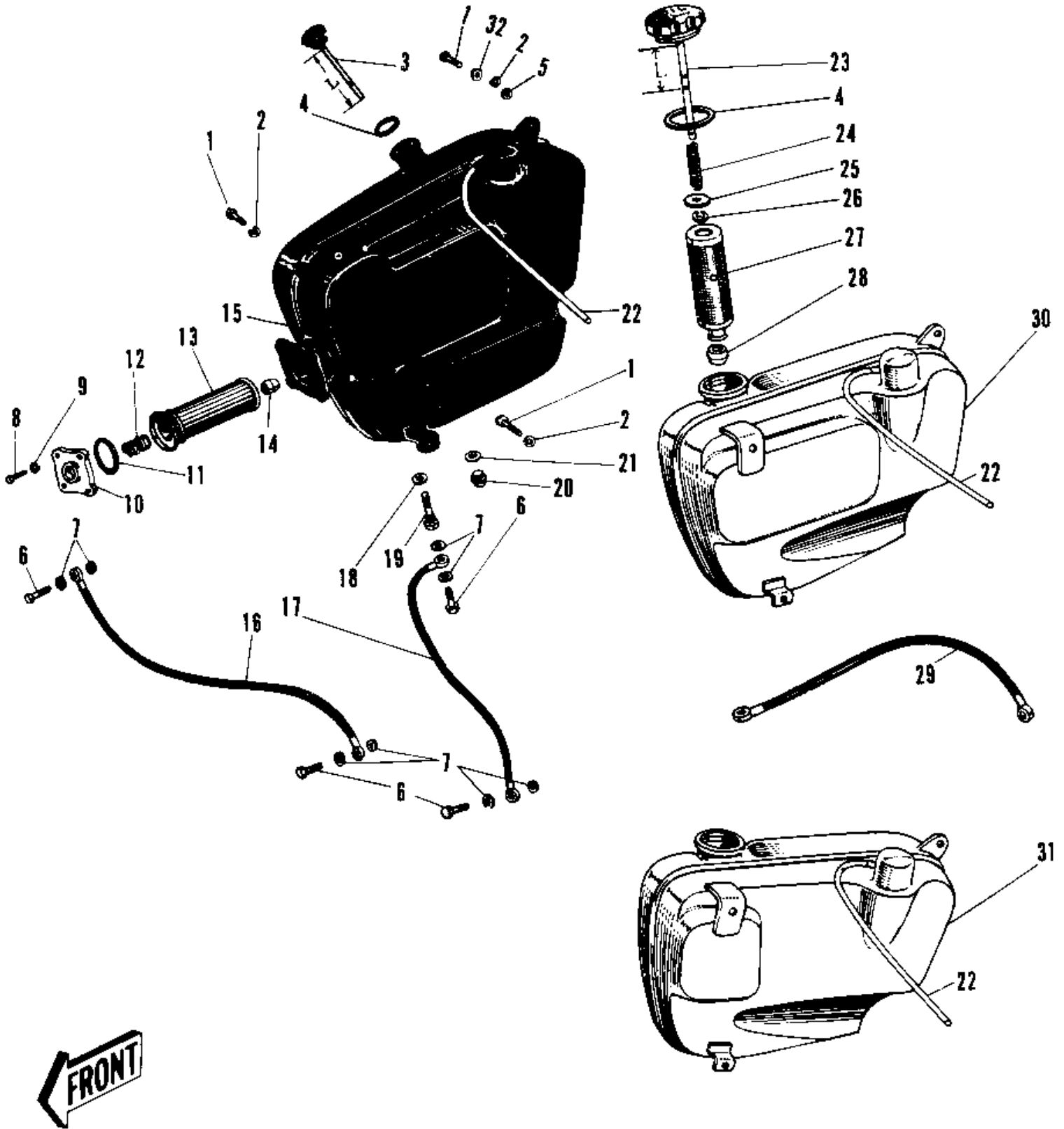

# 1968 Commander PARTS LIST

## OIL TANK

ITEM NAME	PART NUMBER	QUANTITY
BOLT-SMALL-UPSET,8X16 (Ref # 1)	115G0816	3
WASHER SPRING 8MM (Ref # 2)	461F0800	3
CAP OIL TANK (Ref # 3)	52003-013	1
"0" RING,36MM (Ref # 4)	670B3036	1
NUT,8MM (Ref # 5)	311B0800	1
BOLT BANJO (Ref # 6)	92060-003	4
BOLT BANJO (Ref # 6)	92060-007	4
GASKET OIL PIPE BANJO (Ref # 7)	92065-037	8
BOLT-UPSET (Ref # 8)	112G0618	4
WASHER SPRING 6MM (Ref # 9)	461F0600	4
UNAVAILABLE IN PRICE BOOK (Ref # 10)	52012-001	1
"0" RING,65MM (Ref # 11)	671B2565	1
SPRING-OIL FILT ELMNT (Ref # 12)	16100-001	1
ELEMENT OIL FILTER (Ref # 13)	52010-002	1
BUSH OIL FILTER (Ref # 14)	52011-002	1
TANK,OIL,BLACK (Ref # 15)	52001-009-10	1
TANK OIL C.RED (Ref # 15)	52001-009-24	1
UNAVAILABLE IN PRICE BOOK (Ref # 15)	52001-009-27	1
PIPE RETURN (Ref # 16)	52008-001	1
PIPE OUTLET (Ref # 17)	52007-001	1
GASKET OIL FILTER (Ref # 18)	92065-038	1
FILTER OUTLET PIPE (Ref # 19)	52009-001	1
BOLT OIL TANK DRAIN (Ref # 20)	92003-023	1
GASKET DRAIN PLUG (Ref # 21)	92065-039	1
TUBE-VINYL 5X470 (Ref # 22)	700Q05470	1
CAP OIL TANK (Ref # 23)	52003-005	(1
UNAVAILABLE IN PRICE BOOK (Ref # 23)	52003-010	(1
CAP OIL TANK (Ref # 23)	56019-008	1
SPRING OIL FILTER (Ref # 24)	52013-001	1

# 1968 Commander PARTS LIST

## OIL TANK

ITEM NAME	PART NUMBER	QUANTITY
CAP OIL FILTER (Ref # 25)	52012-002	1
CIRCLIP 3MM (Ref # 26)	482K3000	1
ELEMENT OIL FILTER (Ref # 27)	52010-003	1
ELEMENT-OIL FILTER (Ref # 27)	52010-004	1
BUSH OIL FILTER (Ref # 28)	52011-002	1
PIPE OIL TANK RETURN (Ref # 29)	52008-002	1
UNAVAILABLE IN PRICE BOOK (Ref # 30)	52001-011-10	1
TANK OIL C.RED (Ref # 30)	52001-011-24	1
TANK OIL C.BLUE (Ref # 30)	52001-011-27	1
TANK OIL C.RED (Ref # 31)	52001-017-24	1
TANK OIL C.BLUE (Ref # 31)	52001-017-27	1
WASHER PLAIN 8MM (Ref # 32)	410B0800	1