

1968 W1SS PARTS DIAGRAM

SEAT/SIDE COVER/CHAIN COVER/CHAIN

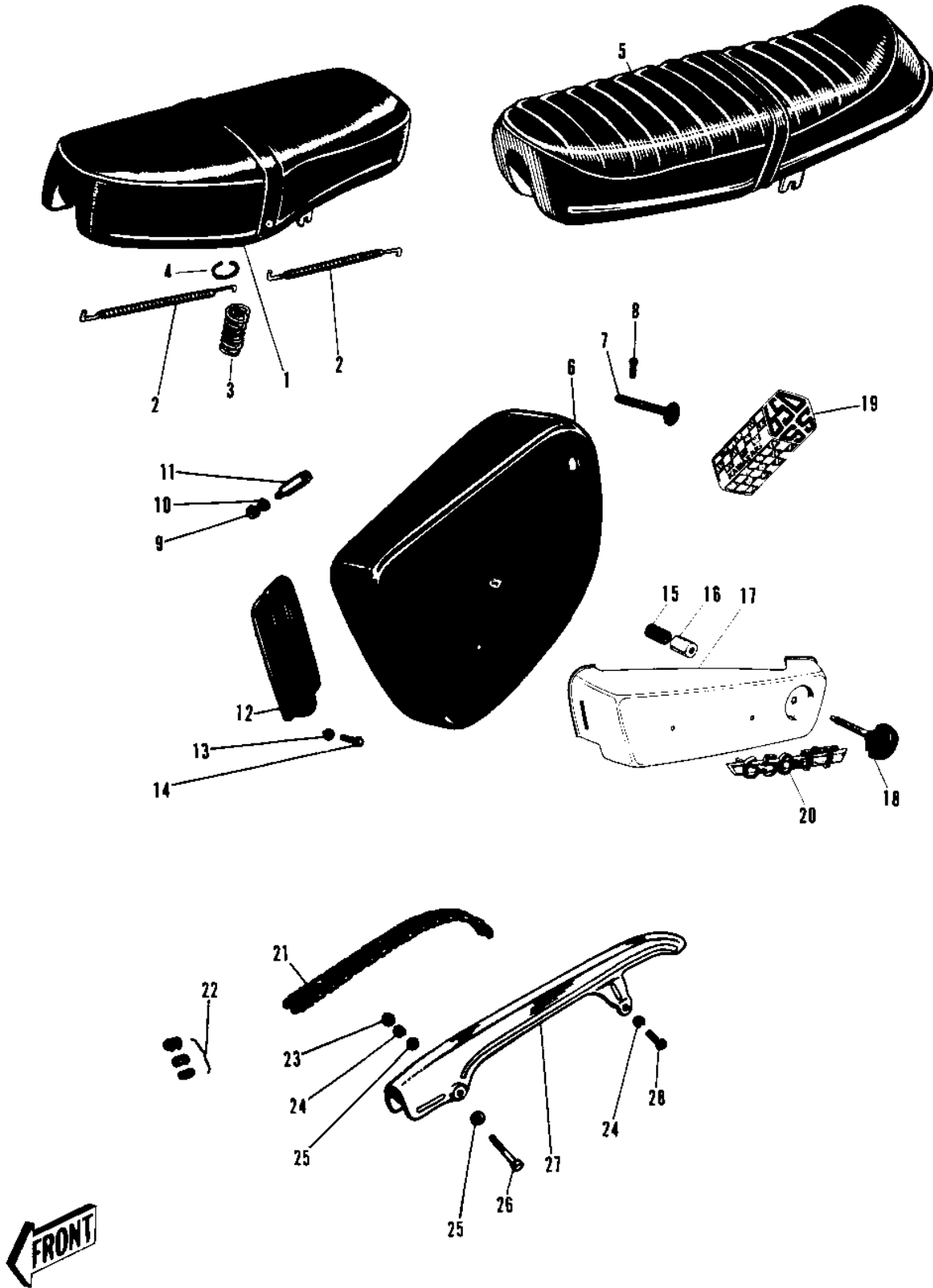

1968 W1SS PARTS LIST

SEAT/SIDE COVER/CHAIN COVER/CHAIN

ITEM NAME	PART NUMBER	QUANTITY
SEAT DUAL (Ref # 1~4)	53001-059	(1
SEAT-DUAL (Ref # 1~4)	53001-037	1
SPRING SEAT (Ref # 2)	53026-002	18
SPRING SEAT COIL (Ref # 3)	53026-001	2
HOOK SPRING (Ref # 4)	53027-002	18
COVER L.H SIDE BLACK (Ref # 6)	36001-020-10	1
COVER L.H SIDE C.RED (Ref # 6)	36001-020-24	1
COVER L.H SIDE C.BLUE (Ref # 6)	36001-020-27	1
KNOB SIDE COVER (Ref # 7)	92077-014	1
PIN COTTER 1.6X15 (Ref # 8)	550D1615	1
NUT,8MM (Ref # 9)	311B0800	1
WASHER SPRING 8MM (Ref # 10)	461F0800	1
NUT SIDE COVER FIT (Ref # 11)	92015-028	1
HANGER SIDE COVER (Ref # 12)	36005-001	1
WASHER SPRING 6MM (Ref # 13)	461F0600	2
BOLT-UPSET,6X12 (Ref # 14)	112G0612	2
DRIVE CHAIN ASSY (Ref # 21,22)	695Z5096	1
CHAIN JOINT 530 (Ref # 22)	92058-008	1
NUT 6MM (Ref # 23)	311B0600	1
WASHER SPRING 6MM (Ref # 24)	461F0600	2
WASHER PLAIN 6MM (Ref # 25)	411B0600	2
SCREW PAN HEAD 6X50 (Ref # 26)	220B0650	1
CASE-CHAIN (Ref # 27)	36014-020	1
SCREW PAN HEAD 6X12 (Ref # 28)	220B0612	1