

1972 Mach IV PARTS DIAGRAM

CYLINDER HEADS/CYLINDERS

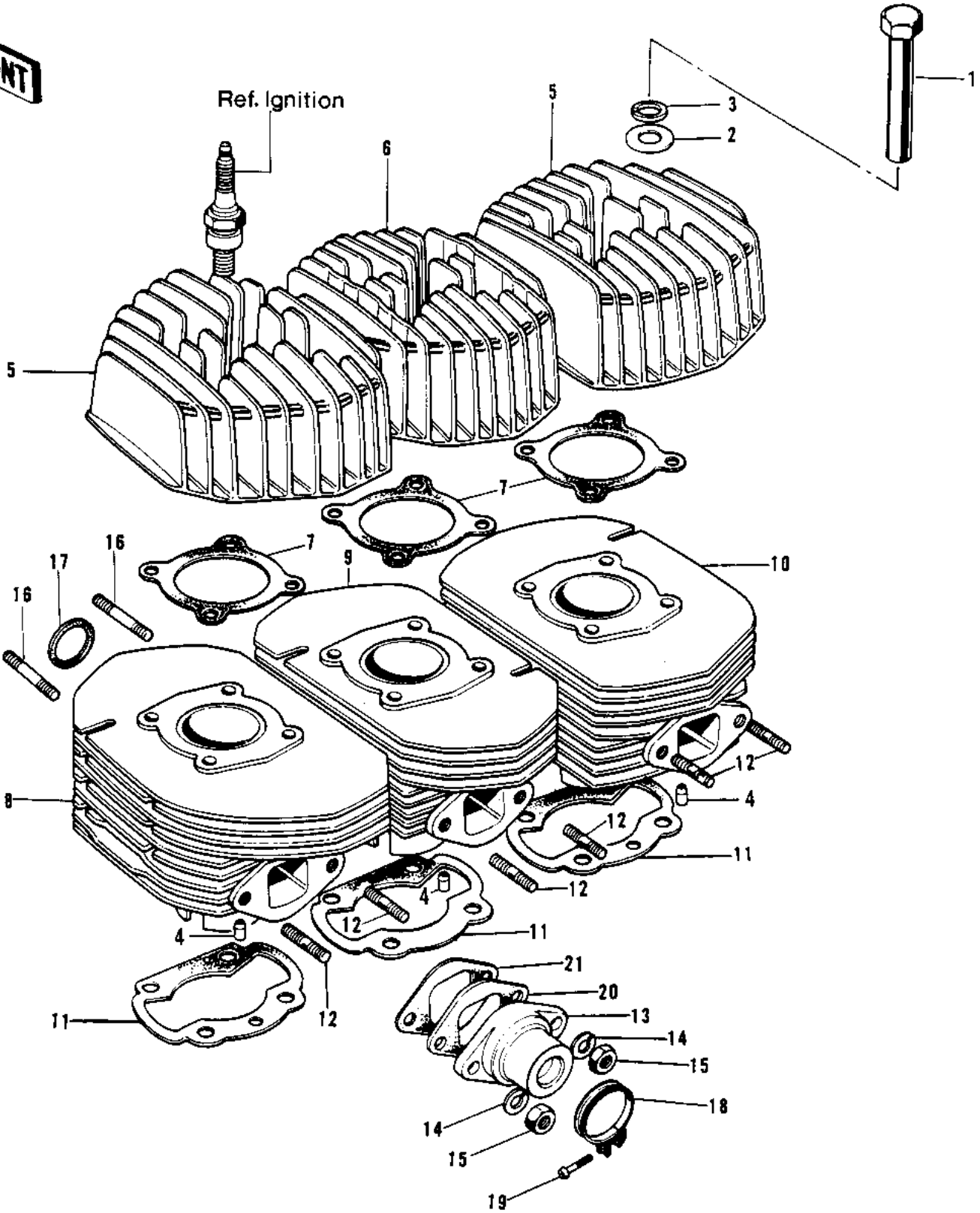

1972 Mach IV PARTS LIST

CYLINDER HEADS/CYLINDERS

| ITEM NAME | PART NUMBER | QUANTITY |
|---------------------------------|--------------|----------|
| NUT-CYLINDER HEAD (Ref # 1) | 92015-049 | 12 |
| WASHER PLAIN 14MM (Ref # 2) | 410B1400 | 12 |
| WASHER SPRING 14MM (Ref # 3) | 461F1400 | 12 |
| NOZZLE,OIL METERING (Ref # 4) | 92062-008 | 3 |
| CYLINDER HEAD,L.H&R.H (Ref # 5) | 11001-066 | 2 |
| CYLINDER HEAD,R.H&L.H (Ref # 5) | 11001-096-2H | 2 |
| CYLINDER HEAD,CENTER (Ref # 6) | 11001-067 | 1 |
| CYLINDER HEAD,CENTER (Ref # 6) | 11001-097-2H | 1 |
| GASKET-CYLINDER HEAD (Ref # 7) | 11004-049 | 3 |
| CYLINDER,L.H BARREL (Ref # 8) | 11005-128-2H | 1 |
| CYLINDER,CENTER (Ref # 9) | 11005-110 | 1 |
| CYLINDER,CENTER BAREL (Ref # 9) | 11005-129-2H | 1 |
| CYLINDER,R.H (Ref # 10) | 11005-111 | 1 |
| CYLINDER,R.H BARREL (Ref # 10) | 11005-130-2H | 1 |
| GASKET-CYLINDER BASE (Ref # 11) | 11009-028 | 3 |
| STUD,8X16 (Ref # 12) | 172G0816 | 6 |
| INLET-AIR (Ref # 13) | 16060-013 | 3 |
| WASHER SPRING 8MM (Ref # 14) | 461F0800 | 6 |
| NUT,8MM (Ref # 15) | 311B0800 | 6 |
| STUD,8X25 (Ref # 16) | 92004-1008 | 6 |
| GASKET EXHAUST PIPE (Ref # 17) | 18067-008 | 3 |
| CLAMP-INLET PIPE (Ref # 18) | 92037-061 | 3 |
| SCREW-PAN-CROS (Ref # 19) | 220B0535 | 3 |
| INSULATOR-HEAT (Ref # 20) | 16061-014 | 3 |
| GASKET-AIR INLET (Ref # 21) | 16062-016 | 3 |