

1973 Z1 PARTS DIAGRAM

REAR HUB/BRAKE/CHAIN

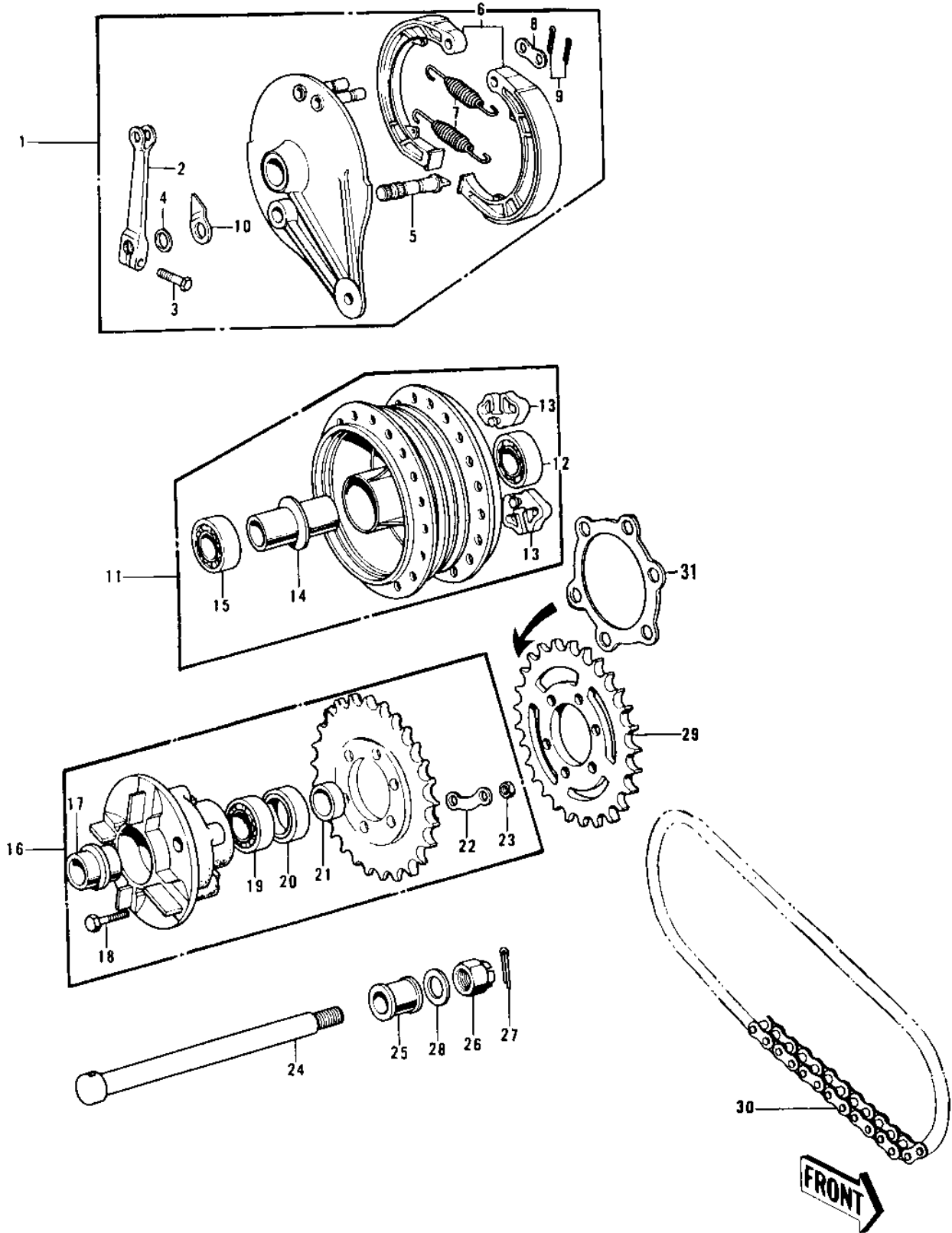

1973 Z1 PARTS LIST

REAR HUB/BRAKE/CHAIN

| ITEM NAME | PART NUMBER | QUANTITY |
|---|--------------|----------|
| PANEL ASSY, REAR BRAKE, FLAT BLACK (Ref # 1) | 42006-030-21 | 1 |
| PANEL ASSY, REAR BRAKE, BUFF FINISH (Ref # 1) | 42006-030-80 | 1 |
| PANEL ASSY, REAR BRAKE (Ref # 1) | 42006-053 | 1 |
| LEVER, REAR BRAKE CAM (Ref # 2) | 42029-021 | 1 |
| LEVER, REAR BRAKE CAM (Ref # 2) | 42029-033 | 1 |
| BOLT, HEX HEAD, 8 X 25 (Ref # 3) | 110B0825 | 1 |
| DUST SHIELD, BRAKE CAM (Ref # 4) | 41051-003 | 1 |
| CAMSHAFT, REAR BRAKE (Ref # 5) | 41050-011 | 1 |
| CAMSHAFT, REAR BRAKE (Ref # 5) | 41050-017 | 1 |
| SHOE, BRAKE (Ref # 6) | 41048-016 | 2 |
| SPRING, BRAKE SHOE (Ref # 7) | 41049-007 | 2 |
| WASHER , BRAKE SHOE (Ref # 8) | 41045-006 | 1 |
| PIN, COTTER, 3.0 X 25 (Ref # 9) | 550D-3025 | 2 |
| INDICATOR, REAR BRAKE (Ref # 10) | 41085-004 | 1 |
| DRUM ASSY, REAR BRAKE (Ref # 11) | 42005-030 | 1 |
| BEARING BALL #6304 (Ref # 12) | 601B6304 | 1 |
| SHOCK DAMPER, REAR HUB (Ref # 13) | 42014-021 | 6 |
| SPACER, REAR HUB BEARING (Ref # 14) | 42010-021 | 1 |
| BEARING BALL, #6304Z (Ref # 15) | 601B6304Z | 1 |
| COUPLING ASSY, REAR HUB (Ref # 16) | 42008-013 | 1 |
| SLEEVE, REAR HUB COUPLING (Ref # 17) | 42036-015 | 1 |
| BOLT, REAR SPROCKET FITTING (Ref # 18) | 92003-100 | 6 |
| BOLT, REAR SPROCKET FITTING (Ref # 18) | 92003-015 | 6 |
| BEARING BALL, #6206 (Ref # 19) | 601B6206 | 1 |
| OIL SEAL (Ref # 20) | 92050-027 | 1 |
| COLLAR, REAR AXLE SLEEVE (Ref # 21) | 42037-020 | 1 |
| COLLAR, REAR AXLE SLEEVE (Ref # 21) | 42037-023 | 1 |
| WASHER, LOCK, 10MM (Ref # 22) | 92088-013 | 3 |
| NUT , 10 MM (Ref # 23) | 42045-005 | 6 |

1973 Z1 PARTS LIST

REAR HUB/BRAKE/CHAIN

| ITEM NAME | PART NUMBER | QUANTITY |
|--|-------------|----------|
| AXLE, REAR (Ref # 24) | 42031-034 | 1 |
| COLLAR, REAR AXLE (Ref # 25) | 42032-037 | 1 |
| NUT, CASTLE, 18 MM (Ref # 26) | 42045-018 | 1 |
| PIN, COTTER, 4.0 X 35 (Ref # 27) | 550D4035 | 1 |
| WASHER, PLAIN, 20 MM WHN EXH USE 92 (Ref # 28) | 92022-233 | 1 |
| WASHER , PLAIN, 20 MM T=4.5 (Ref # 28) | 92022-248 | AR |
| WASHER , PLAIN, 20 MM T=6.0 (Ref # 28) | 92022-249 | AR |
| REAR SPROCKET, 35T (Ref # 29) | 42041-118 | 1 |
| CHAIN ASSY, DRIVE, 630 X 92L (Ref # 30) | 92057-018 | 1 |
| CHAIN ASSY, DRIVE, 630 X 92L (Ref # 30) | 92057-107 | 1 |
| SPACER, REAR HUB COUPLING (Ref # 31) | 92028-108 | 1 |