

1978 Police 1000 PARTS DIAGRAM

FRAME/FRAME FITTINGS (78 C1/C1A)

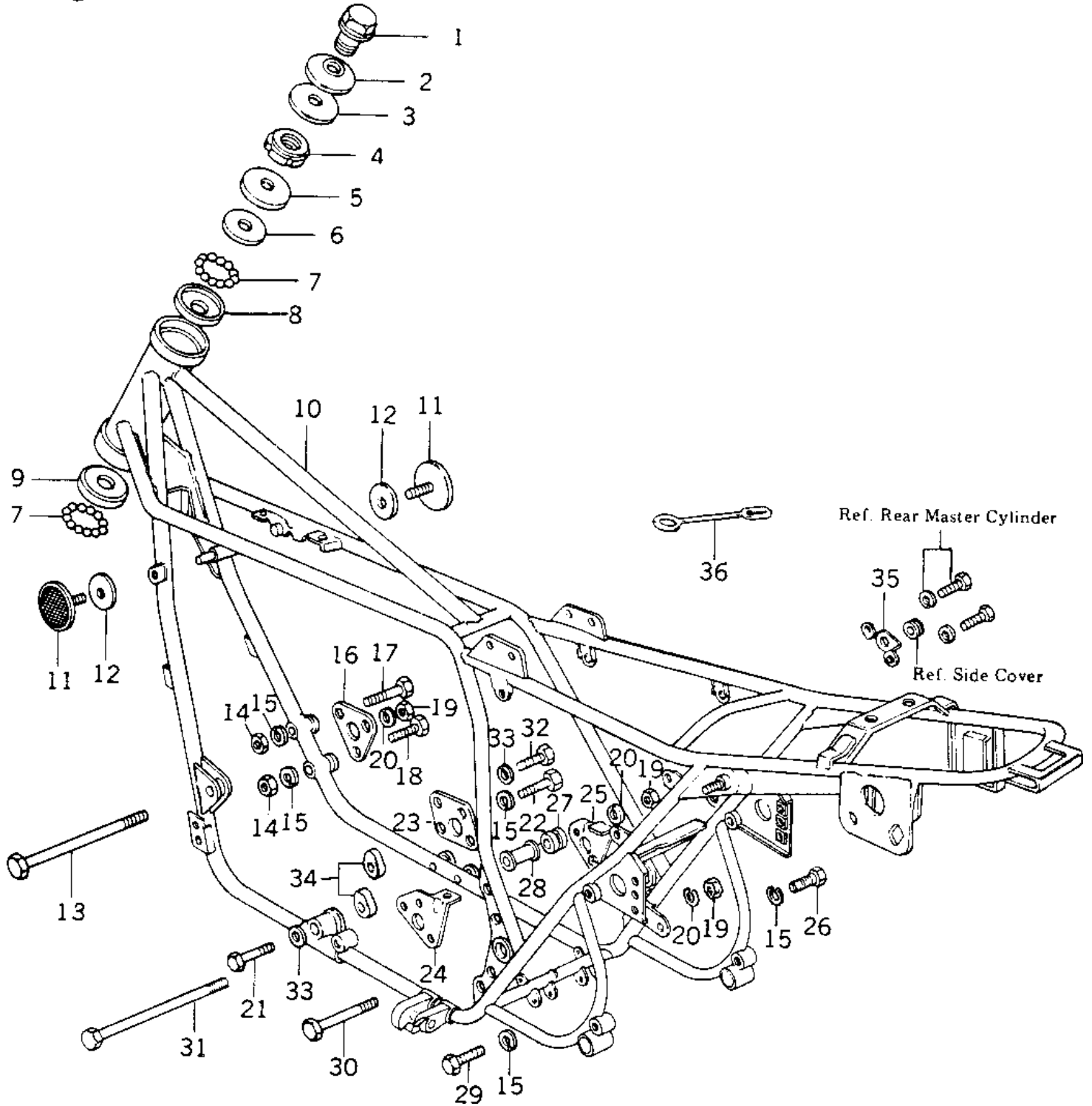

1978 Police 1000 PARTS LIST

FRAME/FRAME FITTINGS ('78 C1/C1A)

ITEM NAME	PART NUMBER	QUANTITY
BOLT,STEERG STEM HEA (Ref # 1)	92007-031	1
WASHER,STEERG STM HD (Ref # 2)	92022-230	1
WASHER,WAVE (Ref # 3)	46100-003	1
NUT STEERING STEM LC (Ref # 4)	92090-007	1
CAP, STEERING STEM (Ref # 5)	46098-016	1
CONE,STRNG STM BRNG (Ref # 6)	92047-011	1
BALL STEEL 1/4' (Ref # 7)	600A0800	39
RACE STRNG STEM BERN (Ref # 8)	92048-006	1
RACE,STRNG STM BRNG (Ref # 9)	92048-008	1
FRAME (Ref # 10)	32002-1010	1
REFLECTOR,REFLEX (Ref # 11)	28012-016	2
DAMPER RUBBER,REFLEC (Ref # 12)	92094-011	2
BOLT,ENGINE MOUNTING (Ref # 13)	92091-022	1
NUT,8MM (Ref # 14)	311B0800	2
WASHER SPRING 8MM (Ref # 15)	461F0800	8
PLATE,ENG MOUNT FRON (Ref # 16)	32030-025	1
BOLT-8X63 (Ref # 17)	92001-1397	1
BOLT,HEX HEAD,8X59 (Ref # 18)	110G0859	1
NUT,LOCK,10MM (Ref # 19)	92019-021	3
WASHER SPRING 10MM (Ref # 20)	461F1000	3
BOLT,HEX HEAD,12X55 (Ref # 21)	92001-1262	1
BOLT-SMALL-UPSET,8X1 (Ref # 22)	115G0818	2
PLATE,FT ENG MNT LWR (Ref # 23)	32029-1014	1
PLATE,REAR ENGINE,L. (Ref # 24)	32030-066	1
PLATE,REAR ENGINE,R. (Ref # 25)	32030-067	1
BOLT (Ref # 26)	92001-1578	3
COLLAR,ENG MOUNTING (Ref # 27)	92027-160	1
COLLAR,ENG MOUNTING (Ref # 28)	92027-159	1
BOLT,FLANGED,8X35 (Ref # 29)	92001-1577	1

1978 Police 1000 PARTS LIST

FRAME/FRAME FITTINGS ('78 C1/C1A)

ITEM NAME	PART NUMBER	QUANTITY
BOLT,ENGINE MOUNTING (Ref # 30)	92003-099	1
BOLT,ENGINE MOUNTING (Ref # 31)	92091-023	1
BOLT,HEX HEAD,12X70 (Ref # 32)	92001-1265	1
WASHER SPRING 12MM (Ref # 33)	461F1200	2
NUT,12MM (Ref # 34)	92016-045	2
BRACKET,SIDE COV,R.H (Ref # 35)	32049-101	1
CLAMP,OVER FLOW PIPE (Ref # 36)	92037-134	1