

# 1978 Police 1000 PARTS DIAGRAM

REAR MASTER CYLINDER ('78 C1/C1A)

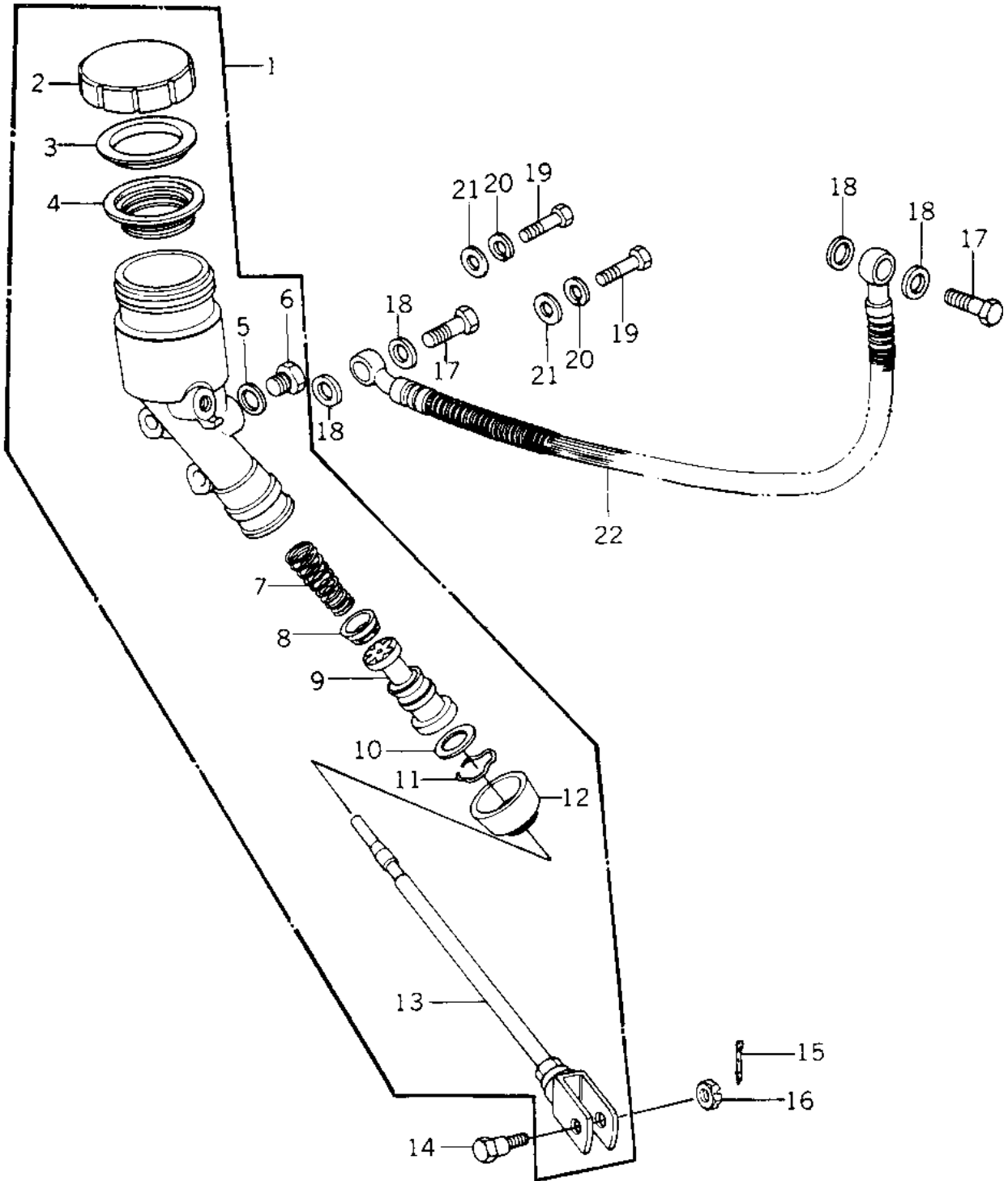

# 1978 Police 1000 PARTS LIST

## REAR MASTER CYLINDER ('78 C1/C1A)

| ITEM NAME                       | PART NUMBER | QUANTITY |
|---------------------------------|-------------|----------|
| CYLINDER ASSY,REAR (Ref # 1)    | 43015-033   | 1        |
| CAP,OIL CUP (Ref # 2)           | 43026-004   | 1        |
| PLATE-MASTER CYLINDE (Ref # 3)  | 43027-001   | 1        |
| DIAPHRAGM (Ref # 4)             | 43028-003   | 1        |
| 'O'RING (Ref # 5)               | 43079-002   | 1        |
| BOLT (Ref # 6)                  | 43070-003   | 1        |
| SPRING ASSY, RETURN (Ref # 7)   | 43018-002   | 1        |
| CUP, PRIMARY (Ref # 8)          | 43019-002   | 1        |
| PISTON ASSY (Ref # 9)           | 43072-004   | 1        |
| STOPPER,PISTON (Ref # 10)       | 43022-002   | 1        |
| RING,DUST SEAL (Ref # 11)       | 43058-004   | 1        |
| DUST COVER (Ref # 12)           | 43024-003   | 1        |
| ROD,BRAKE (Ref # 13)            | 43010-021   | 1        |
| BOLT (Ref # 14)                 | 92003-198   | 1        |
| PIN COTTER 2.0X20 (Ref # 15)    | 550D2020    | 1        |
| NUT CASTLE (Ref # 16)           | 321B0800    | 1        |
| BOLT,OIL,L=23 (Ref # 17)        | 92002-1888  | 2        |
| WASHER-OIL BOLT (Ref # 18)      | 43067-001   | 4        |
| BOLT,10X45 (Ref # 19)           | 92001-1182  | 2        |
| WASHER SPRING 8MM (Ref # 20)    | 461F0800    | 2        |
| WASHER PLAIN 8MM (Ref # 21)     | 410B0800    | 2        |
| HOSE,REAR MASTER CYL (Ref # 22) | 43059-031   | 1        |