

1981 LTD PARTS DIAGRAM

MUFFLERS

E1140-0069

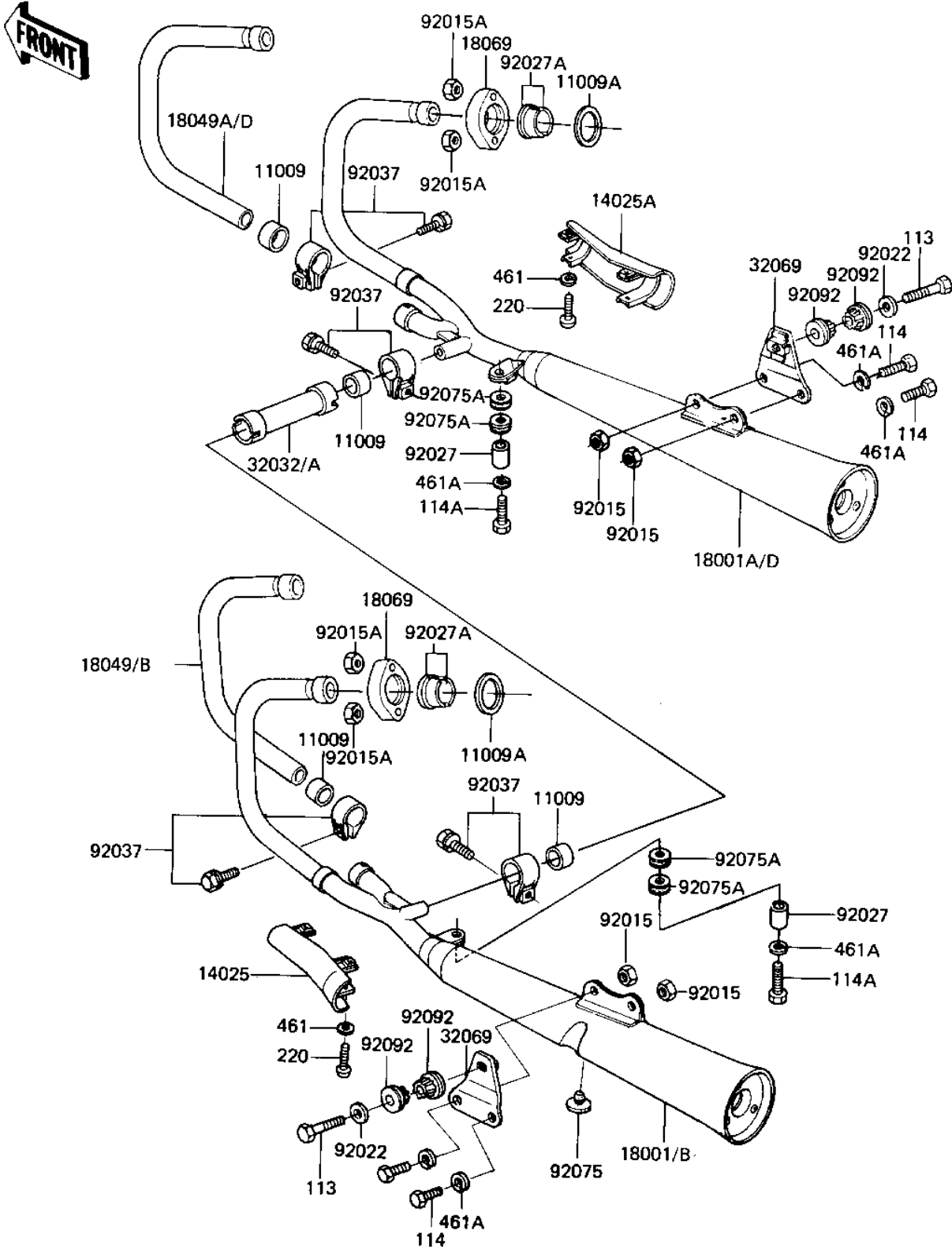

1981 LTD PARTS LIST

MUFFLERS

| ITEM NAME | PART NUMBER | QUANTITY |
|---|-------------|----------|
| GASKET,MANIFOLD EXHA (Ref # 11009) | 11060-1068 | 4 |
| GASKET,EXHAUST PIPE (Ref # 11009A) | 11009-1906 | 4 |
| COVER,MUFFLER,LH (Ref # 14025) | 14025-1355 | 1 |
| COVER,MUFFLER,RH (Ref # 14025A) | 14025-1356 | 1 |
| MUFFLER,LH (Ref # 18001) | 18001-1316 |) |
| MUFFLER,LH (Ref # 18001) | 18001-1316 | 1 |
| MUFFLER,RH (Ref # 18001A) | 18001-1317 |) |
| MUFFLER,RH (Ref # 18001A) | 18001-1317 | 1 |
| MUFFLER,LH (Ref # 18001B) | 18001-1316 | 1 |
| MUFFLER,RH (Ref # 18001D) | 18001-1317 | 1 |
| UNAVAILABLE IN PRICE BOOK (Ref # 18049) | 18049-113 |) |
| UNAVAILABLE IN PRICE BOOK (Ref # 18049) | 18049-113 | 1 |
| PIPE-EXHAUST,#3 (Ref # 18049A) | 18049-1135 |) |
| PIPE-EXHAUST,#3 (Ref # 18049A) | 18049-1135 | 1 |
| PIPE-EXHAUST,#2 (Ref # 18049B) | 18049-1188 | 1 |
| PIPE-EXHAUST,#3 (Ref # 18049D) | 18049-1189 | 1 |
| HOLDER-EXHAUST PIPE (Ref # 18069) | 18069-1015 | 4 |
| PIPE,MUFFLER CONNECT (Ref # 32032) | 32032-1676 |) |
| PIPE,MUFFLER CONNECT (Ref # 32032) | 32032-1676 | 1 |
| PIPE,MUFFLER CONNECT (Ref # 32032A) | 32032-1676 | 1 |
| BRACKET-MUFFLER,LH (Ref # 32069) | 32069-1074 | 2 |
| NUT,LOCK,8MM (Ref # 92015) | 92015-1124 | 4 |
| NUT-8MM (Ref # 92015A) | 92015-1143 | 8 |
| WASHER,PLAIN (Ref # 92022) | 92022-289 | 2 |
| COLLAR (Ref # 92027) | 92027-1064 | 2 |
| COLLAR,EXHAUST PIPE (Ref # 92027A) | 92027-1300 | 8 |
| CLAMP,MUFFLER (Ref # 92037) | 92037-1258 | 4 |
| DAMPER RUBB MAIN STA (Ref # 92075) | 92075-015 | 1 |
| DAMPER RUBBER (Ref # 92075A) | 92075-1042 | 4 |