

# 1982 LTD PARTS DIAGRAM

## MUFFLERS

E1140-0069

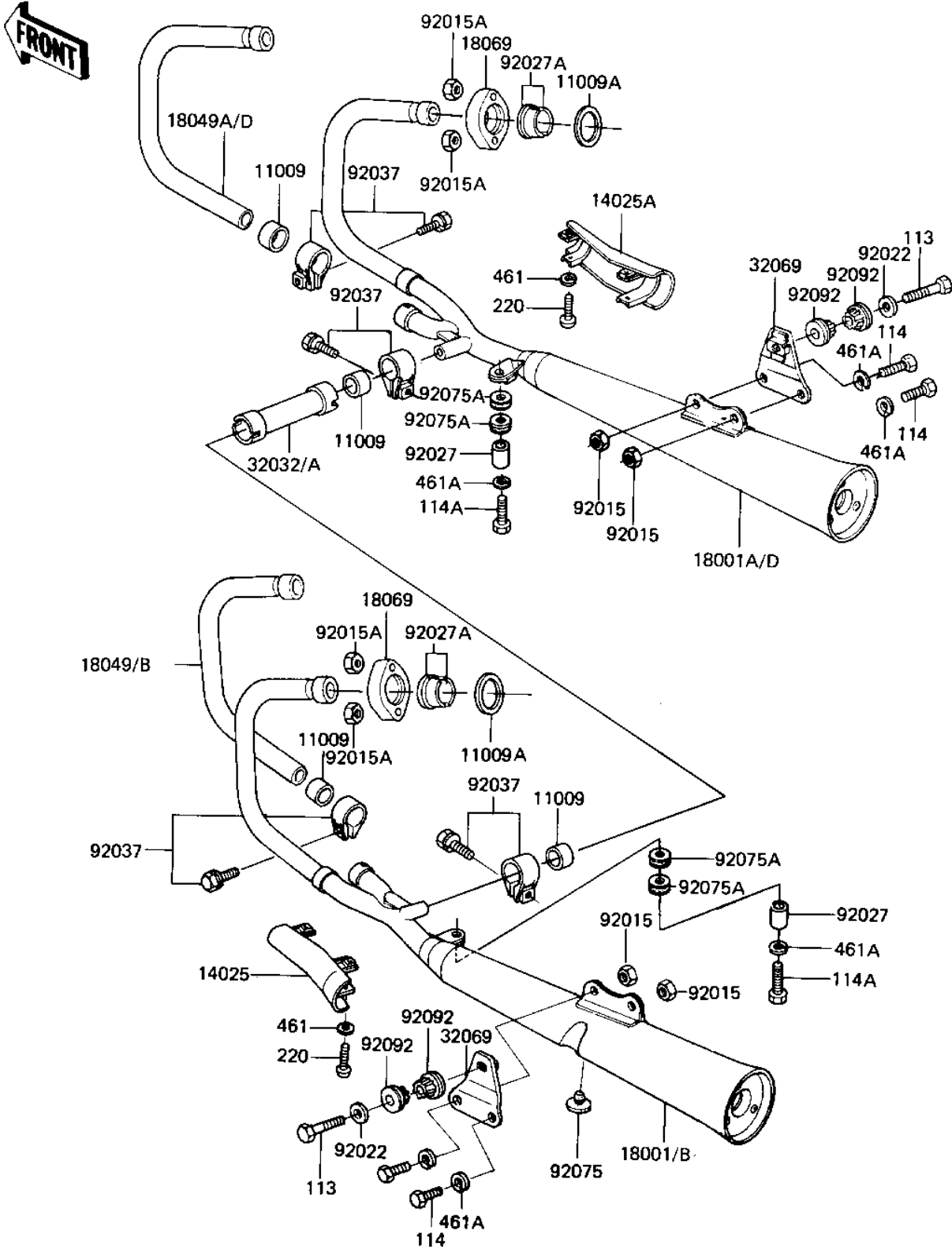

# 1982 LTD PARTS LIST

## MUFFLERS

| ITEM NAME                             | PART NUMBER | QUANTITY |
|---------------------------------------|-------------|----------|
| GASKET,MANIFOLD EXHA (Ref # 11009)    | 11060-1068  | 4        |
| GASKET,EXHAUST PIPE (Ref # 11009A)    | 11009-1906  | 4        |
| COVER,MUFFLER,LH (Ref # 14025)        | 14025-1355  | 1        |
| COVER,MUFFLER,RH (Ref # 14025A)       | 14025-1356  | 1        |
| MUFFLER,RH (Ref # 18001A)             | 18001-1317  | )        |
| MUFFLER,RH (Ref # 18001A)             | 18001-1317  | 1        |
| MUFFLER,LH (Ref # 18001B)             | 18001-1316  | 1        |
| MUFFLER,RH (Ref # 18001D)             | 18001-1317  | 1        |
| PIPE-EXHAUST,#3 (Ref # 18049A)        | 18049-1135  | )        |
| PIPE-EXHAUST,#3 (Ref # 18049A)        | 18049-1135  | 1        |
| PIPE-EXHAUST,#2 (Ref # 18049B)        | 18049-1188  | 1        |
| PIPE-EXHAUST,#3 (Ref # 18049D)        | 18049-1189  | 1        |
| HOLDER-EXHAUST PIPE (Ref # 18069)     | 18069-1015  | 4        |
| PIPE,MUFFLER CONNECT (Ref # 32032)    | 32032-1676  | 1        |
| PIPE,MUFFLER CONNECT (Ref # 32032A)   | 32032-1676  | 1        |
| BRACKET-MUFFLER,LH (Ref # 32069)      | 32069-1074  | 2        |
| NUT,LOCK,8MM (Ref # 92015)            | 92015-1124  | 4        |
| NUT-8MM (Ref # 92015A)                | 92015-1143  | 8        |
| WASHER,PLAIN (Ref # 92022)            | 92022-289   | 2        |
| COLLAR (Ref # 92027)                  | 92027-1064  | 2        |
| COLLAR,EXHAUST PIPE (Ref # 92027A)    | 92027-1300  | 8        |
| CLAMP,MUFFLER (Ref # 92037)           | 92037-1258  | 4        |
| DAMPER RUBB MAIN STA (Ref # 92075)    | 92075-015   | 1        |
| DAMPER RUBBER (Ref # 92075A)          | 92075-1042  | 4        |
| BUSHING-RUBBER (Ref # 92092)          | 92092-1013  | 4        |
| BOLT-HEX HEAD,10X55 (Ref # 113)       | 113N1055    | 2        |
| UNAVAILABLE IN PRICE BOOK (Ref # 114) | 114N0816    | 4        |
| BOLT HEX HEAD (Ref # 114A)            | 114N0835    | 2        |
| UNAVAILABLE IN PRICE BOOK (Ref # 220) | 220N0645    | 4        |