

1981 LTD PARTS DIAGRAM

SEAT

F2510-0066

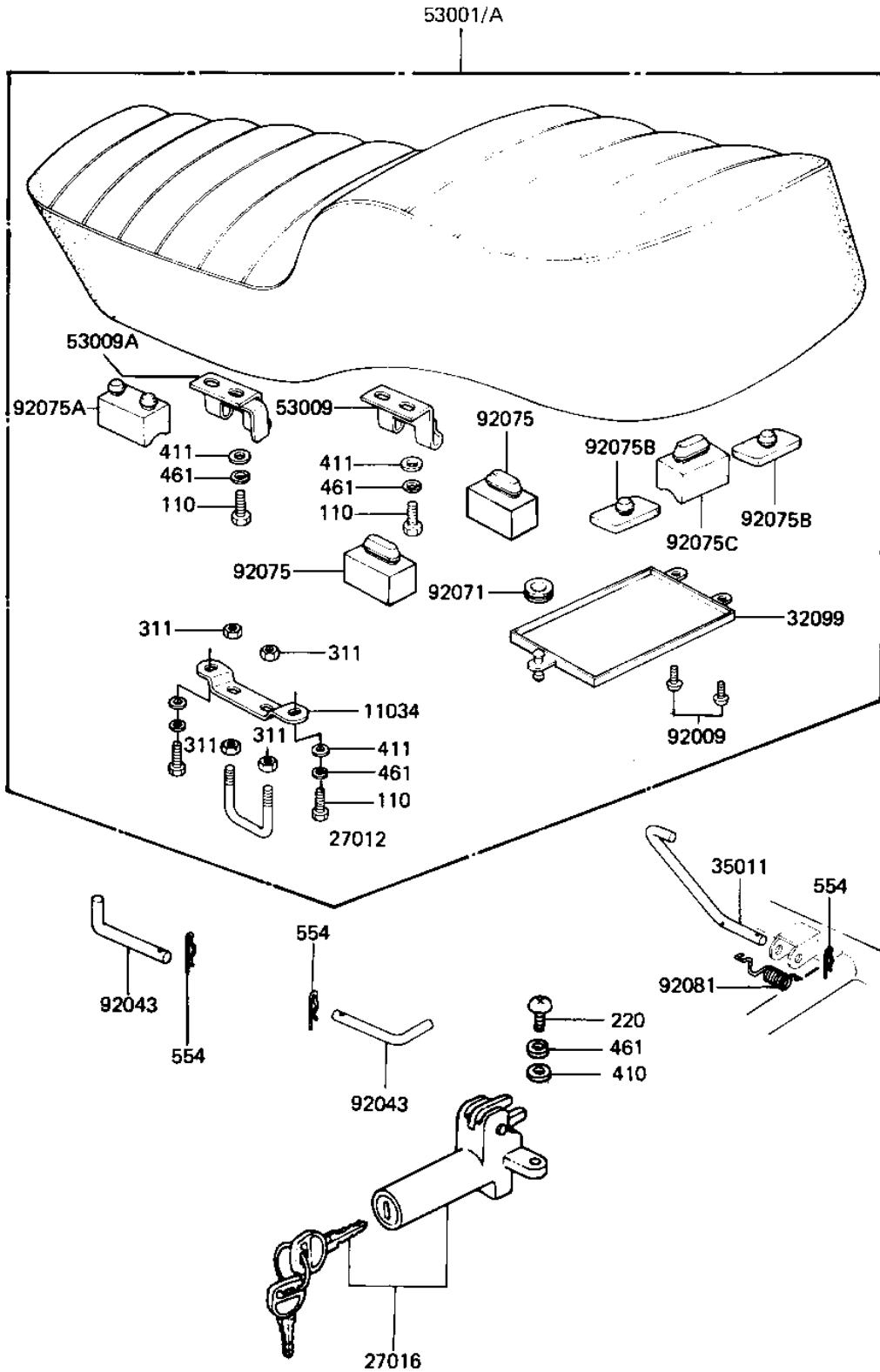

1981 LTD PARTS LIST

SEAT

ITEM NAME	PART NUMBER	QUANTITY
BRACKET,SEAT CATCH (Ref # 11034)	11034-1329	1
CATCH, SEAT (Ref # 27012)	53056-002	1
LOCK ASSY,SEAT (Ref # 27016)	27016-5015	1
CASE (Ref # 32099)	32099-011	1
STAY,SEAT STAND (Ref # 35011)	35011-1034	1
SEAT-ASSY (Ref # 53001)	53001-1227	1
HINGE,BLACK (Ref # 53009)	53009-017-10	1
HINGE,SEAT,FR (Ref # 53009A)	53009-1029	1
SCREW (Ref # 92009)	92009-1043	2
PIN,SEAT PIVOT (Ref # 92043)	92043-1021	2
GROMMET (Ref # 92071)	92071-056	1
DAMPER RUBBER (Ref # 92075)	92075-099	3
DAMPER RUBBER,SEAT (Ref # 92075A)	92075-1133	1
DAMPER,SEAT (Ref # 92075B)	92075-1153	2
DAMPER RUBBER-SEAT (Ref # 92075C)	92075-156	1
SPRING,SEAT HOOK (Ref # 92081)	92081-1053	1
BOLT-UPSET 6X14 (Ref # 110)	112B0614	6
SCREW PAN HEAD 6X14 (Ref # 220)	220B0614	1
NUT 6MM (Ref # 311)	311B0600	4
WASHER PLAIN 6MM (Ref # 410)	410B0600	1
WASHER PLAIN 6MM (Ref # 411)	411B0600	6
WASHER SPRING 6MM (Ref # 461)	461F0600	7
PIN,SNAP (Ref # 554)	554A0600	3