

# 1981 KZ1000-J1 PARTS DIAGRAM

## MUFFLERS

E1140-0121

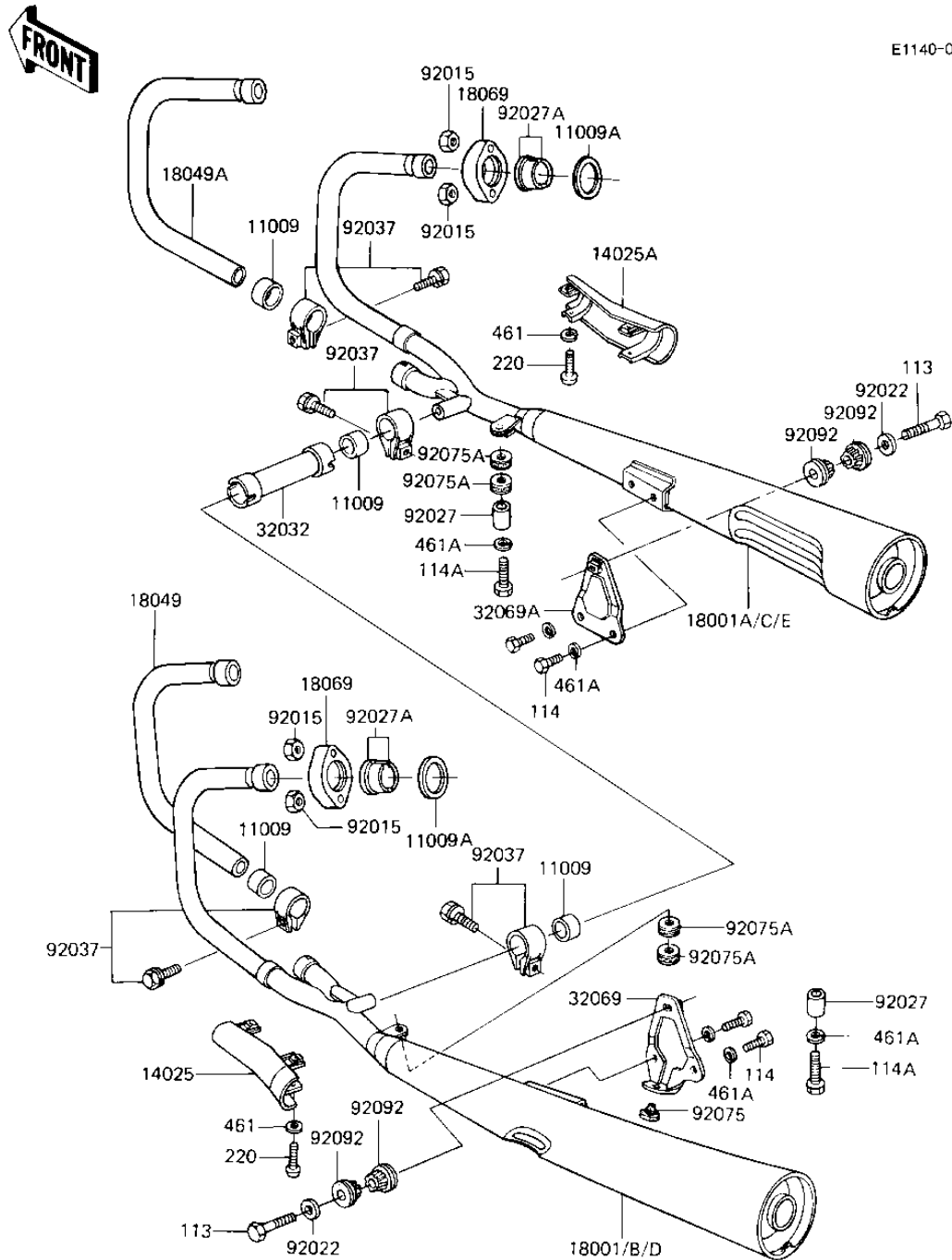

# 1981 KZ1000-J1 PARTS LIST

## MUFFLERS

ITEM NAME	PART NUMBER	QUANTITY
GASKET,MANIFOLD EXHAU (Ref # 11009)	11060-1068	4
GASKET,EXHAUST PIPE H (Ref # 11009A)	11009-1906	4
COVER,MUFFLER,LH (Ref # 14025)	14025-1261	1
COVER,MUFFLER,RH (Ref # 14025A)	14025-1262	1
MUFFLER,LH (Ref # 18001)	18001-1312	1
MUFFLER,RH (Ref # 18001A)	18001-1313	1
18001-1392 (Canada) (Ref # 18001B)	18001-1314	1
18001-1393 (Canada) (Ref # 18001C)	18001-1315	1
PIPE-EXHAUST,#2 (Ref # 18049)	18049-1188	1
PIPE-EXHAUST,#3 (Ref # 18049A)	18049-1189	1
HOLDER-EXHAUST PIPE (Ref # 18069)	18069-1015	4
PIPE,MUFFLER CONNECT (Ref # 32032)	32032-1676	1
BRACKET-MUFFLER,LH (Ref # 32069)	32069-1066	1
BRACKET-MUFFLER,RH (Ref # 32069A)	32069-1067	1
NUT-8MM (Ref # 92015)	92015-1143	8
WASHER,PLAIN (Ref # 92022)	92022-289	2
COLLAR (Ref # 92027)	92027-1064	2
COLLAR,EXHAUST PIPE (Ref # 92027A)	92027-1300	8
CLAMP,MUFFLER (Ref # 92037)	92037-1258	4
DAMPER RUBB MAIN STAD (Ref # 92075)	92075-015	1
DAMPER RUBBER (Ref # 92075A)	92075-1042	4
BUSHING-RUBBER (Ref # 92092)	92092-1013	4
BOLT-HEX HEAD,10X55 (Ref # 113)	113N1055	2
BOLT-SMALL-UPSET,8X16 (Ref # 114)	115G0816	4
BOLT,SMALL UPSET (Ref # 114A)	115G0835	2
SCREW PAN HEAD 6X45 (Ref # 220)	220B0645	4
WASHER SPRING 6MM (Ref # 461)	461F0600	4
WASHER SPRING 8MM (Ref # 461A)	461F0800	6