

1981 Shaft PARTS DIAGRAM

MUFFLERS

E1140-0122

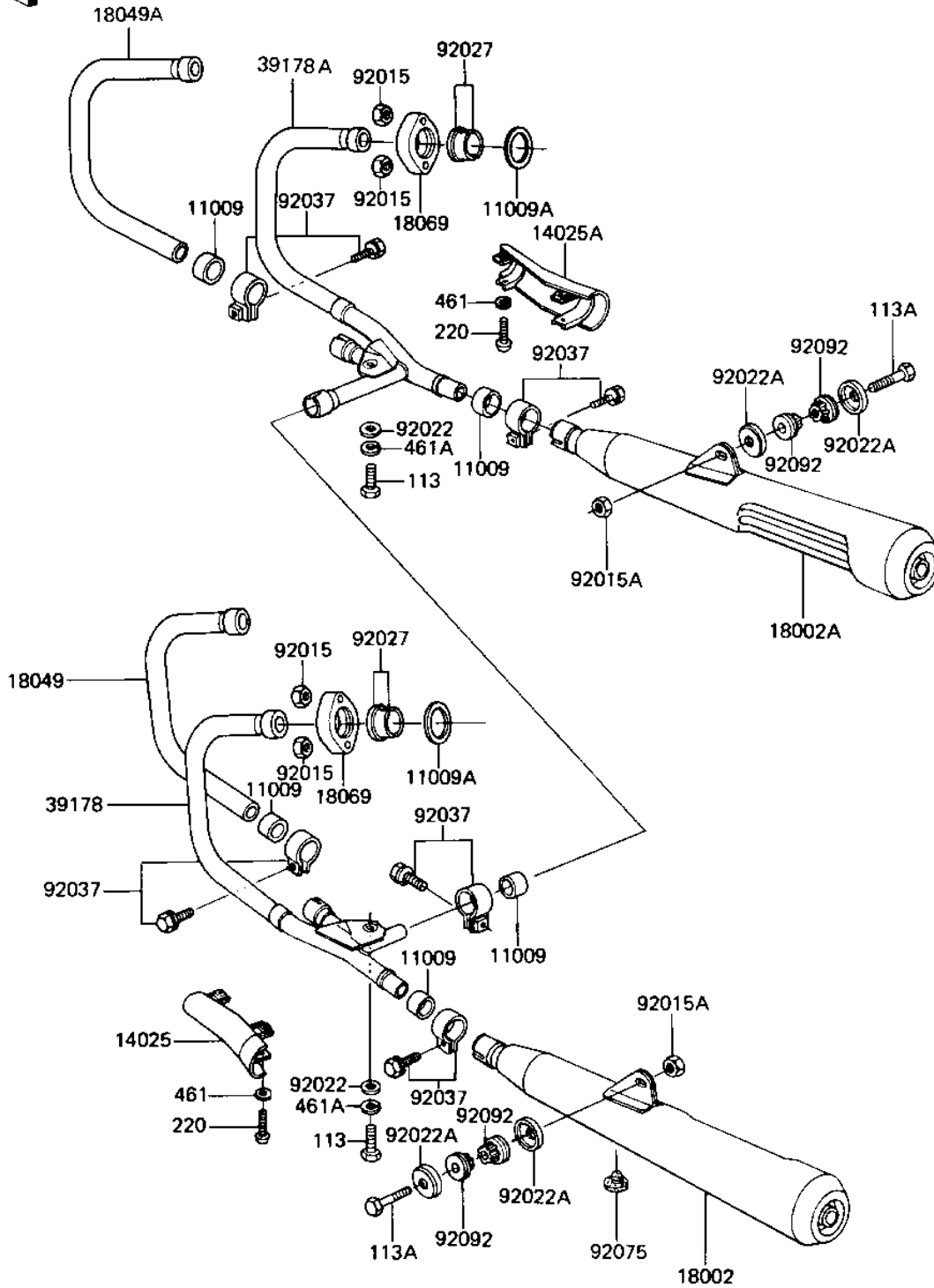

1981 Shaft PARTS LIST

MUFFLERS

ITEM NAME	PART NUMBER	QUANTITY
GASKET,MANIFOLD EXHAU (Ref # 11009)	11060-1068	5
GASKET,EXHAUST PIPE H (Ref # 11009A)	11009-1906	4
COVER,MUFFLER,LH (Ref # 14025)	14025-1355	1
COVER,MUFFLER,RH (Ref # 14025A)	14025-1356	1
BODY-COMP-MUFFLER,LH (Ref # 18002)	18002-1418	1
BODY-COMP-MUFFLER,RH (Ref # 18002A)	18002-1419	1
PIPE-EXHAUST,#2 (Ref # 18049)	18049-1188	1
PIPE-EXHAUST,#3 (Ref # 18049A)	18049-1189	1
HOLDER-EXHAUST PIPE (Ref # 18069)	18069-1015	4
MANIFOLD-EXHAUST,LH (Ref # 39178)	39178-1014	1
MANIFOLD-EXHAUST,RH (Ref # 39178A)	39178-1015	1
NUT-8MM (Ref # 92015)	92015-1143	8
NUT,LOCK,10MM (Ref # 92015A)	92019-021	2
WASHER,PLAIN (Ref # 92022)	92022-1022	2
WASHER,CUP TYPE (Ref # 92022A)	92022-1270	4
COLLAR,EXHAUST PIPE (Ref # 92027)	92027-1300	8
CLAMP,MUFFLER (Ref # 92037)	92037-1258	5
DAMPER RUBBER,MAIN ST (Ref # 92075)	92075-1002	1
BUSHING-RUBBER (Ref # 92092)	92092-1013	4
BOLT HEX HEAD 10X80 (Ref # 113)	113B1080	2
BOLT-HEX HEAD,10X55 (Ref # 113A)	113N1055	2
SCREW PAN HEAD 6X45 (Ref # 220)	220B0645	4
WASHER SPRING 6MM (Ref # 461)	461F0600	4
WASHER SPRING 10MM (Ref # 461A)	461F1000	2