

1981 Shaft PARTS DIAGRAM

METERS (KZ1100-A1/A2)

F2530-0173

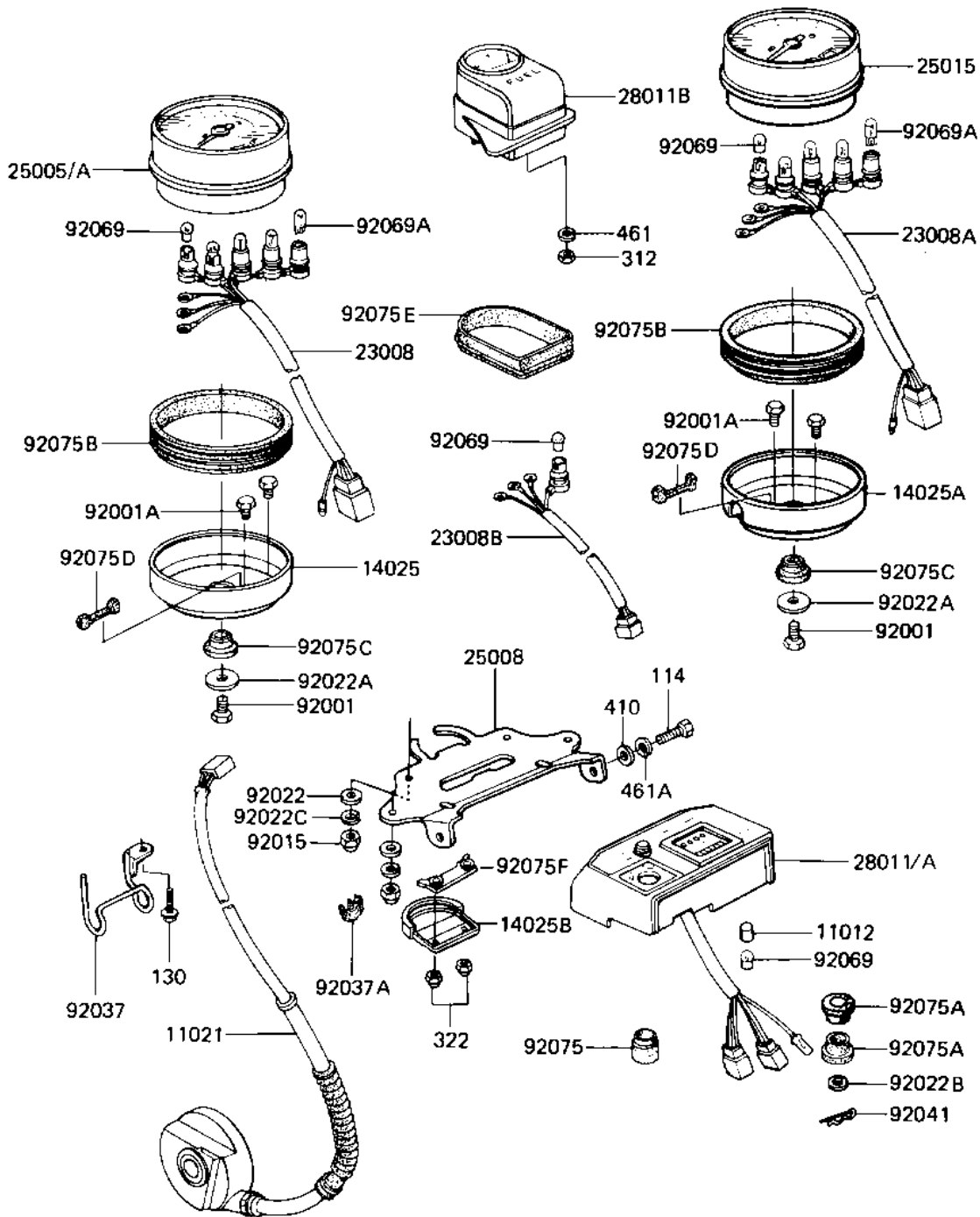

1981 Shaft PARTS LIST

METERS (KZ1100-A1/A2)

ITEM NAME	PART NUMBER	QUANTITY
CAP,BULB,GREEN (Ref # 11012)	11012-1172	1
CASE-ASSY (Ref # 11021)	11021-1011	1
COVER,SPEEDOMETER (Ref # 14025)	14025-1348	1
COVER,TACHOMETER (Ref # 14025A)	14025-1349	1
COVER,FUEL METER (Ref # 14025B)	14025-1350	1
SOCKET-ASSY,SPEEDOMET (Ref # 23008)	23008-1090	1
SOCKET-ASSY,TACHOMETE (Ref # 23008A)	23008-1091	1
SOCKET-ASSY,FUEL METE (Ref # 23008B)	23008-1092	1
SPEEDOMETER,MPH (Ref # 25005)	25005-1106	1
SPEEDOMETER,KPH (Canada) (Ref # 25005A)	25005-1107	1
BRACKET-METER (Ref # 25008)	25008-1034	1
TACHOMETER (Ref # 25015)	25015-1082	1
METER,TOTAL & TRIP (Ref # 28011)	28011-1014	1
METER,TOTAL & TRIP (Canada) (Ref # 28011A)	28011-1015	1
METER,FUEL (Ref # 28011B)	28011-1025	1
BOLT,6X8 (Ref # 92001)	92001-1443	2
BOLT,HEX HEAD,6X14 (Ref # 92001A)	92003-204	4
NUT-CAP,6MM,BLACK (Ref # 92015)	322C0600	4
WASHER PLAIN (Ref # 92022)	411F0600	4
WASHER 6.5X26X1 (Ref # 92022A)	92022-1249	2
WASHER,PLAIN,6MM (Ref # 92022B)	92022-263	2
WASHER-SPRING,6MM,BLA (Ref # 92022C)	461K0600	4
CLAMP (Ref # 92037)	92037-1230	1
CLAMP,CASE ASSY,WIRE (Ref # 92037A)	92037-1249	3
PIN,COTER (Ref # 92041)	92041-006	2
BULB 12V 1.5W (Ref # 92069)	92069-017	6
BULB,12V3.4W (Ref # 92069A)	92069-1007	6
DAMPER (Ref # 92075)	92075-1286	1
DAMPER,TRIP METER (Ref # 92075A)	92075-1300	4

1981 Shaft PARTS LIST

METERS (KZ1100-A1/A2)

ITEM NAME	PART NUMBER	QUANTITY
DAMPER,METER (Ref # 92075B)	92075-1315	2
DAMPER (Ref # 92075C)	92075-1316	2
DAMPER (Ref # 92075D)	92075-1317	2
DAMPER,FUEL METER (Ref # 92075E)	92075-1318	1
DAMPER (Ref # 92075F)	92075-1319	1
BOLT-SMALL-UPSET,8X18 (Ref # 114)	115G0818	2
BOLT,FLANGED,6X8 (Ref # 130)	130B0608	1
NUT-HEX (Ref # 312)	312B0300A	3
NUT-CAP,4MM (Ref # 322)	322N0400A	2
WASHER PLAIN 8MM (Ref # 410)	410B0800	2
WASHER SPRING 3MM (Ref # 461)	461F0300	3
WASHER SPRING 8MM (Ref # 461A)	461F0800	2