

1982 GPz PARTS DIAGRAM

FRONT FORK (KZ1100-B2)

F2340-0102

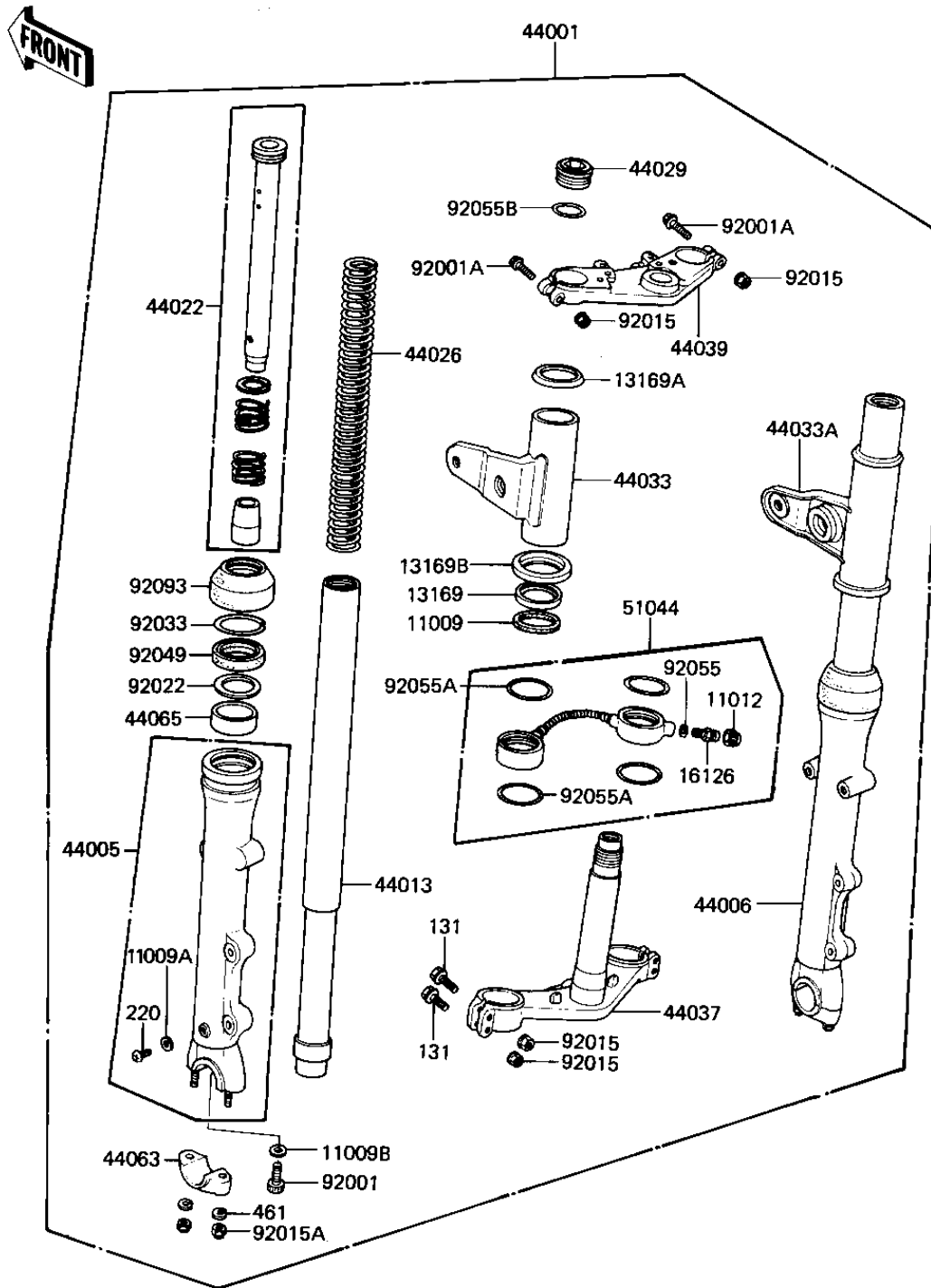

1982 GPz PARTS LIST

FRONT FORK (KZ1100-B2)

ITEM NAME	PART NUMBER	QUANTITY
GASKET,FORK COVER (Ref # 11009)	11009-1015	2
GASKET FORK DRAIN PLG (Ref # 11009A)	44045-002	2
GASKET,FORK CYLINDER (Ref # 11009B)	44045-057	2
CAP,AIR VALVE (Ref # 11012)	11012-1241	2
WASHER,FRK COVER GIDE (Ref # 13169)	13169-1020	2
PLATE,FORK COVER,UPP (Ref # 13169A)	13169-1498	2
PLATE,FORK COVER,LWR (Ref # 13169B)	13169-1499	2
VALVE AIR (Ref # 16126)	16126-1052	1
FORK-FRONT (Ref # 44001)	44001-1338	1
TUBE,LH,FORK OUTER (Ref # 44005)	44005-1094	1
TUBE,RH,FORK OUTER (Ref # 44006)	44006-1094	1
PIPE-FORK INNER,INNER (Ref # 44013)	44013-1094	2
CYLINDER-FORK (Ref # 44022)	44022-1063	2
SPRING-FRONT FORK (Ref # 44026)	44026-1147	2
SEAT-FORK SPRING (Ref # 44029)	44029-1036	2
COVER-FORK-LH,F.BLACK (Ref # 44033)	44033-1085	1
COVER-FORK,RH,F.BLACK (Ref # 44033A)	44033-1086	1
HOLDER-FORK UNDER (Ref # 44037)	44037-1072	1
HOLDER-FORK UPPER (Ref # 44039)	44039-1052	1
HOLDER-FRONT AXLE (Ref # 44063)	44063-1006	2
BUSHING-FRONT FORK,OU (Ref # 44065)	44065-1091	2
TUBE-ASSY,AIR,FORK (Ref # 51044)	51044-1021	1
BOLT-FORK CYLINDER (Ref # 92001)	44041-040	2
BOLT,FLANGED,8X57,BLA (Ref # 92001A)	92001-1572	2
NUT,FLANGED,8MM (Ref # 92015)	92015-1408	6
NUT,U,8MM,BLACK (Ref # 92015A)	92015-1205	4
WASHER,FORK OUT PIPE (Ref # 92022)	92022-1262	2
SNAP RING,FORK OUTER (Ref # 92033)	92033-1047	2
SEAL-OIL,FORK OUTER T (Ref # 92049)	92049-1295	2

1982 GPz PARTS LIST

FRONT FORK (KZ1100-B2)

ITEM NAME	PART NUMBER	QUANTITY
"O" RING,AIR VALVE (Ref # 92055)	92055-1094	1
RING-O,ROD (Ref # 92055A)	92055-1369	4
RING-O,FORK SPRING SE (Ref # 92055B)	92055-1135	2
SEAL (Ref # 92093)	92093-1051	2
BOLT-FLANGED,8X55,BLA (Ref # 131)	131J0855	4
SCREW PAN HEAD 4X8 (Ref # 220)	220B0408	2
WASHER-SPRING,8MM,BLA (Ref # 461)	461K0800	4