

1980 LTD II PARTS DIAGRAM

VALVES

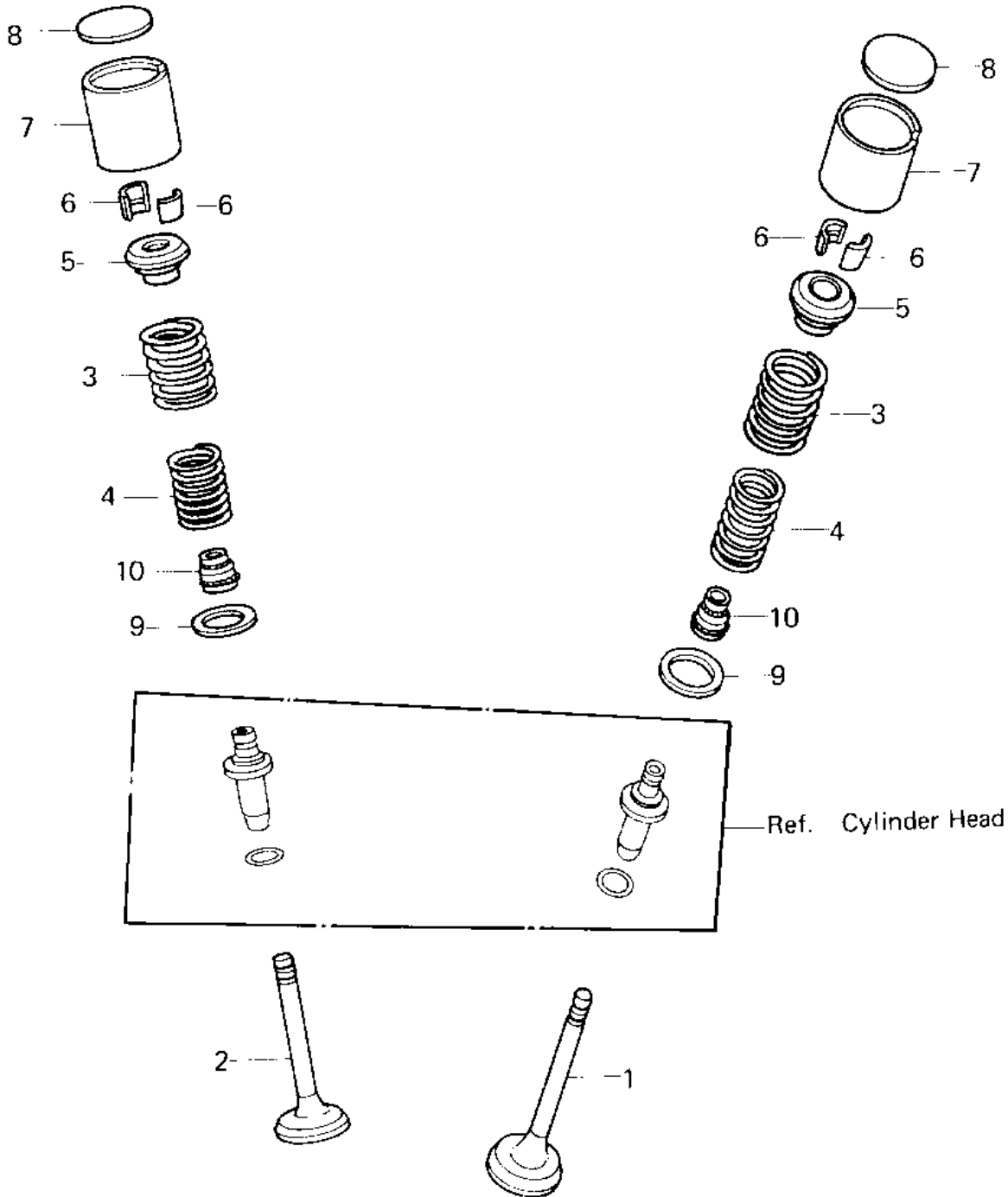

1980 LTD II PARTS LIST

VALVES

ITEM NAME	PART NUMBER	QUANTITY
VALVE,INLET (Ref # 1)	12004-014	2
VALVE,EXHAUST (Ref # 2)	12005-007	2
SPRING,OUTER VALVE (Ref # 3)	12007-015	4
SPRING,INNER VALVE (Ref # 4)	12007-016	4
RETAINER,VALVE SPRIN (Ref # 5)	12009-007	4
COLLAR,VALVE SPRING (Ref # 6)	12011-003	8
TAPPET (Ref # 7)	12032-006	4
SHIM,2.20T (Ref # 8)	12037-051	AR
SHIM,2.25T (Ref # 8)	12037-052	AR
SHIM,2.30T (Ref # 8)	12037-053	AR
SHIM,2.35T (Ref # 8)	12037-054	AR
SHIM,2.40T (Ref # 8)	12037-055	AR
SHIM,2.45T (Ref # 8)	12037-056	AR
SHIM,2.50T (Ref # 8)	12037-057	AR
SHIM,2.55T (Ref # 8)	12037-058	AR
SHIM,2.60T (Ref # 8)	12037-059	AR
SHIM,2.65T (Ref # 8)	12037-060	AR
SHIM,2.70T (Ref # 8)	12037-061	AR
SHIM,2.75T (Ref # 8)	12037-062	AR
SHIM,2.80T (Ref # 8)	12037-063	AR
SHIM,2.85T (Ref # 8)	12037-064	AR
SHIM,2.90T (Ref # 8)	12037-065	AR
SHIM,2.95T (Ref # 8)	12037-066	AR
SHIM,3.00T (Ref # 8)	12037-067	AR
SHIM,3.05T (Ref # 8)	12037-068	AR
SHIM,3.10T (Ref # 8)	12037-069	AR
SHIM,3.15T (Ref # 8)	12037-070	AR
SHIM,3.20T (Ref # 8)	12037-071	AR
SHIM,3.25T (Ref # 8)	12037-072	AR

1980 LTD II PARTS LIST

VALVES

ITEM NAME	PART NUMBER	QUANTITY
SHIM,3.30T (Ref # 8)	12037-073	AR
SHIM,3.35T (Ref # 8)	12037-074	AR
SHIM,3.40T (Ref # 8)	12037-075	AR
WASHER,PLAIN (Ref # 9)	92022-309	4
OIL SEAL,VALVE (Ref # 10)	92049-017	4