

# 1980 LTD II PARTS DIAGRAM

## CARBURETORS

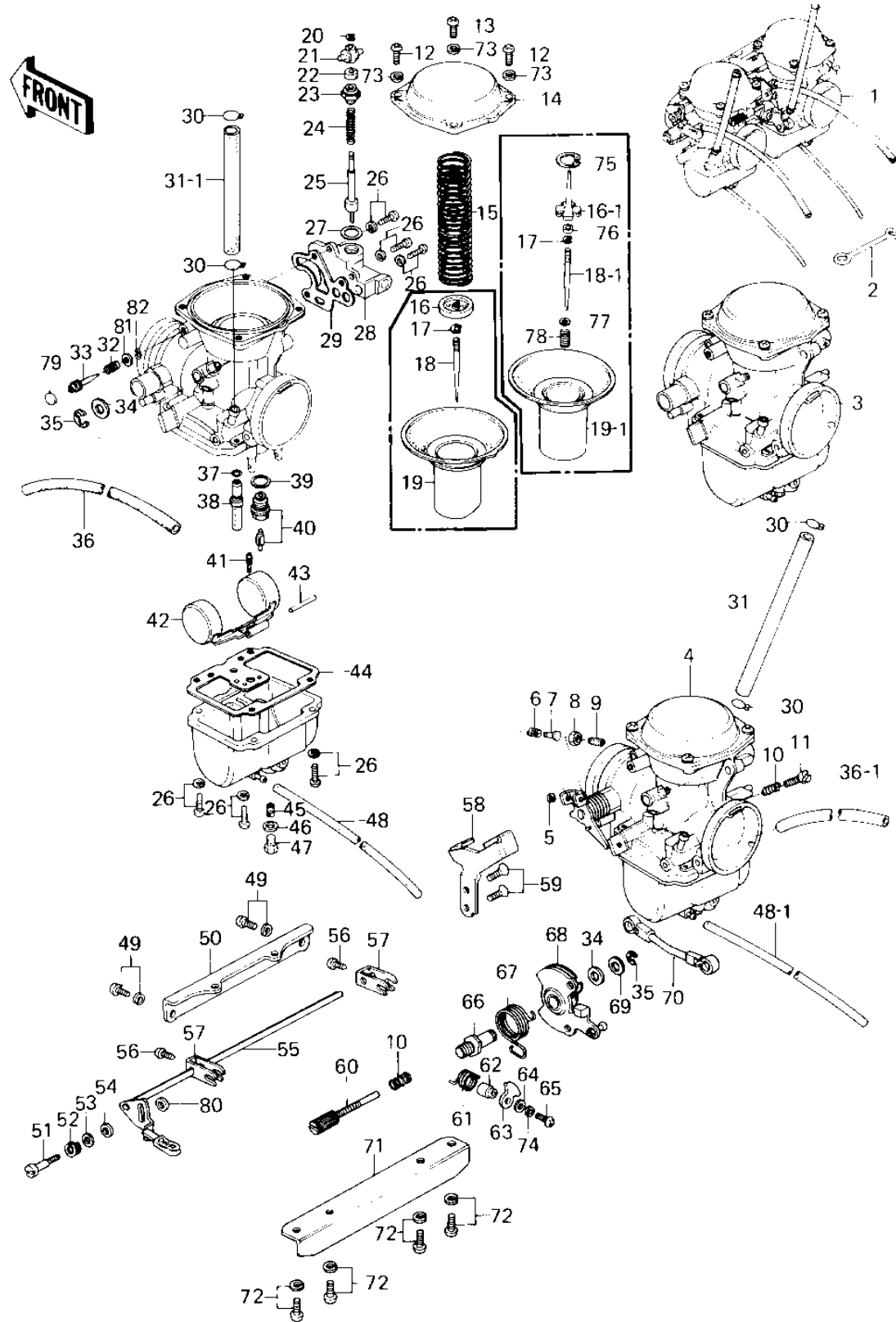

# 1980 LTD II PARTS LIST

## CARBURETORS

ITEM NAME	PART NUMBER	QUANTITY
CARBURETOR ASSY (Canada) (Ref # 1)	16001-1295	1
CARBURETOR ASSY (Ref # 1)	16001-1187	1
CLAMP,OVER FLOW PIPE (Ref # 2)	92037-134	1
CARBURETOR,L.H. (Ref # 3)	16001-1257	1
CARBURETOR,R.H. (Ref # 4)	16001-1256	1
CIRCLIP (Ref # 5)	16008-017	1
SPRING,LEVER (Ref # 6)	16040-019	1
PIN (Ref # 7)	16042-008	1
NUT 5MM (Ref # 8)	312B0500	1
SCREW,LEVER (Ref # 9)	16033-025	1
SPRING,THROTTLE ADJS (Ref # 10)	16022-010	2
ADJUSTER,THROTTLE LE (Ref # 11)	16021-020	1
SCREW-PAN-CROS (Ref # 12)	220B0514	6
UNAVAILABLE IN PRICE BOOK (Ref # 13)	214B0516A	2
COVER,DIAPHRAGM (Ref # 14)	14030-1012	2
PLATE,NEEDLE (Ref # 16)	16055-010	2
HOLDER,JET NEEDLE (Ref # 16-1)	13091-1026	2
CIRCLIP (Ref # 17)	16008-014	2
JET NEEDLE,#4HL14 (Ref # 18-1)	16009-1051	2
DIAPHRAGM (Ref # 19-1)	43028-1018	2
CIRCLIP (Ref # 20)	16076-003	2
LEVER,CHOKE ADJUST (Ref # 21)	16073-1006	2
RUBBER CAP,STARTER P (Ref # 22)	16036-017	2
GUIDE,PLUNGER (Ref # 23)	16012-1008	2
SPRING,STARTER PLUG (Ref # 24)	16013-008	2
PLUNGER,STARTER (Ref # 25)	16016-019	2
SCREW,FLOAT CHAM FIT (Ref # 26)	16033-027	14
WASHER,PLAIN (Ref # 27)	16039-041	2
BODY,STARTER (Ref # 28)	16131-1005	2

# 1980 LTD II PARTS LIST

## CARBURETORS

ITEM NAME	PART NUMBER	QUANTITY
WASHER (Ref # 29)	16029-011	2
CLAMP-PIPE (Ref # 30)	92037-072	4
PIPE,FUEL (Ref # 31)	92059-130	1
PIPE,FUEL (Ref # 31-1)	92059-130	1
SPRING,PILOT SCREW (Ref # 32)	92081-1216	2
SCREW,PILOT ADJUST (Ref # 33)	16014-1023	2
WASHER (Ref # 34)	16039-032	3
CIRCLIP (Ref # 35)	16008-015	3
HOSE,AIR VENT,4.5X25 (Ref # 36)	92059-1096	1
HOSE,AIR VENT,4.5X25 (Ref # 36-1)	92059-1096	1
"O" RING,NEEDLE JET (Ref # 37)	16038-021	2
NEEDLE JET,#AY-3 (Ref # 38)	16017-1048	2
GASKET,FLOAT VALVE (Ref # 39)	11009-1076	2
FLOAT VALVE ASSY (Ref # 40)	16030-026	2
PILOT JET,#40 (Ref # 41)	92064-1012	2
FLOAT (Ref # 42)	16031-030	2
FLOAT PIN (Ref # 43)	16032-003	2
GASKET,FLOAT CHAMBER (Ref # 44)	16019-029	2
MAIN JET,#A125 (Ref # 45)	92063-1061	2
WASHER,PLAIN (Ref # 46)	16039-036	2
SCREW,MAIN JET PLUG (Ref # 47)	92009-1090	2
HOSE,FUEL OVERFLOW (Ref # 48)	92059-127	1
HOSE,FUEL OVERFLOW (Ref # 48-1)	92059-127	1
SCREW,5X10 (Ref # 49)	16033-028	2
SHAFT (Ref # 50)	16041-014	1
SCREW (Ref # 51)	16046-005	1
SPRING,F (Ref # 52)	16040-009	1
WASHER (Ref # 53)	16039-033	1
WASHER,PLAIN,DURACON (Ref # 54)	92022-1147	1

# 1980 LTD II PARTS LIST

## CARBURETORS

ITEM NAME	PART NUMBER	QUANTITY
SHAFT,CHOKE LEVER (Ref # 55)	16041-1013	1
SCREW,PAN HEAD,5X7 (Ref # 56)	16046-007	2
LEVER,CHOKE ADJUST (Ref # 57)	13168-1062	2
BRACKET (Ref # 58)	16070-004	1
SCREW,5X8 (Ref # 59)	16033-024	2
THROTTLE ADJUSTER (Ref # 60)	16021-027	1
SPRING (Ref # 61)	16040-018	1
COLLAR (Ref # 62)	16073-012	1
LEVER (Ref # 63)	16063-010	1
WASHER,PLAIN (Ref # 64)	16039-038	1
SCREW-PAN HEAD,4X20 (Ref # 65)	220E0420A	1
SHAFT (Ref # 66)	16041-015	1
SPRING,THROTTLE CABL (Ref # 67)	16040-017	1
PULLY,THROTTLE CABLE (Ref # 68)	16074-004	1
WASHER,PLAIN (Ref # 69)	16039-037	1
JOINT (Ref # 70)	16046-008	1
PLATE (Ref # 71)	16055-011	1
SCREW (Ref # 72)	16033-026	4
WASHER SPRING 5MM (Ref # 73)	461F0500	8
WASHER SPRING 4MM (Ref # 74)	461F0400	1
CIRCLIP (Ref # 75)	92033-1009	2
RING,JET NEEDLE (Ref # 76)	92027-1115	2
WASHER,JET NEEDLE (Ref # 77)	92022-1123	2
SPRING,JET NEEDLE (Ref # 78)	92081-1126	2
PLUG,PILOT SCREW (Ref # 79)	92066-1051	2
WASHER,PLAIN (Ref # 80)	92022-1152	1
WASHER,PILOT SCREW (Ref # 81)	92022-1187	2
"O" RING,PILOT SCREW (Ref # 82)	92055-1078	2