

# 1976 LTD PARTS DIAGRAM

## SWING ARM/SHOCK ABSORBERS

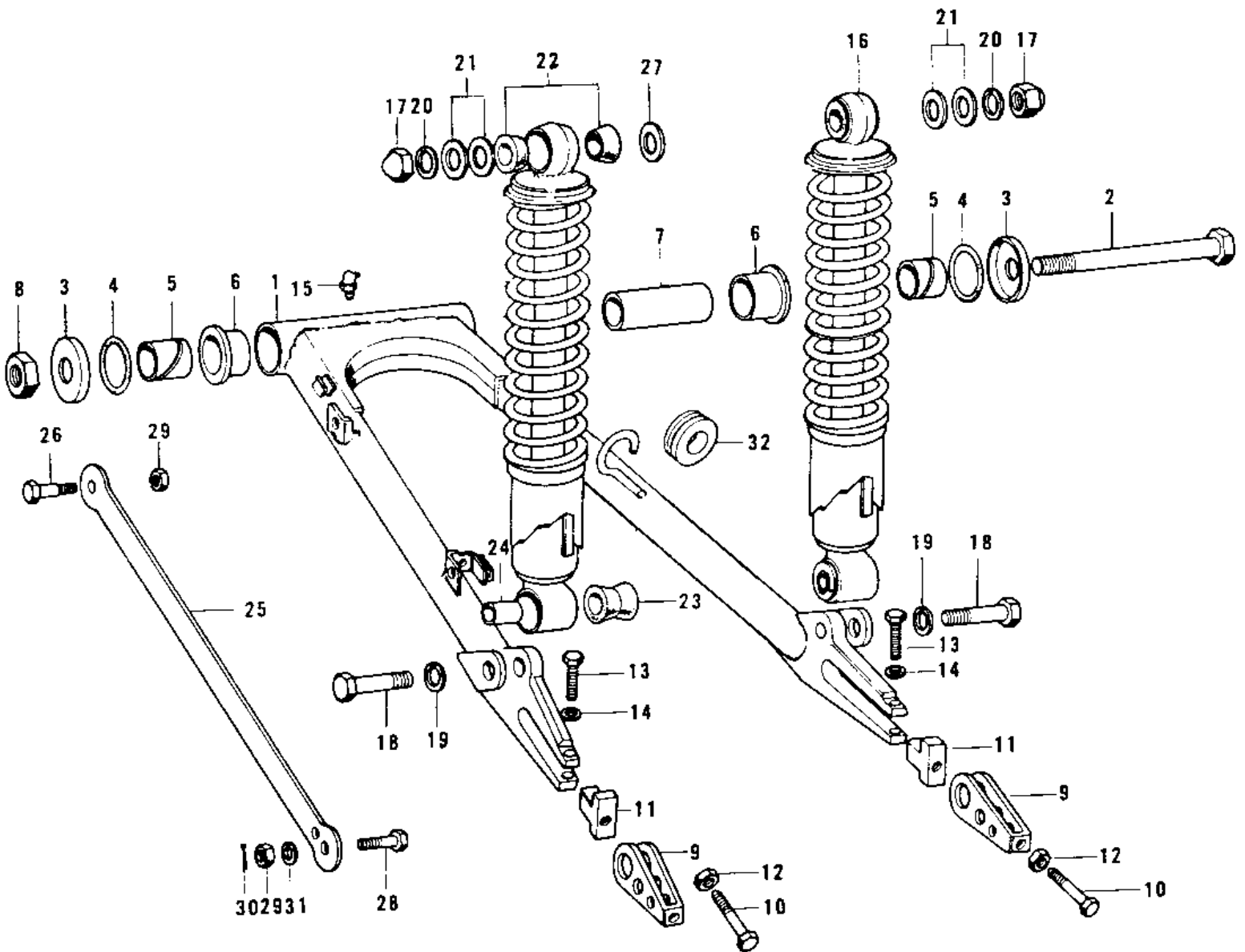

# 1976 LTD PARTS LIST

## SWING ARM/SHOCK ABSORBERS

ITEM NAME	PART NUMBER	QUANTITY
SWING ARM (Ref # 1)	33001-090	1
SHAFT,SWING ARM PIVO (Ref # 2)	33032-036	1
CAP,SWING ARM (Ref # 3)	33035-007	2
"0" RING,30MM (Ref # 4)	671B2530	2
SLEEVE SWING ARM (Ref # 5)	33034-009	2
BUSHING-SWING ARM (Ref # 6)	33033-009	2
COLLAR,SWING ARM (Ref # 7)	33036-005	1
NUT-SELF LOCKING (Ref # 8)	92019-012	1
ADJUSTER,CHAIN (Ref # 9)	33040-066	2
BOLT-CHN ADJUST 10MM (Ref # 10)	92001-143	2
STOPPER,CHAIN ADJUST (Ref # 11)	33044-001	2
NUT 10MM (Ref # 12)	315B1000	2
BOLT (Ref # 13)	92001-1578	2
WASHER SPRING 8MM (Ref # 14)	461F0800	2
GREASE NIPPLE (Ref # 15)	92005-002	1
SHOCK ABSBR RR (Ref # 16)	45014-116	2
NUT 12MM (Ref # 17)	92020-014	2
BOLT HEX HEAD 10X35 (Ref # 18)	113N1035	2
WASHER SPRING 10MM (Ref # 19)	461F1000	2
WASHER SPRING 12MM (Ref # 20)	461F1200	2
WASHER PLAIN 12MM (Ref # 21)	410B1200	4
BUSH SHCK ABS RUBBER (Ref # 22)	45017-001	4
BUSHING,SHCK ABSORBE (Ref # 23)	45017-011	2
BUSH SHCK ABS PVT SF (Ref # 24)	45016-003	2
TORQUE LINK (Ref # 25)	43007-047	1
BOLT,FR TORQUE LINK (Ref # 26)	92003-225	1
WASHER,PLAIN (Ref # 27)	92022-326	1
BOLT,RR TORQUE LINK (Ref # 28)	92003-197	1
NUT,12MM (Ref # 29)	42045-021	2

# 1976 LTD PARTS LIST

## SWING ARM/SHOCK ABSORBERS

ITEM NAME	PART NUMBER	QUANTITY
PIN COTTER 3.0X25 (Ref # 30)	550D3025	1
WASHER SPRING 10MM (Ref # 31)	461F1000	1
DAMPER RUBBER (Ref # 32)	43064-007	1