

1980 Z1R PARTS DIAGRAM

TURN SIGNALS ('80 D3)

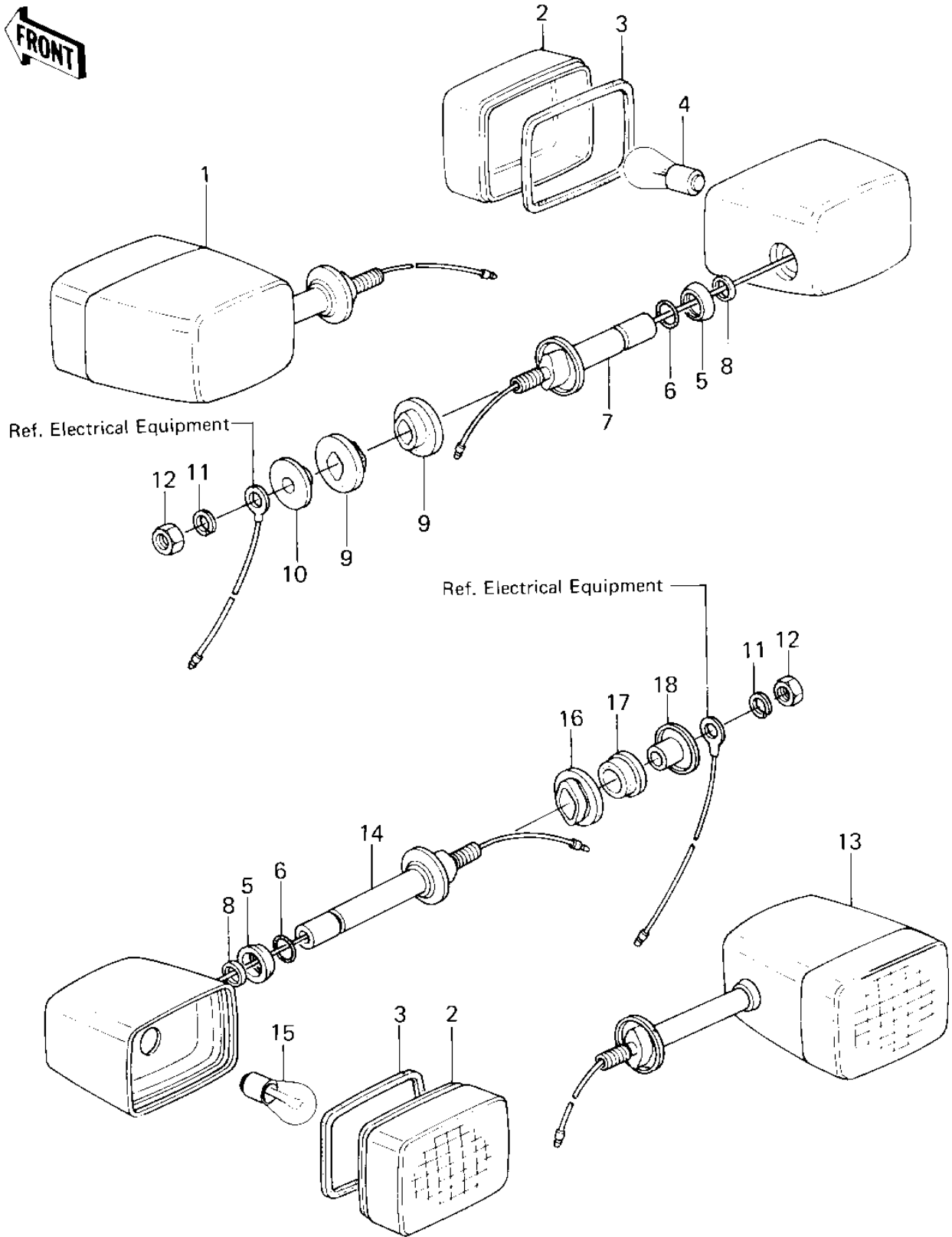

1980 Z1R PARTS LIST

TURN SIGNALS ('80 D3)

ITEM NAME	PART NUMBER	QUANTITY
LAMP ASSY,FR TURN SI (Ref # 1)	23037-1030	2
LENS,TURN SIGNAL (Ref # 2)	23048-1009	4
GASKET,TURN SIG LAMP (Ref # 3)	11009-1034	4
BULB,12V 23/8W (Ref # 4)	92069-060	2
RING (Ref # 5)	43058-1002	4
"O" RING,12MM (Ref # 6)	670B2012	4
BRACKET,TRN SIG FRON (Ref # 7)	23051-1010	2
GASKET,SIGNAL LAMP (Ref # 8)	11009-1048	4
DAMPER,TURN SIG FITT (Ref # 9)	92075-1014	4
COLLAR (Ref # 10)	92027-1059	2
WASHER SPRING 10MM (Ref # 11)	461F1000	4
NUT 10MM (Ref # 12)	315B1000	4
LAMP ASSY,RR TURN SI (Ref # 13)	23037-1031	2
BRACKET,TRN SIG REAR (Ref # 14)	23051-1011	2
BULB 12V 32CP (Ref # 15)	92069-055	2
DAMPER RUBBER (Ref # 16)	92075-128	2
DAMPER RUBBER,SIG LM (Ref # 17)	92075-158	2
COLLAR (Ref # 18)	92027-147	2