

# 1980 KZ1300-A2 PARTS DIAGRAM

## FRONT BEVEL GEARS

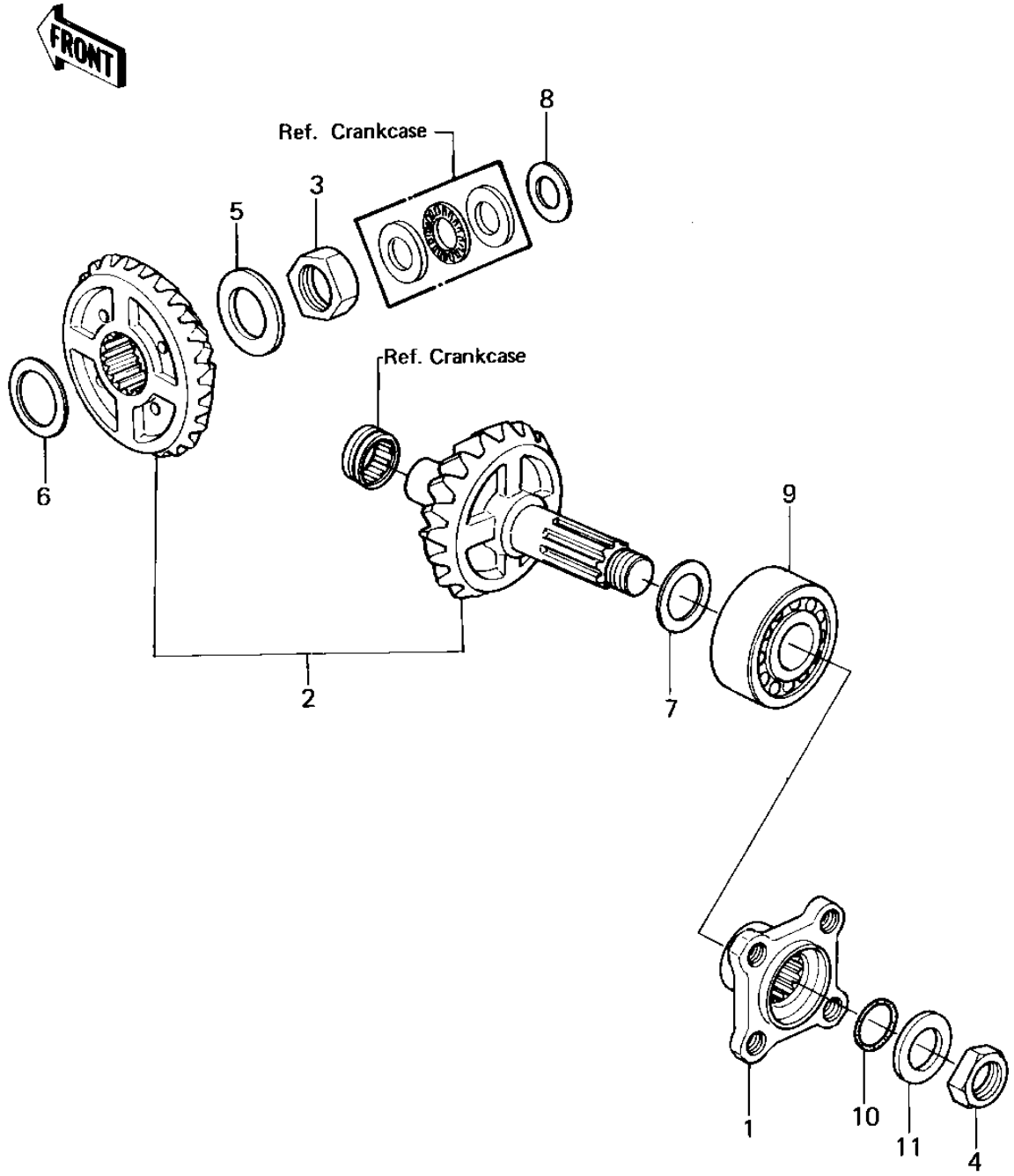

# 1980 KZ1300-A2 PARTS LIST

## FRONT BEVEL GEARS

ITEM NAME	PART NUMBER	QUANTITY
COUPLING,OUTPUT SHAFT (Ref # 1)	42034-1010	3
GEAR SET,FRONT BEVEL (Ref # 2)	13101-5025	3
NUT,24M/M (Ref # 3)	92015-1057	3
NUT 20MM (Ref # 4)	92016-028	3
WASHER,24M/M,CANICAL (Ref # 5)	92022-1104	3
SHIM,30.3X40X0.6 (Ref # 6)	92025-1006	3
SHIM,30.3X40X0.9 (Ref # 6)	92025-1007	3
SHIM,30.3X40X1.2 (Ref # 6)	92025-1008	3
SHIM,30.3X40X0.1 (Ref # 6)	92025-1009	3
SHIM,30.3X40X0.15 (Ref # 6)	92025-1010	3
SHIM,30.3X40X0.3 (Ref # 6)	92025-1012	3
SHIM,25.3X36X0.6 (Ref # 6)	92025-1013	3
SHIM,25.3X36X0.9 (Ref # 6)	92025-1014	3
SHIM,25.3X36X1.2 (Ref # 6)	92025-1696	3
SHIM,25.3X36X0.1 (Ref # 6)	92025-1016	3
SHIM,25.3X36X0.15 (Ref # 6)	92025-1017	3
SHIM,25.3X36X0.2 (Ref # 6)	92025-1018	3
SHIM,25.3X36X0.3 (Ref # 6)	92025-1019	3
SHIM,15.3X27.5X0.6 (Ref # 8)	92025-1020	3
SHIM,15.3X27.5X0.9 (Ref # 8)	92025-1021	3
SHIM,15.3X27.5X1.2 (Ref # 8)	92025-1022	3
SHIM,15.3X27.5X0.15 (Ref # 8)	92025-1024	3
SHIM,15.3X27.5X0.2 (Ref # 8)	92025-1025	3
SHIM,15.3X27.5X0.3 (Ref # 8)	92025-1026	3
BEARING,BALL,5305 (Ref # 9)	92045-1019	3
BEARING-BALL,5305SH2C (Ref # 9)	92045-1147	3
"O" RING,20.5MM (Ref # 10)	92055-1029	3
WASHER (Ref # 11)	92125-002	3