

# 1975 H1-F PARTS DIAGRAM

CRANKSHAFT/PISTONS ('69-72 H1/A/B/C)

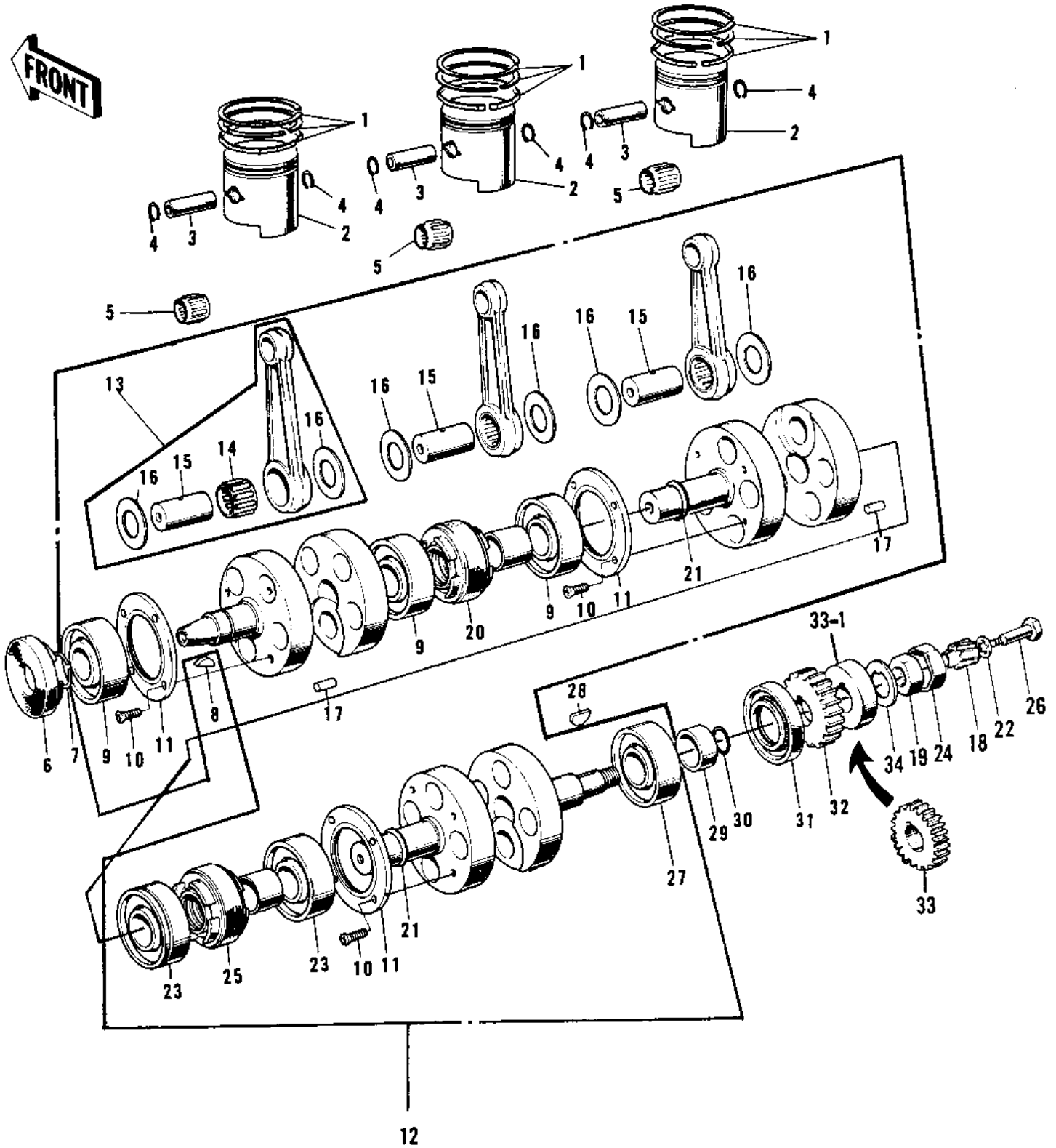

# 1975 H1-F PARTS LIST

CRANKSHAFT/PISTONS ('69-72 H1/A/B/C)

| ITEM NAME                        | PART NUMBER | QUANTITY |
|----------------------------------|-------------|----------|
| RING SET,STD (Ref # 1)           | 13008-041   | 3        |
| RING SET,0.020" O.S (Ref # 1)    | 13025-044   | (3       |
| RING SET,0.040" O.S (Ref # 1)    | 13024-048   | (3       |
| PISTON STD (Ref # 2)             | 13001-031   | 3        |
| PISTON 0.020' O.S (Ref # 2)      | 13029-031   | (3       |
| PISTON 0.040' O.S (Ref # 2)      | 13027-031   | (3       |
| PIN-PISTON (Ref # 3)             | 13002-010   | 3        |
| CIRCLIP PISTON PIN (Ref # 4)     | 92036-004   | 6        |
| BEARING-NEEDLE (Ref # 5)         | 92046-1038  | 3        |
| OIL SEAL,TC255210 (Ref # 6)      | 92050-051   | 1        |
| CIRCLIP (Ref # 7)                | 92036-013   | 1        |
| WOODRUFF KEY (Ref # 8)           | 92038-001   | 1        |
| BEARING BALL #6205 (Ref # 9)     | 601B6205    | 3        |
| SCREW CNTRSNK HD 5X10 (Ref # 10) | 92012-001   | 12       |
| OIL RECEIVER,CRANKSFT (Ref # 11) | 13045-010   | 3        |
| CRANK&CONROD ASSY (Ref # 12)     | 13031-049   | 1        |
| CONNECTING ROD SET (Ref # 13)    | 13044-034   | 3        |
| NEEDLE BEARING BG END (Ref # 14) | 13034-010   | 3        |
| CRANK PIN (Ref # 15)             | 13035-017   | 3        |
| WASHER SIDE (Ref # 16)           | 92026-024   | 6        |
| PIN DOWEL 5X12 (Ref # 17)        | 610A0512    | 2        |
| PINION OIL PUMP (Ref # 18)       | 16084-010   | 1        |
| NUT 18MM (Ref # 19)              | 92015-019   | 1        |
| OIL SEAL,Y325222.5 (Ref # 20)    | 92054-017   | 1        |
| SPACER (Ref # 21)                | 92026-066   | 2        |
| WASHER LOCK 6MM (Ref # 22)       | 463H0600    | 1        |
| BALL BEARING 6305N (Ref # 23)    | 92045-020   | 2        |
| WASHER LOCK (Ref # 24)           | 92024-021   | 1        |
| OIL SEAL,Y326219 (Ref # 25)      | 92054-018   | 1        |

## 1975 H1-F PARTS LIST

CRANKSHAFT/PISTONS ('69-72 H1/A/B/C)

| ITEM NAME                        | PART NUMBER | QUANTITY |
|----------------------------------|-------------|----------|
| BOLT OIL PUMP PINION (Ref # 26)  | 92001-060   | 1        |
| BEARING BALL #6305 (Ref # 27)    | 601B6305    | 2        |
| WOODRUFF KEY (Ref # 28)          | 510A5200    | 1        |
| COLLAR CRANK OIL SEAL (Ref # 29) | 92027-031   | 1        |
| "0" RING,22MM (Ref # 30)         | 92055-018   | 1        |
| OIL SEAL,TC326210 (Ref # 31)     | 92050-052   | 1        |
| PINION-PRIMARY (Ref # 32)        | 13121-013   | 1        |
| PINION DISTRIBUTOR (Ref # 33)    | 21146-001   | 1        |
| COLLAR (Ref # 33-1)              | 92027-091   | 1        |
| WASHER LOCK 18MM (Ref # 34)      | 92024-015   | 1        |