

1970 Mach III PARTS DIAGRAM

IGNITION/GENERATOR/REGULATOR (H1/A/C)

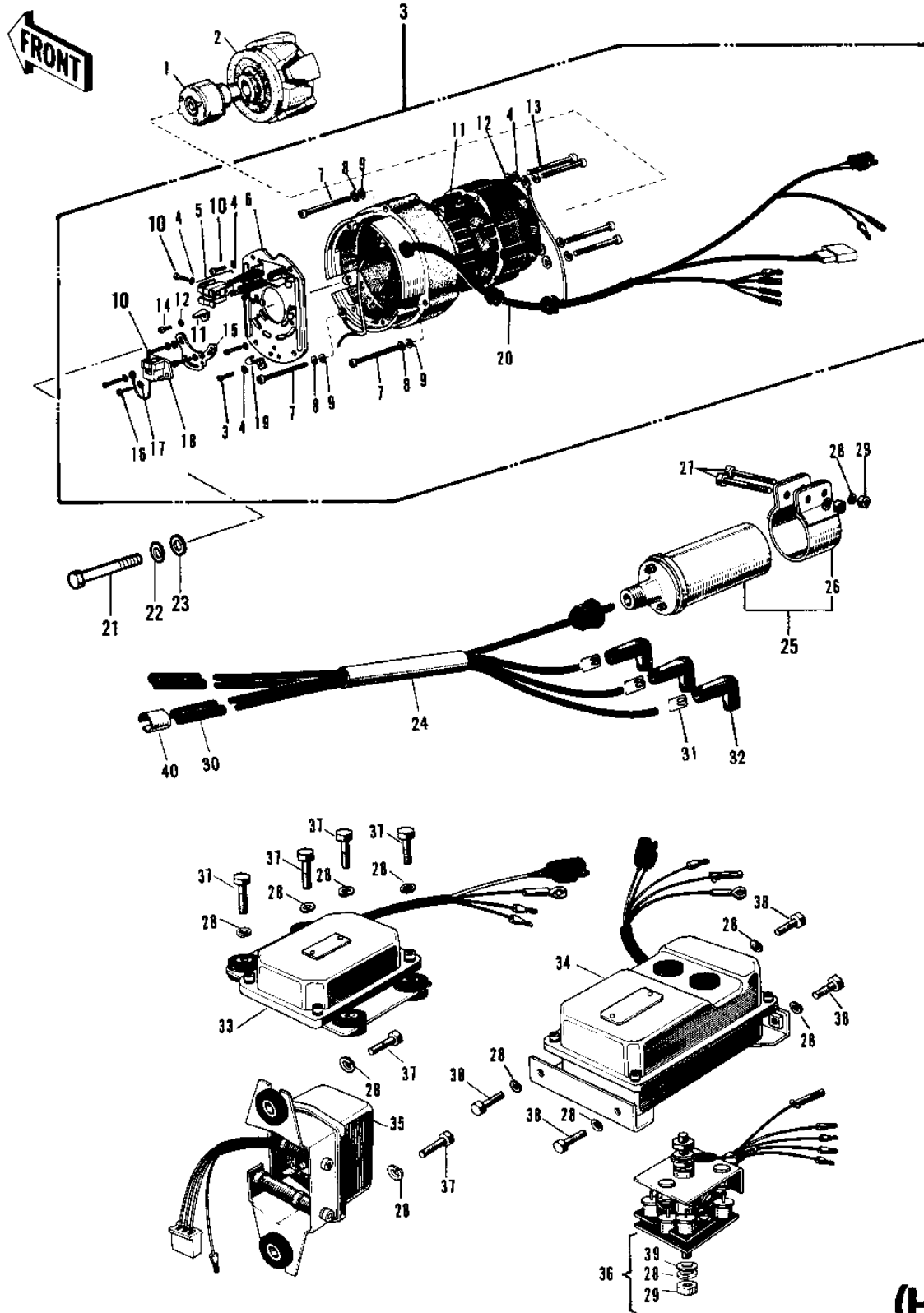

(H1/A)

1970 Mach III PARTS LIST

IGNITION/GENERATOR/REGULATOR (H1/A/C)

| ITEM NAME | PART NUMBER | QUANTITY |
|----------------------------------|-------------|----------|
| ROTOR S.G (Ref # 1) | 21007-011 | 1 |
| ROTOR (Ref # 2) | 21007-012 | 1 |
| YOKE ASSY (Ref # 3) | 21076-007 | 1 |
| WASHER SPRING 4MM (Ref # 4) | 461F0400 | 12 |
| BRUSH CARBON (Ref # 5) | 21088-009 | 1 |
| PLATE-YOKE (Ref # 6) | 21155-001 | 1 |
| SCREW (Ref # 7) | 220R0455 | 3 |
| WASHER SPRING 5MM (Ref # 8) | 461F0500 | 3 |
| WASHER PLAIN 5MM (Ref # 9) | 411B0500 | 3 |
| SCREW PAN HEAD 4X8 (Ref # 10) | 21085-004 | 8 |
| SCREW PAN HEAD 4X8 (Ref # 10) | 220B0408 | 8 |
| POINTER-IGN TIMING (Ref # 11) | 21020-020 | 1 |
| WASHER PLAIN 4MM (Ref # 12) | 410B0400 | 4 |
| SCREW PAN HEAD 4X25 (Ref # 13) | 220B0425 | 1 |
| SCREW PAN HEAD 4X6 (Ref # 14) | 220B0406 | 1 |
| PLATE-PICK UP (Ref # 15) | 21156-001 | 1 |
| SCREW-PAN-CROS (Ref # 16) | 220B0310 | 2 |
| WASHER SPRING 3MM (Ref # 17) | 461F0300 | 2 |
| PICK UP (Ref # 18) | 21152-002 | 1 |
| CLAMP-LEAD WIRE (Ref # 19) | 21098-007 | 2 |
| WIRING HARNESS (Ref # 20) | 21029-009 | 1 |
| BOLT HEX HEAD 8X73 (Ref # 21) | 110B0873 | 1 |
| WASHER SPRING 8MM (Ref # 22) | 461F0800 | 1 |
| WASHER PLAIN 8MM (Ref # 23) | 411B0800 | 1 |
| ONCORD ASY-HIGH TENSI (Ref # 24) | 21150-003 | 1 |
| COIL IGNITION (Ref # 25) | 21121-032 | 1 |
| BAND IGNITION COIL (Ref # 26) | 21126-003 | 1 |
| BOLT 6X35 (Ref # 27) | 110R0635 | 2 |
| WASHER SPRING 6MM (Ref # 28) | 461F0600 | 14 |

1970 Mach III PARTS LIST

IGNITION/GENERATOR/REGULATOR (H1/A/C)

| ITEM NAME | PART NUMBER | QUANTITY |
|----------------------------------|-------------|----------|
| NUT 6MM (Ref # 29) | 311B0600 | 4 |
| PROTECTOR-CORD (Ref # 30) | 92115-002 | 2 |
| SPRING-SPARK PLUG CAP (Ref # 31) | 92101-001 | 3 |
| CAP SPARK PLUG (Ref # 32) | 21130-009 | 3 |
| IGNITION UNIT A (Ref # 33) | 21119-006 | 1 |
| IGNITION UNIT B (Ref # 34) | 21120-004 | 1 |
| REGULATOR VOLTAGE (Ref # 35) | 21072-004 | 1 |
| RECTIFIER (Ref # 36) | 21061-008 | 1 |
| BOLT-UPSET (Ref # 37) | 112G0618 | 6 |
| BOLT-UPSET,6X12 (Ref # 38) | 112G0612 | 4 |
| WASHER PLAIN 6MM (Ref # 39) | 411B0600 | 2 |
| PROTECTOR CORD (Ref # 40) | 92114-002 | 1 |