

1974 H1-E PARTS DIAGRAM

OIL TANK ('69-'72 H1/A/B/C)

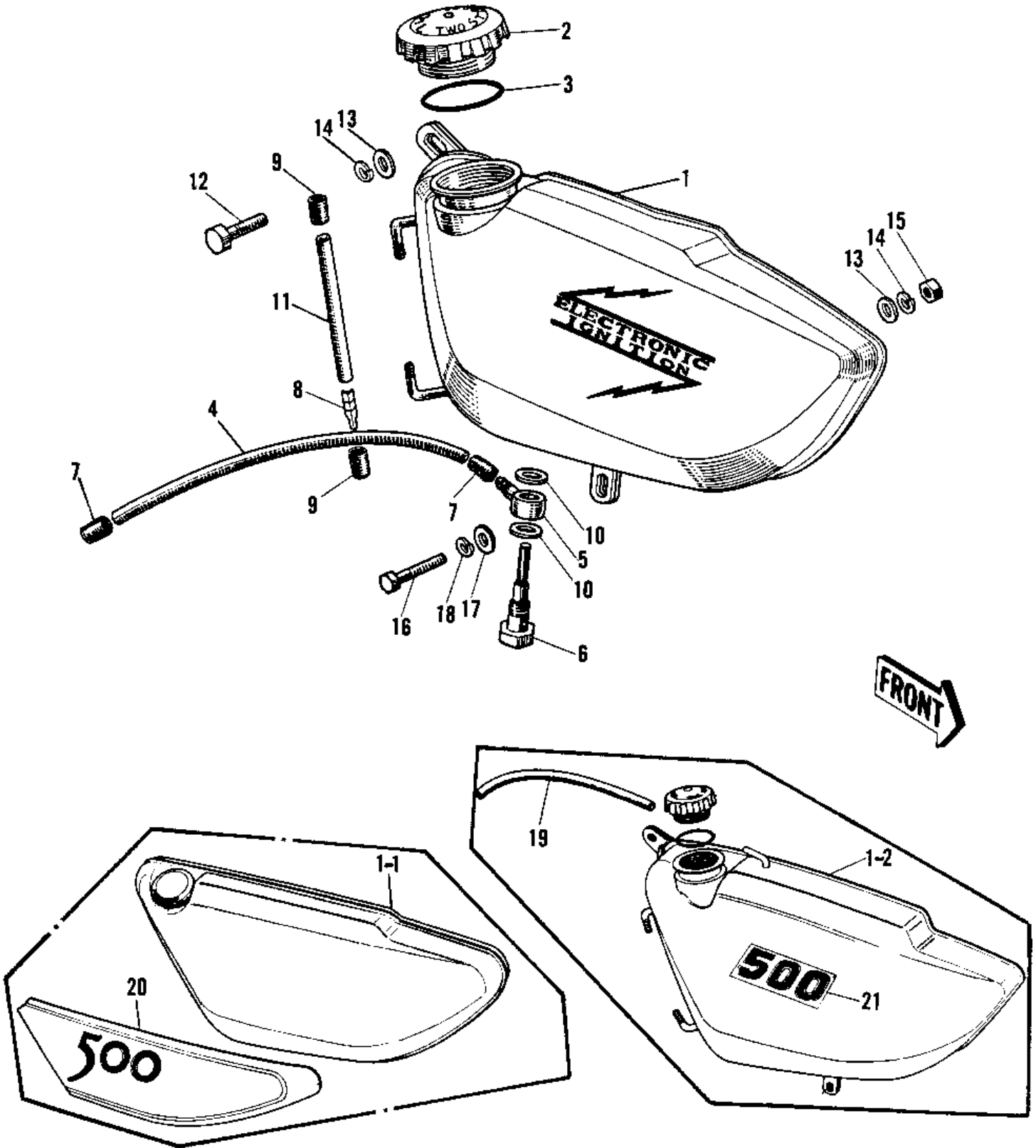

1974 H1-E PARTS LIST

OIL TANK ('69-'72 H1/A/B/C)

| ITEM NAME | PART NUMBER | QUANTITY |
|----------------------------------|--------------|----------|
| TANK OIL WHITE (Ref # 1) | 52001-015-19 | 1 |
| TANK-OIL,C.RED (Ref # 1) | 52001-028-24 | 1 |
| TANK-OIL,C.RED (Ref # 1) | 52001-028-24 | 1 |
| TANK-OIL,P.GRAY (Ref # 1) | 52001-028-47 | 1 |
| TANK-OIL,C.BLUE (Ref # 1-1) | 52001-015-58 | 1 |
| TANK-OIL,P.C.ORANGE (Ref # 1-2) | 52001-028-67 | 1 |
| CAP OIL TANK (Ref # 2) | 52003-009 | 1 |
| CAP OIL TANK (Ref # 2) | 52003-009 | 1 |
| "0" RING,36MM (Ref # 3) | 670B3036 | 1 |
| PIPE OIL TANK (Ref # 4) | 92059-021 | 1 |
| CONNECTOR BANJO (Ref # 5) | 92061-003 | 1 |
| BOLT OIL TANK BANJO (Ref # 6) | 92060-001 | 1 |
| SPRING PIPE CLAMP B (Ref # 7) | 92081-027 | 2 |
| GAUGE OIL LEVEL (Ref # 8) | 52005-004 | 1 |
| CLAMP OIL LEVEL PIPE (Ref # 9) | 92037-040 | 2 |
| GASKET,10,2X15X1.5T (Ref # 10) | 11009-1146 | 2 |
| GASKET,10,2X15X1.5T (Ref # 10) | 11009-1146 | 2 |
| TUBE-VINYL 6X95 (Ref # 11) | 700Q0695 | 2 |
| BOLT-SMALL-UPSET,8X18 (Ref # 12) | 115G0818 | 1 |
| WASHER PLAIN 8MM (Ref # 13) | 411B0800 | 2 |
| WASHER SPRING 8MM (Ref # 14) | 461F0800 | 2 |
| NUT,8MM (Ref # 15) | 311B0800 | 1 |
| BOLT-UPSET (Ref # 16) | 112G0660 | 1 |
| WASHER PLAIN 6MM (Ref # 17) | 411B0600 | 1 |
| WASHER SPRING 6MM (Ref # 18) | 461F0600 | 1 |
| TUBE-VINYL 5X470 (Ref # 19) | 700Q05470 | 1 |
| EMBLEM-OIL TANK (Ref # 20) | 56018-037 | 1 |
| EMBLEM-SIDE COVER (Ref # 21) | 56018-098 | 1 |