

1973 H1-D PARTS DIAGRAM

FRONT FORK ('73-'75 D/E/F & '76 A8)

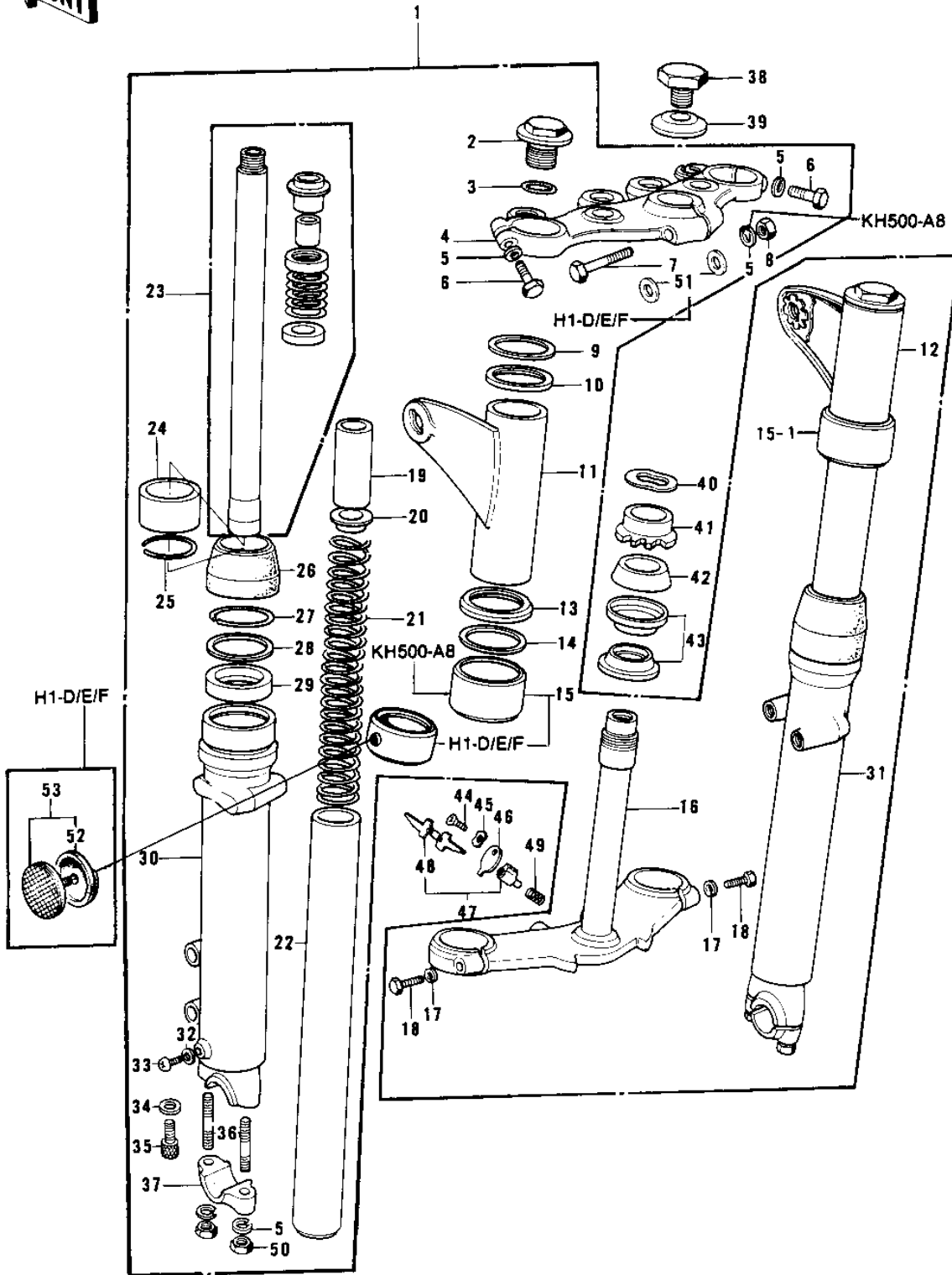

1973 H1-D PARTS LIST

FRONT FORK ('73-'75 D/E/F & '76 A8)

ITEM NAME	PART NUMBER	QUANTITY
FORK-FRONT (Ref # 1)	44001-131	1
FORK-FRONT (Ref # 1)	44001-131	1
FORK-FRONT (Ref # 1)	44001-176	1
BOLT-FORK TOP (Ref # 2)	44062-003	2
'O' RING FORK TOP (Ref # 3)	44046-015	2
HEAD,STEERING STEM (Ref # 4)	44039-048	1
WASHER SPRING 8MM (Ref # 5)	461F0800	6
WASHER SPRING 8MM (Ref # 5)	461F0800	7
BOLT,HEX HEAD,6MM (Ref # 6)	44041-049	2
BOLT-STEERING STEM HD (Ref # 7)	44041-042	1
NUT,LOCK,8MM (Ref # 8)	92015-1124	1
NUT,LOCK,8MM (Ref # 8)	92015-1124	1
NUT,LOCK,8MM (Ref # 8)	92017-013	1
GASKET,FORK COVER (Ref # 9)	44045-041	2
WASHER,FORK COVER (Ref # 10)	44043-048	2
COVER-L.H.FORK (Ref # 11)	44033-069	1
COVER-L.H.FORK (Ref # 11)	44033-069	1
COVER,L.H FORK (Ref # 11)	44033-068	1
COVER,R.H FORK (Ref # 12)	44034-069	1
COVER,R.H FORK (Ref # 12)	44034-069	1
COVER,R.H FORK (Ref # 12)	44034-068	1
WASHER-FORK COVER (Ref # 13)	44032-008	2
GASKET,FORK COVER (Ref # 14)	44045-040	2
GASKET,FORK COVER (Ref # 14)	44045-038	2
GUIDE,L.H FORK COVER (Ref # 15)	44064-014	1
GUIDE,FORK COVER (Ref # 15)	44064-025	1
GUIDE,R.H FORK COVER (Ref # 15-1)	44064-013	1
GUIDE,FORK COVER (Ref # 15-1)	44064-025	1
STEM,STEERING (Ref # 16)	44037-053	1

1973 H1-D PARTS LIST

FRONT FORK ('73-'75 D/E/F & '76 A8)

ITEM NAME	PART NUMBER	QUANTITY
STEM,STEERING (Ref # 16)	44037-096	1
WASHER SPRING 12MM (Ref # 17)	461F1200	2
BOLT-HEX HEAD,12X36 (Ref # 18)	92003-064	2
SPACER-FORK SPRING (Ref # 19)	44028-023	2
GUIDE-FORK SPRING (Ref # 20)	44029-019	2
SPRING-FORK (Ref # 21)	44026-031	2
TUBE-FORK INNER (Ref # 22)	44013-032	2
CYLINDER-FORK (Ref # 23)	44022-007	2
CYLINDER-FORK (Ref # 23)	44023-006	2
CYLINDER-FORK (Ref # 23)	44022-027	2
CYLINDER-FORK (Ref # 23)	44022-038	2
PISTON FORK (Ref # 24)	44018-003	2
PISTON,FORK (Ref # 24)	44018-009	2
CIRCLIP FORK PISTON (Ref # 25)	44044-008	2
CIRCLIP,FORK PISTON (Ref # 25)	44044-019	2
DUST SHIELD-FORK (Ref # 26)	44010-021	2
DUST SHEILD,FORK (Ref # 26)	44010-032	2
CIRCLIP-OIL SEAL FIT (Ref # 27)	44044-012	2
SEAL-OIL,FORK OUTER P (Ref # 29)	92049-1216	2
SEAL-OIL,FORK OUTER P (Ref # 29)	92049-1216	2
TUBE,LH,FORK OUTER (Ref # 30)	44005-041	1
TUBE,LH,FORK OUTER (Ref # 30)	44005-065	1
TUBE,RH,FORK OUTER (Ref # 31)	44006-039	1
TUBE,RH,FORK OUTER (Ref # 31)	44006-063	1
GASKET FORK DRAIN PLG (Ref # 32)	44045-002	2
SCREW PAN HEAD 4X8 (Ref # 33)	220B0408	2
GASKET,FORK CYLINDER (Ref # 34)	44045-057	2
BOLT-FORK CYLINDER (Ref # 35)	44041-040	2
STUD,8X35 (Ref # 36)	92004-1009	4

1973 H1-D PARTS LIST

FRONT FORK ('73-'75 D/E/F & '76 A8)

ITEM NAME	PART NUMBER	QUANTITY
HOLDER-FRONT AXLE (Ref # 37)	44063-003	2
HOLDER,FRONT AXLE (Ref # 37)	44063-014	2
BOLT,STEERG STEM HEAD (Ref # 38)	92007-031	1
WASHER,STEERG STM HD (Ref # 39)	92022-230	1
WASHER,WAVE (Ref # 40)	46100-003	1
NUT STEERING STEM LCK (Ref # 41)	92090-007	1
CAP, STEERING STEM (Ref # 42)	46098-016	1
CONE STRNG STEM BERNG (Ref # 43)	92047-006	2
SCREW-TAPPING (Ref # 44)	92008-007	1
WASHER (Ref # 45)	92097-003	1
CAP,STEERING LOCK (Ref # 46)	27031-002	1
CAP,STEERING LOCK (Ref # 46)	27031-004	1
LOCK ASSY-STEERING (Ref # 47)	27016-030	1
LOCK ASSY,STEERING (Ref # 47)	27016-038	1
KEY SET,#265 (Ref # 48)	27018-016-65	AR
KEY SET,#279 (Ref # 48)	27018-016-79	AR
KEY SET,#911 (Ref # 48)	27008-055-11	AR
KEY SET,#925 (Ref # 48)	27008-055-25	AR
SPRING-STEERING LOCK (Ref # 49)	27032-001	1
NUT,8MM (Ref # 50)	311B0800	4
NUT,LOCK,8MM (Ref # 50)	92017-013	4
WASHER PLAIN 8MM (Ref # 51)	410B0800	2
DAMPER RUBBER-REFLEX (Ref # 52)	28016-002	2
REFLECTOR,REFLEX,FRNT (Ref # 53)	28001-029	2