

# 1969 Mach III PARTS DIAGRAM

FENDERS (73-'75 D/E/F & '76 A8)

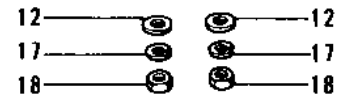
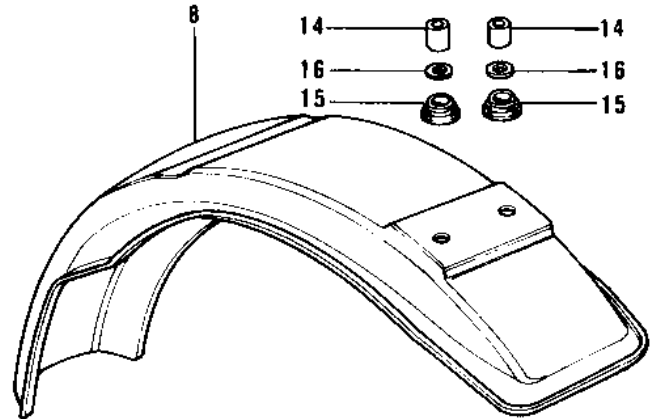
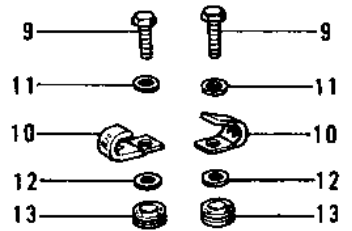
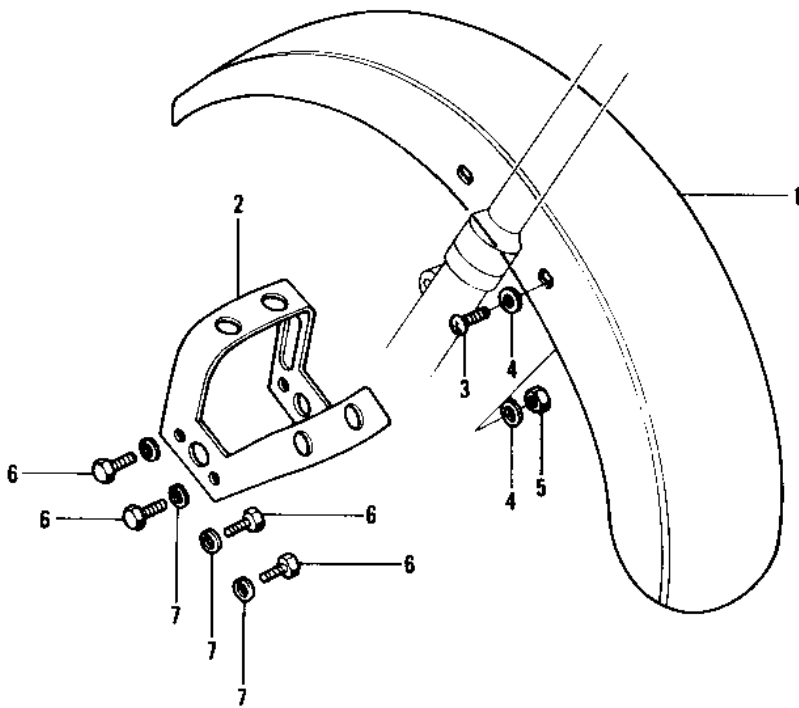

10

# 1969 Mach III PARTS LIST

FENDERS ('73-'75 D/E/F & '76 A8)

| ITEM NAME                        | PART NUMBER | QUANTITY |
|----------------------------------|-------------|----------|
| FENDER-FR (Ref # 1)              | 35004-076   | 1        |
| FENDER-FR (Ref # 1)              | 35004-085   | 1        |
| BRACE-FRONT FENDER (Ref # 2)     | 35009-025   | 1        |
| BRACE,FRONT FENDER (Ref # 2)     | 35009-029   | 1        |
| SCREW PAN HEAD 6X14 (Ref # 3)    | 220E0614    | 4        |
| WASHER PLAIN 6MM (Ref # 4)       | 411B0600    | 8        |
| NUT (Ref # 5)                    | 92019-008   | 4        |
| BOLT-SMALL-UPSET,8X16 (Ref # 6)  | 115G0816    | 4        |
| WASHER SPRING 8MM (Ref # 7)      | 461F0800    | 4        |
| FENDER-RR (Ref # 8)              | 35022-076   | 1        |
| BOLT-HEX HEAD,6X32 (Ref # 9)     | 110N0632    | 2        |
| CLAMP,HARNESS (Ref # 10)         | 92037-113   | 2        |
| WASHER PLAIN 6MM (Ref # 11)      | 411B0600    | 2        |
| WASHER,PLAIN,7MM (Ref # 12)      | 92022-228   | 2        |
| DAMPER RUBBER,RR FEND (Ref # 13) | 92075-121   | 2        |
| COLLAR,REAR FENDER (Ref # 14)    | 92027-162   | 2        |
| DAMPER RUBBER,RR FEND (Ref # 15) | 92075-133   | 2        |
| WASHER,PLAIN,7MM (Ref # 16)      | 92022-227   | 2        |
| WASHER SPRING 6MM (Ref # 17)     | 461F0600    | 2        |
| NUT 6MM (Ref # 18)               | 311B0600    | 2        |