

1969 Mach III PARTS DIAGRAM

HEADLIGHT (H1-D/E/F)

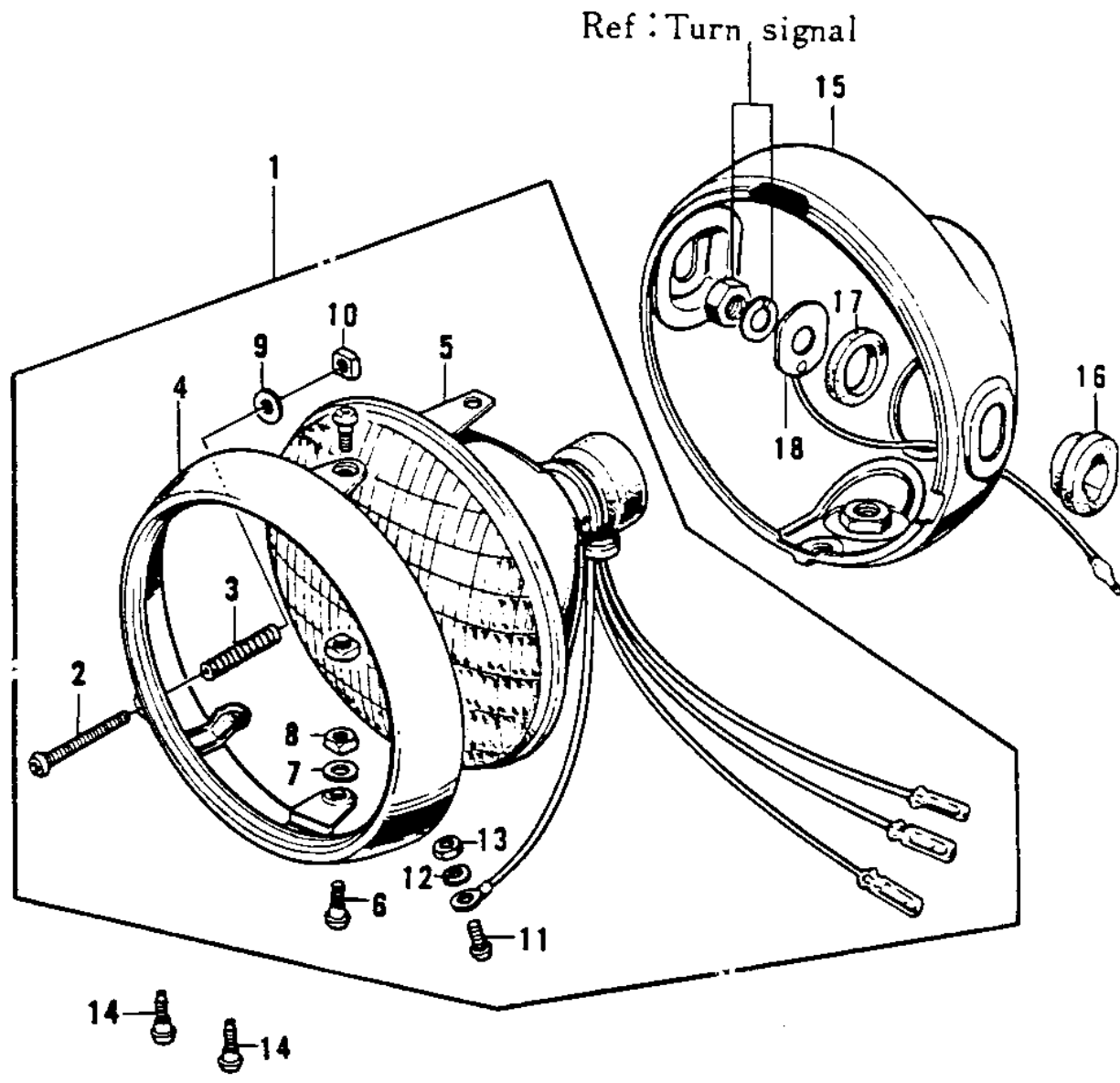

FRONT ←

(H1-D/

1969 Mach III PARTS LIST

HEADLIGHT (H1-D/E/F)

| ITEM NAME | PART NUMBER | QUANTITY |
|---------------------------------|--------------|----------|
| LAMP UNIT-HEAD (Ref # 1) | 23003-018 | 1 |
| SCREW FORCUS ADJUST (Ref # 2) | 23019-021 | 1 |
| SPRING FOCUS ADJUST (Ref # 3) | 23014-005 | 1 |
| RIM-HEAD LAMP (Ref # 4) | 23006-034 | 1 |
| SEALED BEAM UNIT (Ref # 5) | 23007-043 | 1 |
| SCREW-PAN HEAD,5X12 (Ref # 6) | 23019-023 | 2 |
| WASHER-PLAIN,5MM (Ref # 7) | 23021-012 | 2 |
| NUT,HEAD LAMP RIM FIT (Ref # 8) | 23020-023 | 2 |
| WASHER (Ref # 9) | 23021-004 | 1 |
| NUT,4MM (Ref # 10) | 23020-018 | 1 |
| SCREW-PAN-HEAD 3X6 (Ref # 11) | 220B0306 | 1 |
| WASHER SPRING 3MM (Ref # 12) | 461F0300 | 1 |
| NUT-HEX (Ref # 13) | 311B0300 | 1 |
| SCREW,PAN HEAD,5X14 (Ref # 14) | 23019-022 | 1 |
| BODY-HEAD.LAMP,BLACK (Ref # 15) | 23005-038-21 | 1 |
| DAMPER RUBBER A (Ref # 16) | 23066-001 | 2 |
| DAMPER RUBBER (Ref # 17) | 23066-005 | 2 |
| COLLAR (Ref # 18) | 23076-005 | 2 |