

1968 Roadrunner PARTS DIAGRAM

ENGINE COVERS

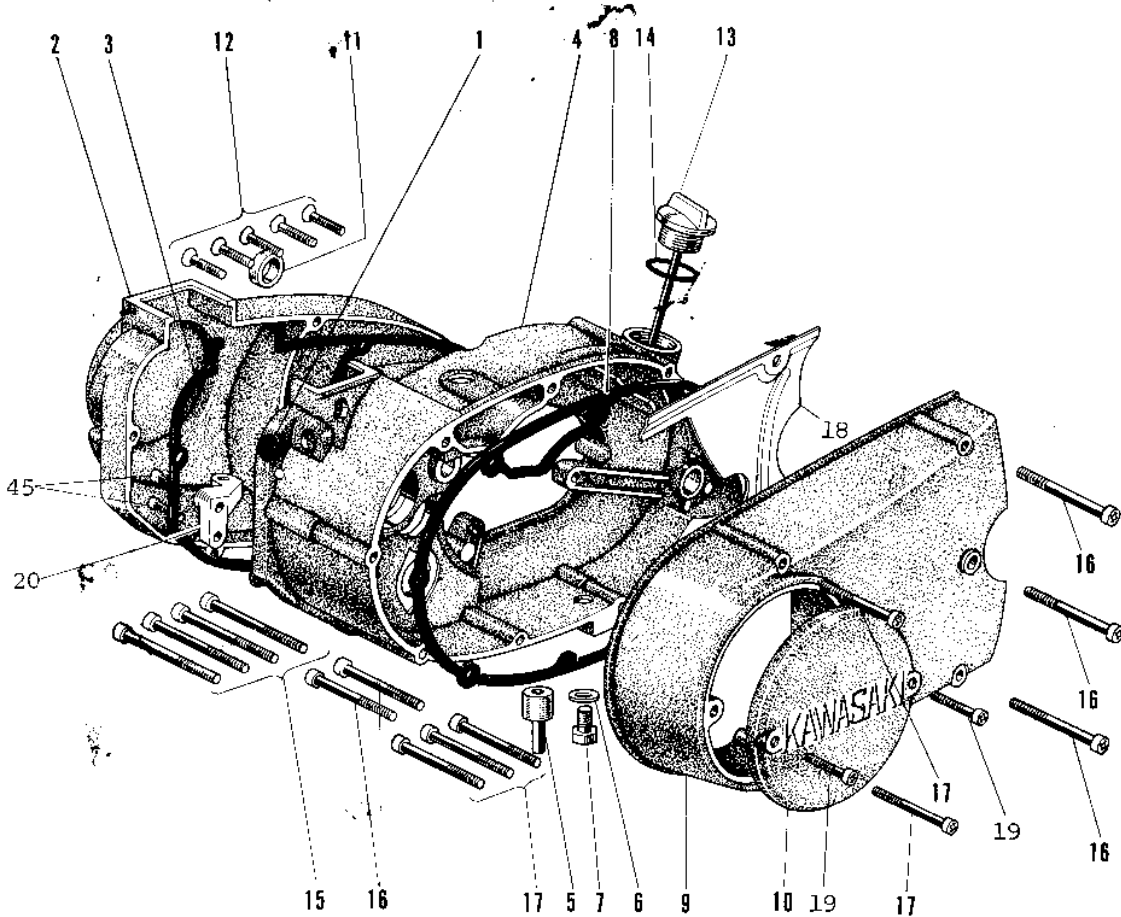

FRONT

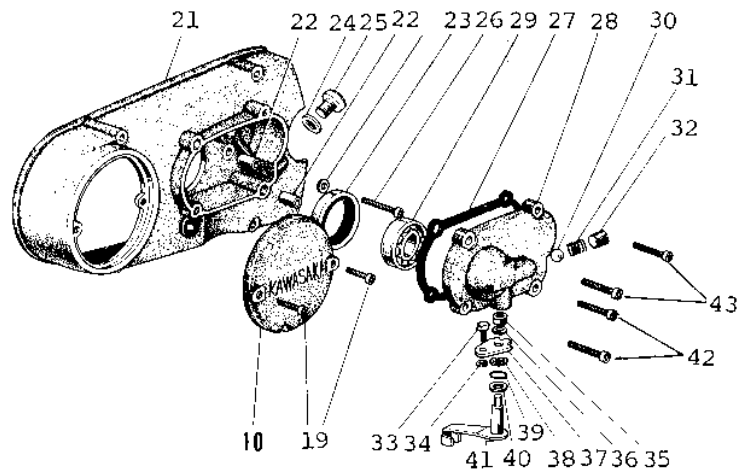
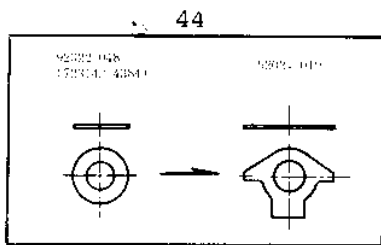
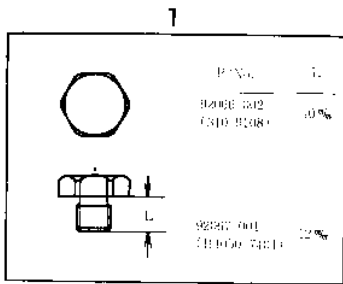

1968 Roadrunner PARTS LIST

ENGINE COVERS

ITEM NAME	PART NUMBER	QUANTITY
CAP CARB MOUNT HOLE (Ref # 1)	14039-001	1
COVER CARBURETOR (Ref # 2)	14030-002	1
GASKET CARBURETOR COV (Ref # 3)	14047-002	1
COVER R.H ENGINE (Ref # 4)	14032-012	1
PIPE FUEL OVERFLOW (Ref # 5)	16116-001	1
GASKET CHECK VALVE (Ref # 6)	92065-058	1
PLUG OIL DRAIN (Ref # 7)	92067-001	1
GASKET R.H ENGINE COV (Ref # 8)	14046-004	1
COVER L.H ENGINE (Ref # 9)	14031-005	1
COVER BREAKER POINT (Ref # 10)	14027-003	1
OIL SEAL SB16244 (Ref # 11)	92049-002	1
SCREW OVL CNTSNK 6X30 (Ref # 12)	222B0630	5
PLUG OIL FILLER (Ref # 13)	16115-002	1
"0" RING,20MM (Ref # 14)	670B2020	1
SCREW PAN HEAD 6X65 (Ref # 15)	220B0665	4
SCREW PAN HEAD 6X55 (Ref # 16)	220B0655	5
SCREW PAN HEAD 6X45 (Ref # 17)	220B0645	5
COVER DRV CHAIN BACK (Ref # 18)	14024-001	1
SCREW OVL CNTSNK 6X20 (Ref # 19)	222B0620	2
GUIDE OIL PUMP CABLE (Ref # 20)	14044-001	1
COVER L.H ENGINE (Ref # 21)	14031-034	
PIN,DOWEL,6.5X10X12 (Ref # 22)	552B1012	
OIL SEAL SC38556 (Ref # 23)	92050-012	
GASKET CHECK VALVE (Ref # 24)	92065-058	
UNAVAILABLE IN PRICE BOOK (Ref # 25)	16115-004	
SCREW PAN HEAD 6X40 (Ref # 26)	220B0640	
GASKET LH ENG COV CAP (Ref # 27)	14051-001	
CAP ASSY L.H ENG COV (Ref # 28~41)	14075-002	
BEARING BALL #6005 (Ref # 29)	601B6005	

1968 Roadrunner PARTS LIST

ENGINE COVERS

ITEM NAME	PART NUMBER	QUANTITY
BALL STEEL 1/4' (Ref # 30)	600A0800	
SPRING (Ref # 31)	92081-075	
PLUG L.H ENG COV CAP (Ref # 32)	92066-015	
RETAINER SHIFT ROD (Ref # 33)	13197-001	
CIRCLIP SELD BEM FIT (Ref # 34)	482K4000	
NUT 6MM (Ref # 35)	312B0600	
WASHER SPRING 6MM (Ref # 36)	461F0600	
LEVER A (Ref # 37)	13204-002	
WASHER WAVE (Ref # 38)	13211-001	
"O" RING,8MM (Ref # 39)	670B1508	
WASHER PLAIN 8MM (Ref # 40)	410B0800	
LEVER SHIFT (Ref # 41)	13234-001	
SCREW PAN HEAD 6X25 (Ref # 42)	220B0625	
SCREW PAN HEAD 6X35 (Ref # 43)	220B0635	
WASHER LOCK 6MM (Ref # 44)	92024-019	
SCREW PAN HEAD 6X20 (Ref # 45)	220B0620	2