

1980 KE175 PARTS DIAGRAM

TRANSMISSION ('80-'81 KE175-D2/D3)

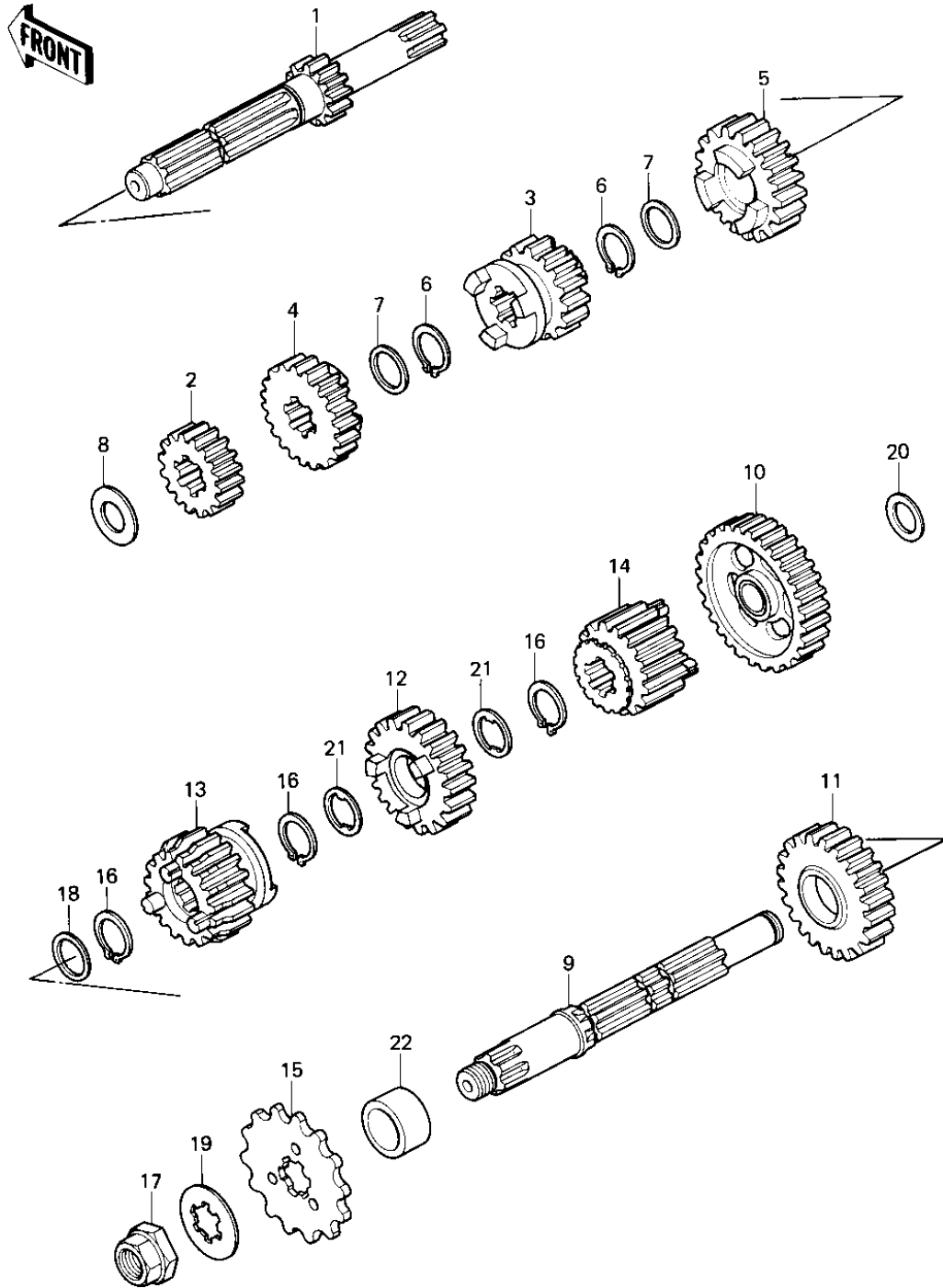

1980 KE175 PARTS LIST

TRANSMISSION ('80-'81 KE175-D2/D3)

ITEM NAME	PART NUMBER	QUANTITY
SHAFT,DRIVE,12T (Ref # 1)	13127-1006	1
2ND GEAR,DRIVE,17T (Ref # 2)	13129-1075	1
3RD GEAR,DRIVE,18T (Ref # 3)	13129-1212	1
3RD GEAR,DRIVE,18T (Ref # 3)	13129-1212	1
4TH GEAR,DRIVE,20T (Ref # 4)	13129-1143	1
TOP GEAR,DRIVE,25T (Ref # 5)	13129-1145	1
CIRCLIP,21MM (Ref # 6)	480J2100	2
WASHER 22MM (Ref # 7)	92022-106	2
WASHER-THRUST (Ref # 8)	92022-170	1
SHAFT,OUTPUT (Ref # 9)	13128-1008	1
LOW GEAR,OUTPUT SHAFT (Ref # 10)	13129-051	1
2ND GEAR OUTPUT 28T (Ref # 11)	13129-1278	1
3RD GEAR,DRIVEN,22T (Ref # 12)	13129-1142	1
4TH GEAR,DRIVEN,19T (Ref # 13)	13129-1144	1
TOP GEAR,DRIVEN,20T (Ref # 14)	13129-1134	1
SPROCKET-OUTPUT,14T (Ref # 15)	13144-1058	1
CIRCLIP,21MM (Ref # 16)	480J2100	3
NUT,14M/M (Ref # 17)	92015-1062	1
UNAVAILABLE IN PRICE BOOK (Ref # 18)	920022-1087	1
WASHER,SPLINE (Ref # 19)	92022-1113	1
WASHER-THRUST (Ref # 20)	92022-170	1
WASHER-LOCK (Ref # 21)	92024-031	2
COLLAR,20X30X15 (Ref # 22)	92027-1083	1