

1981 KE175 PARTS DIAGRAM

TRANSMISSION ('80-'81 KE175-D2/D3)

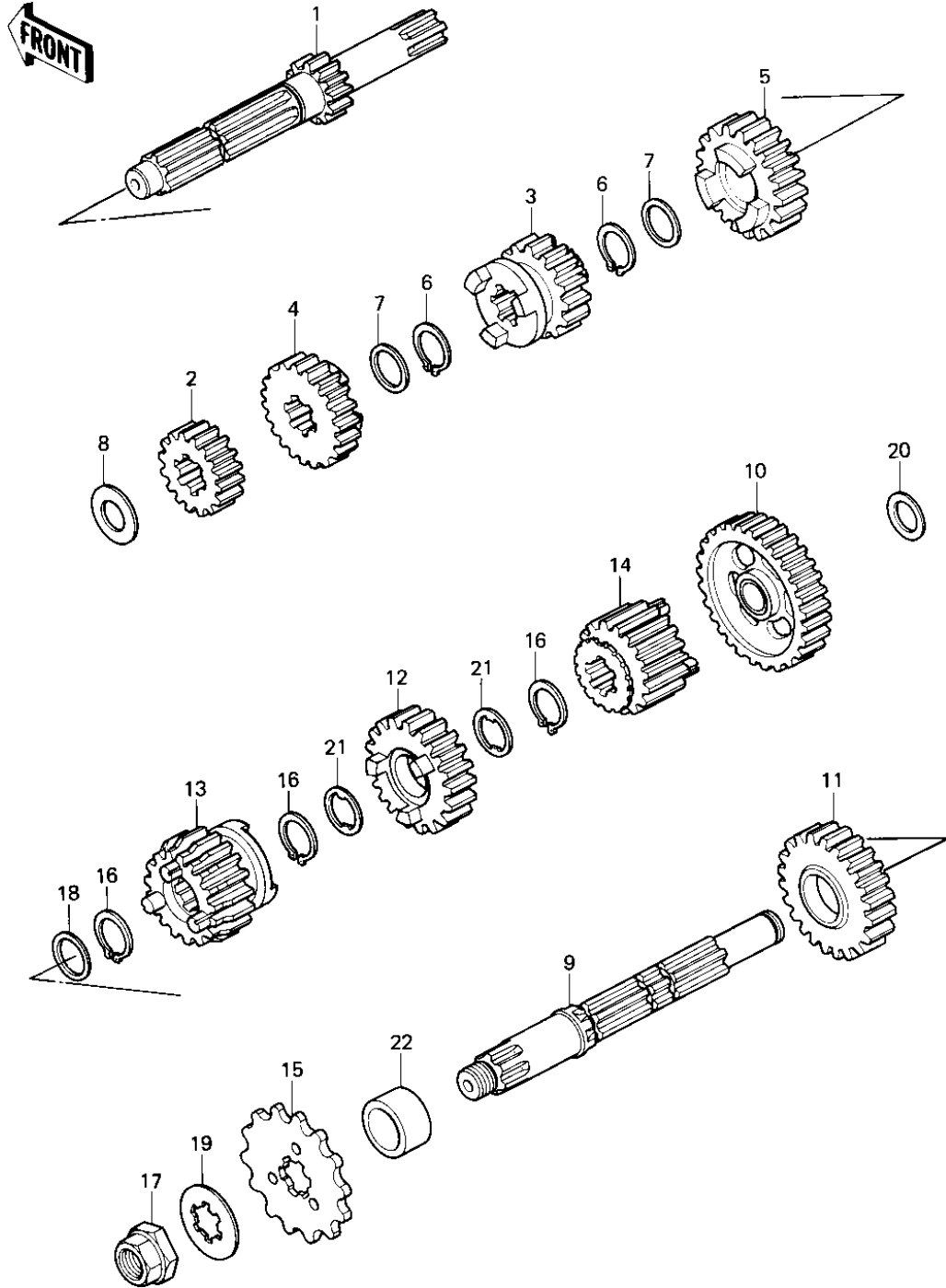

1981 KE175 PARTS LIST

TRANSMISSION ('80-'81 KE175-D2/D3)

| ITEM NAME | PART NUMBER | QUANTITY |
|--------------------------------------|-------------|----------|
| SHAFT,DRIVE,12T (Ref # 1) | 13127-1006 | 1 |
| 2ND GEAR,DRIVE,17T (Ref # 2) | 13129-1075 | 1 |
| 3RD GEAR,DRIVE,18T (Ref # 3) | 13129-1212 | 1 |
| 3RD GEAR,DRIVE,18T (Ref # 3) | 13129-1212 | 1 |
| 4TH GEAR,DRIVE,20T (Ref # 4) | 13129-1143 | 1 |
| TOP GEAR,DRIVE,25T (Ref # 5) | 13129-1145 | 1 |
| CIRCLIP,21MM (Ref # 6) | 480J2100 | 2 |
| WASHER 22MM (Ref # 7) | 92022-106 | 2 |
| WASHER-THRUST (Ref # 8) | 92022-170 | 1 |
| SHAFT,OUTPUT (Ref # 9) | 13128-1008 | 1 |
| LOW GEAR,OUTPUT SHAFT (Ref # 10) | 13129-051 | 1 |
| 2ND GEAR OUTPUT 28T (Ref # 11) | 13129-1278 | 1 |
| 3RD GEAR,DRIVEN,22T (Ref # 12) | 13129-1142 | 1 |
| 4TH GEAR,DRIVEN,19T (Ref # 13) | 13129-1144 | 1 |
| TOP GEAR,DRIVEN,20T (Ref # 14) | 13129-1134 | 1 |
| SPROCKET-OUTPUT,14T (Ref # 15) | 13144-1058 | 1 |
| CIRCLIP,21MM (Ref # 16) | 480J2100 | 3 |
| NUT,14M/M (Ref # 17) | 92015-1062 | 1 |
| UNAVAILABLE IN PRICE BOOK (Ref # 18) | 920022-1087 | 1 |
| WASHER,SPLINE (Ref # 19) | 92022-1113 | 1 |
| WASHER-THRUST (Ref # 20) | 92022-170 | 1 |
| WASHER-LOCK (Ref # 21) | 92024-031 | 2 |
| COLLAR,20X30X15 (Ref # 22) | 92027-1083 | 1 |