

# 1980 KE175 PARTS DIAGRAM

ENGINE COVERS ('80-'81 KE175-D2/D3)

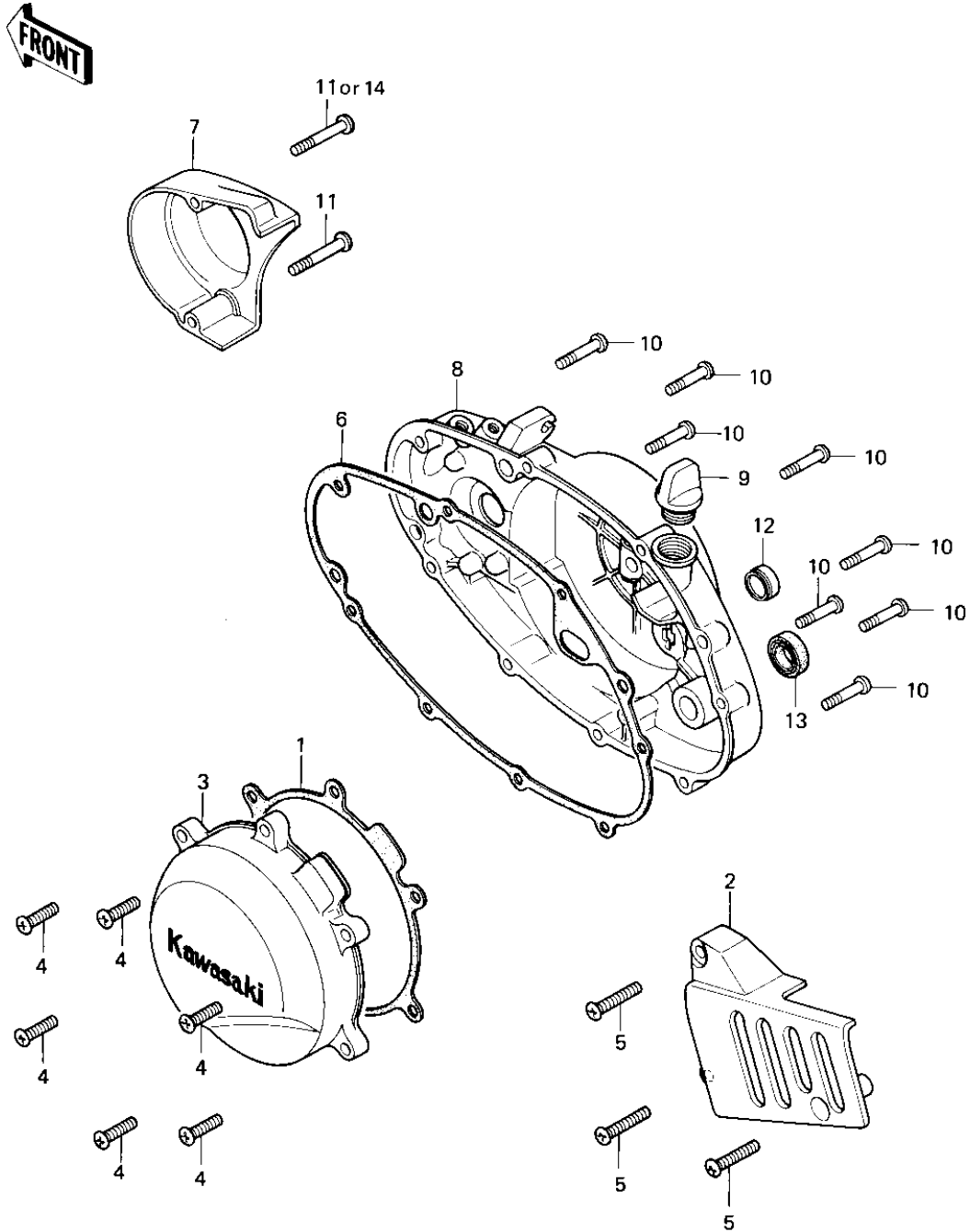

## 1980 KE175 PARTS LIST

ENGINE COVERS ('80-'81 KE175-D2/D3)

ITEM NAME	PART NUMBER	QUANTITY
GASKET,MAGNETO COVER (Ref # 1)	11009-1063	1
COVER-CHAIN,F.BLACK (Ref # 2)	14026-1067	1
COVER,MAGNETO (Ref # 3)	14031-1016	1
SCREW PAN HEAD 6X25 (Ref # 4)	220B0625	6
SCREW PAN HEAD 6X35 (Ref # 5)	220B0635	3
GASKET,CLUTCH COVER (Ref # 6)	11009-1062	1
COVER,OIL PUMP (Ref # 7)	14030-1010	1
COVER,CLUTCH (Ref # 8)	14032-1007	1
FILLER,OIL (Ref # 9)	16115-018	1
SCREW PAN HEAD 6X30 (Ref # 10)	220B0630	8
SCREW PAN HEAD 6X40 (Ref # 11)	220B0640	1
GAUGE,OIL LEVEL (Ref # 12)	52005-1005	1
OIL SEAL TB16267 (Ref # 13)	92051-003	1
SCREW PAN HEAD 6X50 (Ref # 14)	220B0650	1