

# 1983 KE175 PARTS DIAGRAM

CLUTCH ('82-'83 KE175-D4/D5)

E1350-0006

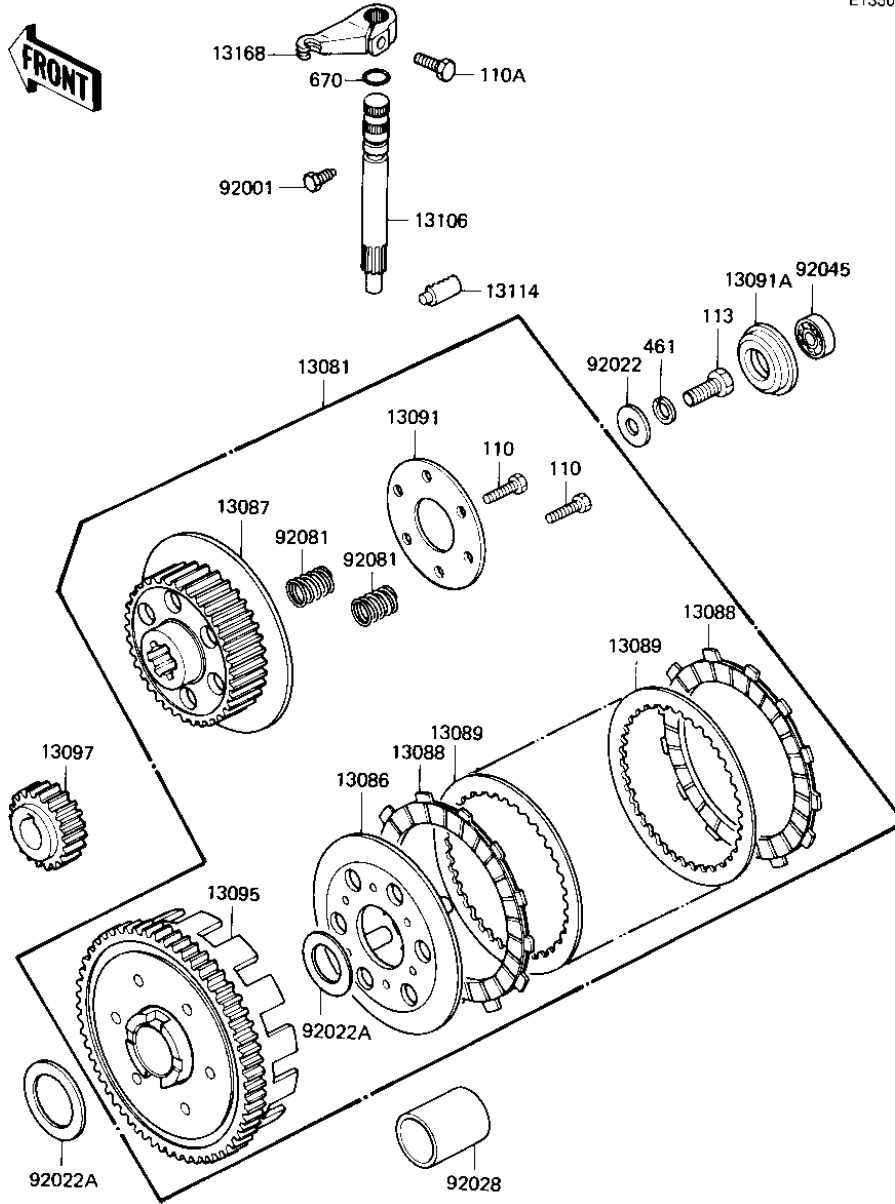

# 1983 KE175 PARTS LIST

CLUTCH ('82-'83 KE175-D4/D5)

ITEM NAME	PART NUMBER	QUANTITY
CLUTCH-ASSY (Ref # 13081)	13081-1050	1
WHEEL,CLUTCH (Ref # 13086)	13086-017	1
HUB,CLUTCH (Ref # 13087)	13087-041	1
PLATE-FRICTION (Ref # 13088)	13088-1015	5
PLATE CLUTCH STEEL (Ref # 13089)	13089-003	4
HOLDER,CLUTCH SPRING (Ref # 13091)	13091-1017	1
HOLDER,CLUTCH PUSHER (Ref # 13091A)	13091-1136	1
HOUSING-COMP-CLUTCH (Ref # 13095)	13095-1024	1
GEAR,PRIMARY,24T (Ref # 13097)	13097-1006	1
SHAFT,CLUTCH RELEASE (Ref # 13106)	13106-1002	1
PUSHER-CLUTCH (Ref # 13114)	13114-1009	1
LEVER,CLUTCH RELEASE (Ref # 13168)	13168-1023	1
BOLT,CLUTCH RELEASE (Ref # 92001)	92003-130	1
WASHER,10.2X28X2 (Ref # 92022)	92022-1088	1
WASHER-CLUTCH THRUST (Ref # 92022A)	92022-168	2
BUSH-CLUTCH (Ref # 92028)	92028-014	1
BEARING,BALL #627 (Ref # 92045)	92045-026	1
SPRING,CLUTCH (Ref # 92081)	92081-1174	6
BOLT (Ref # 110)	110G0520	6
BOLT-UPSET (Ref # 110A)	112G0618	1
BOLT,HEX HEAD,10X22 (Ref # 113)	113G1022	1
WASHER SPRING 10MM (Ref # 461)	461F1000	1
"O" RING,9MM (Ref # 670)	670B1509	1