

1983 KE175 PARTS DIAGRAM

CARBURETOR ('82-'83 KE175-D4/D5)

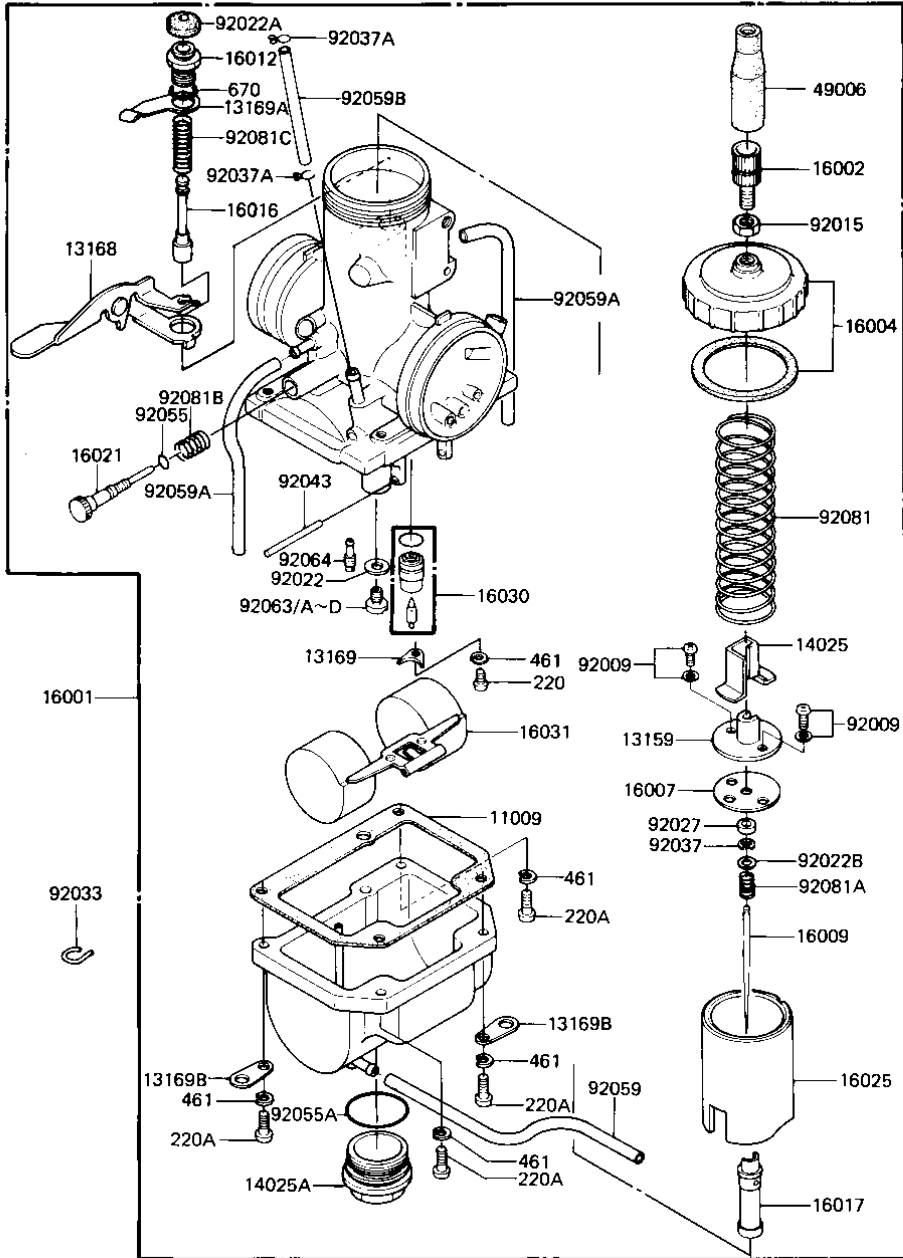

E1610-0022



1983 KE175 PARTS LIST

CARBURETOR ('82-'83 KE175-D4/D5)

ITEM NAME	PART NUMBER	QUANTITY
GASKET,FLOAT CHAMBER (Ref # 11009)	11009-1178	1
CONNECTOR,THROTTLE (Ref # 13159)	13159-1010	1
LEVER,STARTER PLUNGER (Ref # 13168)	16063-004	1
PLATE, LOCK (Ref # 13169)	13169-1190	1
SPRING PLATE,STARTER (Ref # 13169A)	13169-1224	1
PLATE,TUBE CLAMP (Ref # 13169B)	13169-1226	2
COVER,THROTTLE VALVE (Ref # 14025)	14025-1197	1
COVER,FLOAT CHAMBER (Ref # 14025A)	14025-1198	1
CARBURETOR (Ref # 16001)	16001-1266	1
ADJUSTER,CABLE (Ref # 16002)	16002-014	1
CAP-MIXING CHAMBER (Ref # 16004)	16004-018	1
PLATE,THROTTLE VALVE (Ref # 16007)	16007-1011	1
JET NEEDLE, 5CT34 (Ref # 16009)	16009-1053	1
CAP,STARTER PLUNGER (Ref # 16012)	16012-019	1
PLUNGER,STARTER (Ref # 16016)	16016-1011	1
NEEDLE JET.0-6 (Ref # 16017)	16017-1050	1
SCREW,THROTTLE ADJST (Ref # 16021)	16021-1012	1
VALVE,THROTTLE CA2.0 (Ref # 16025)	16025-1043	1
VALVE ASSY,FLOAT (Ref # 16030)	16030-1011	1
FLOAT (Ref # 16031)	16031-1011	1
BOOT,CARBURETOR (Ref # 49006)	49006-1169	1
SCREW,PAN HEAD,3X14 (Ref # 92009)	16033-031	2
NUT-CABLE ADJUST LOCK (Ref # 92015)	16003-006	1
WASHER MAIN JET (Ref # 92022)	16034-001	1
CAP,STARTER PLUNGER (Ref # 92022A)	16039-015	1
WASHER,THROTTLE VALVE (Ref # 92022B)	92022-1024	1
RING,JET NEEDLE (Ref # 92027)	92027-1103	1
CIRCLIP (Ref # 92033)	92036-018	1
CIRCLIP (Ref # 92037)	16008-010	1

1983 KE175 PARTS LIST

CARBURETOR ('82-'83 KE175-D4/D5)

ITEM NAME	PART NUMBER	QUANTITY
CLAMP-PIPE (Ref # 92037A)	92037-072	2
FLOAT PIN (Ref # 92043)	16032-003	1
"O" RING (Ref # 92055)	92055-044	1
"O" RING,PILOT SCREW (Ref # 92055A)	92055-1078	1
TUBE,SWITH VALVE,CLNR (Ref # 92059)	92059-1078	1
TUBE,3X5X100 (Ref # 92059A)	92059-1116	2
PIPE,FUEL (Ref # 92059B)	92059-130	1
MAIN JET,#A97.5R (Ref # 92063)	92063-1035	1
MAIN JET,#A100 (Ref # 92063A)	92063-1033	1
MAIN JET,#A105R (Ref # 92063B)	92063-1042	1
JET-MAIN NO 107.5R (Ref # 92063C)	92063-073	1
MAIN JET,#A102.5 (Ref # 92063D)	92063-1028	1
PILOT JET,#22.5 (Ref # 92064)	92064-1026	1
SPRING,THROTTLE VALV (Ref # 92081)	16006-023	1
SPRING,JET NEEDLE (Ref # 92081A)	92081-1072	1
SPRING,THROTTLE ADJST (Ref # 92081B)	92081-1152	1
SPRING,STRTR PLUNGER (Ref # 92081C)	92081-1181	1
SCREW PAN HEAD 4X8 (Ref # 220)	220B0408	1
SCREW PAN HEAD 4X16 (Ref # 220A)	220B0416	4
WASHER SPRING 4MM (Ref # 461)	461F0400	5
"O" RING,9MM (Ref # 670)	670B1509	1