

1983 KE175 PARTS DIAGRAM

BRAKE PEDAL/TORQUE LINK ('82-'83 KE175-D)

F2260-0045

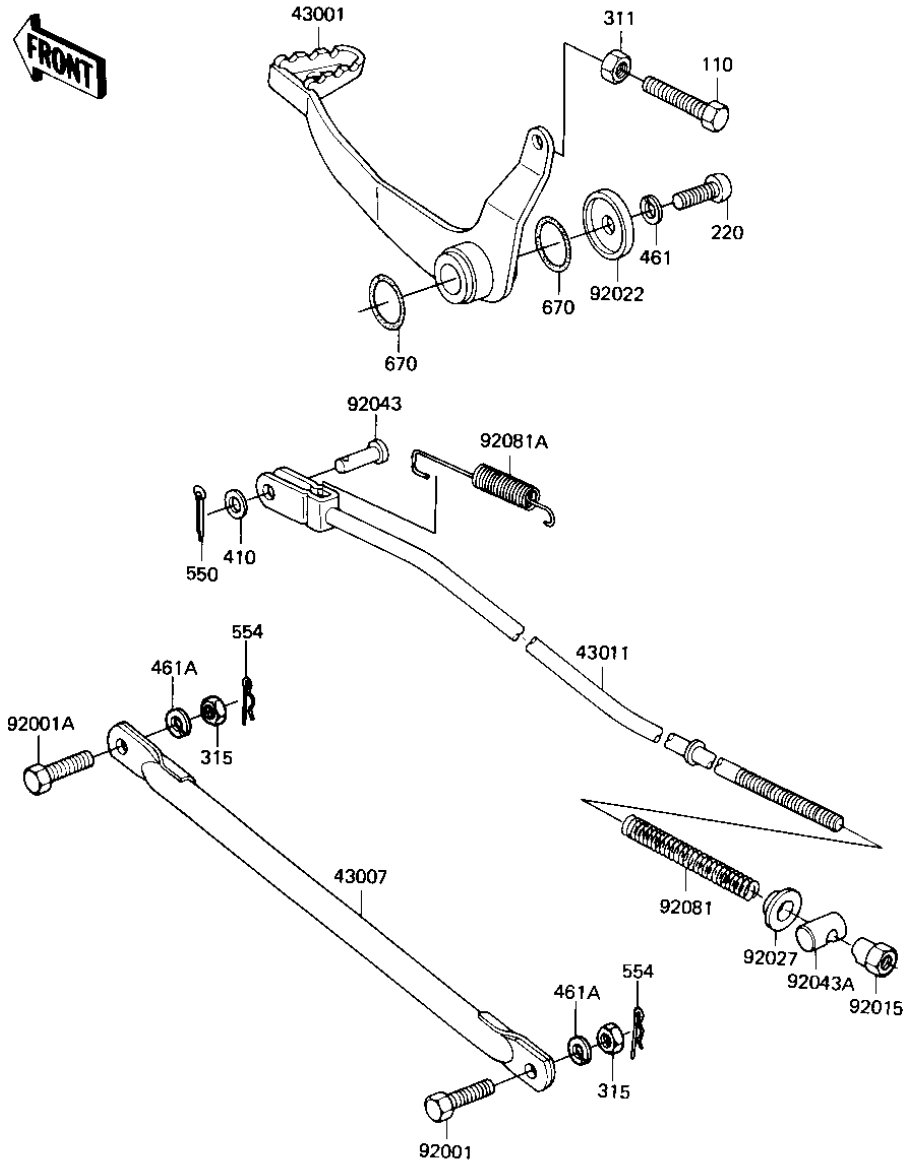

1983 KE175 PARTS LIST

BRAKE PEDAL/TORQUE LINK ('82-'83 KE175-D)

| ITEM NAME | PART NUMBER | QUANTITY |
|-------------------------------------|-------------|----------|
| PEDAL,BRAKE (Ref # 43001) | 43001-1020 | 1 |
| TORQUE LINK,REAR BRAK (Ref # 43007) | 43007-048 | 1 |
| ROD,BRAKE (Ref # 43011) | 43011-1009 | 1 |
| BOLT HEX HEAD 10X25 (Ref # 92001) | 92003-003 | 1 |
| BOLT TORQUE LINK FIT (Ref # 92001A) | 92003-017 | 1 |
| NUT-BRAKE ROD ADJUST (Ref # 92015) | 92015-042 | 1 |
| WASHER,PLAIN,6MM (Ref # 92022) | 92022-284 | 1 |
| COLLAR (Ref # 92027) | 92027-122 | 1 |
| PIN-BRAKE ROD FITTING (Ref # 92043) | 92043-064 | 1 |
| PIN-BRAKE ROD (Ref # 92043A) | 92043-065 | 1 |
| SPRING,BRAKE ROD (Ref # 92081) | 43012-001 | 1 |
| SPRING,BRAKE PEDAL (Ref # 92081A) | 92081-1071 | 1 |
| BOLT-UPSET,6X20 (Ref # 110) | 112G0620 | 1 |
| SCREW PAN HEAD 6X12 (Ref # 220) | 220B0612 | 1 |
| NUT 6MM (Ref # 311) | 311B0600 | 1 |
| NUT 10MM (Ref # 315) | 315B1000 | 2 |
| WASHER PLAIN 6MM (Ref # 410) | 410B0600 | 1 |
| WASHER SPRING 6MM (Ref # 461) | 461F0600 | 1 |
| WASHER SPRING 10MM (Ref # 461A) | 461F1000 | 2 |
| PIN COTTER 2.0X15 (Ref # 550) | 550D2015 | 1 |
| PIN,SNAP (Ref # 554) | 554A0800 | 2 |
| "O" RING,16MM (Ref # 670) | 670B2016 | 2 |