

1982 KE175 PARTS DIAGRAM

SIDE COVERS/CHAIN COVER ('82-'83 KE175-D)

F2610-0149

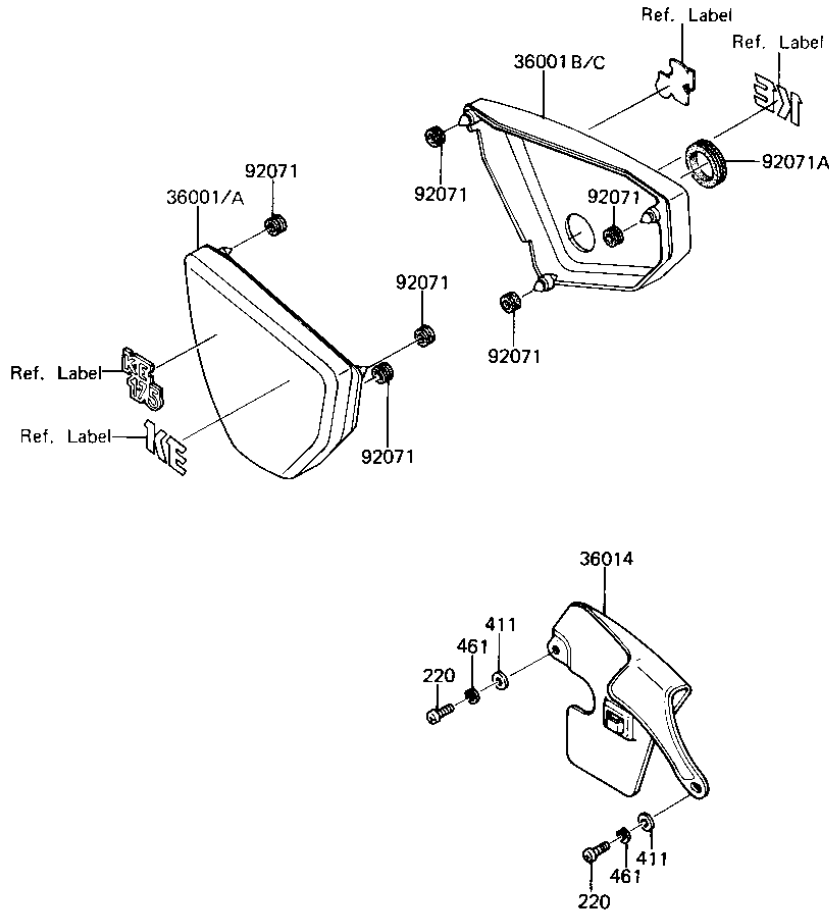

1982 KE175 PARTS LIST

SIDE COVERS/CHAIN COVER ('82-'83 KE175-D)

| ITEM NAME | PART NUMBER | QUANTITY |
|-------------------------------------|---------------|----------|
| COVER,SIDE,L.H,F.RED (Ref # 36001A) | 36001-1026-6L | 1 |
| COVER,SIDE,R.H,F.RED (Ref # 36001C) | 36001-1031-6L | 1 |
| CASE-CHAIN (Ref # 36014) | 36014-1007 | 1 |
| GROMMET (Ref # 92071) | 92071-056 | 6 |
| GROMMET,L.H SIDE COV (Ref # 92071A) | 92071-080 | 1 |
| SCREW PAN HEAD 6X16 (Ref # 220) | 220B0616 | 2 |
| WASHER PLAIN 6MM (Ref # 411) | 411B0600 | 2 |
| WASHER SPRING 6MM (Ref # 461) | 461F0600 | 2 |