

1980 JS440 PARTS DIAGRAM

CRANKSHAFT/PISTONS ('79-'81 A3/A4/A4A/A5)

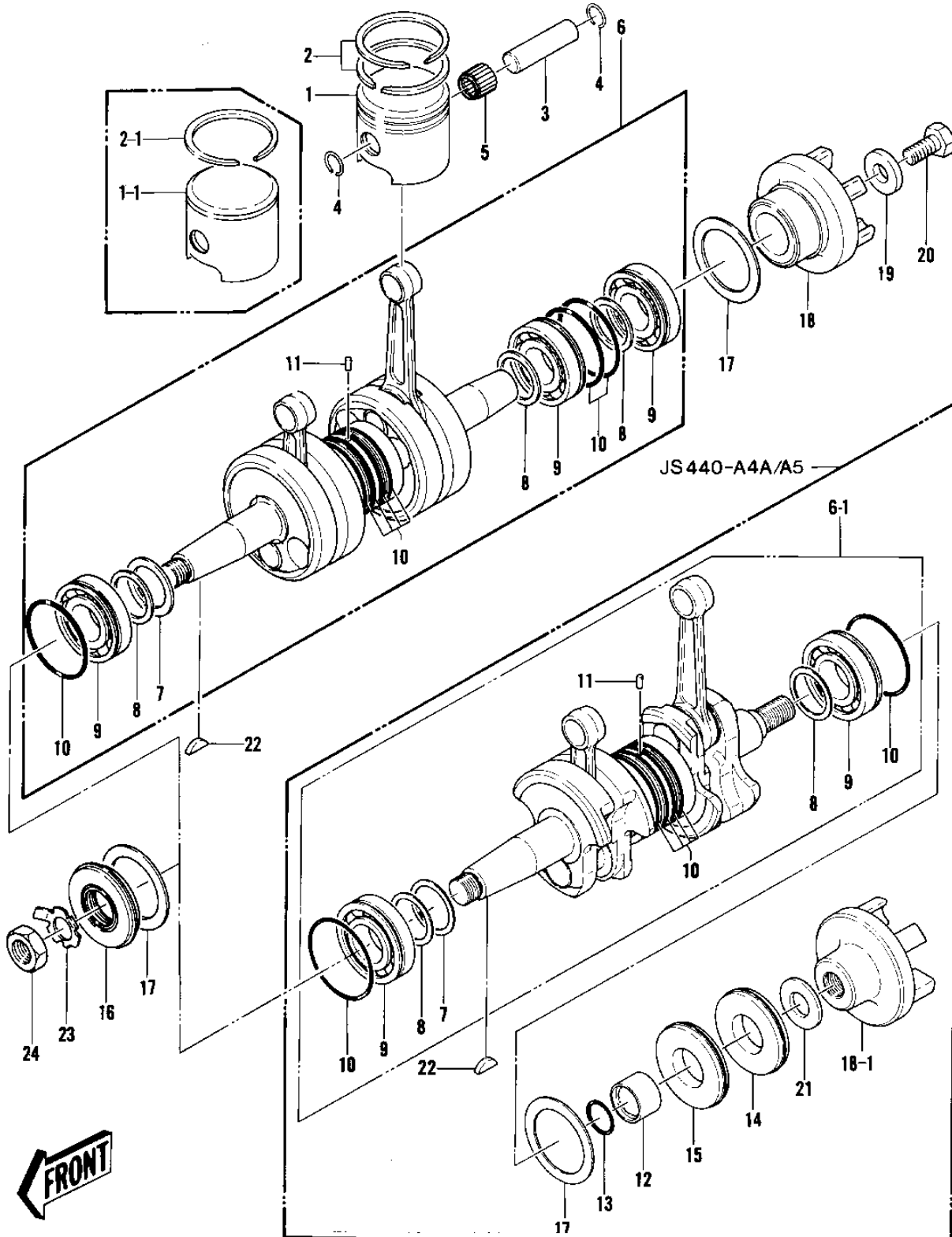

F

1980 JS440 PARTS LIST

CRANKSHAFT/PISTONS ('79-'81 A3/A4/A4A/A5)

| ITEM NAME | PART NUMBER | QUANTITY |
|----------------------------------|-------------|----------|
| PISTON-ENGINE,STD (Ref # 1-1) | 13001-3017 | 2 |
| PISTON-ENGINE,0.50 (Ref # 1-1) | 13029-3001 | (2 |
| RING-PISTON TOP,STD (Ref # 2-1) | 13003-3014 | 2 |
| RING-PISTON TOP,0.50 (Ref # 2-1) | 13003-3015 | 2 |
| PIN-PISTON (Ref # 3) | 13002-504 | 2 |
| CIRCLIP PISTON PIN (Ref # 4) | 92036-004 | 4 |
| CIRCLIP PISTON PIN (Ref # 4) | 92036-004 | 4 |
| BEARING-SMALL END (Ref # 5) | 13033-3005 | 2 |
| BEARING-SMALL END (Ref # 5) | 13033-3005 | 2 |
| CRANKSHAFT ASSY, (Ref # 6-1) | 13031-3011 | 1 |
| SHIM-1.0T (Ref # 7) | 92025-532 | 1 |
| SHIM 0.1T (Ref # 8) | 92025-513 | AR |
| SHIM 0.2T (Ref # 8) | 92025-518 | AR |
| SHIM 0.3T (Ref # 8) | 92025-523 | AR |
| SHIM 0.4T (Ref # 8) | 92025-527 | AR |
| SHIM 0.5T (Ref # 8) | 92025-530 | AR |
| SHIM 0.6T (Ref # 8) | 92025-533 | AR |
| BEARING-BALL (Ref # 9) | 92045-505 | 2 |
| O-RING (Ref # 10) | 92055-504 | 6 |
| PIN,DOWEL (Ref # 11) | 551A0410 | 1 |
| SLEEVE,CRANKSHAFT OUT (Ref # 12) | 42036-3007 | 1 |
| "0" RING,CRANKSHAFT (Ref # 13) | 92055-3009 | 1 |
| SEAL-OIL,TCY306210 (Ref # 14) | 92049-3005 | 1 |
| SEAL-OIL,DCY30629 (Ref # 15) | 92049-3006 | 1 |
| SEAL,OIL TCY306210 (Ref # 16) | 92050-507 | 1 |
| WASHER (Ref # 17) | 92022-3021 | 2 |
| COUPLING (Ref # 18-1) | 42034-3706 | 1 |
| WASHER,18.5X38X4 (Ref # 21) | 92022-3028 | 1 |
| WOODRUFF KEY (Ref # 22) | 510A5200 | 1 |