

1982 KX80 PARTS DIAGRAM

FENDERS ('81 KX80-C1)

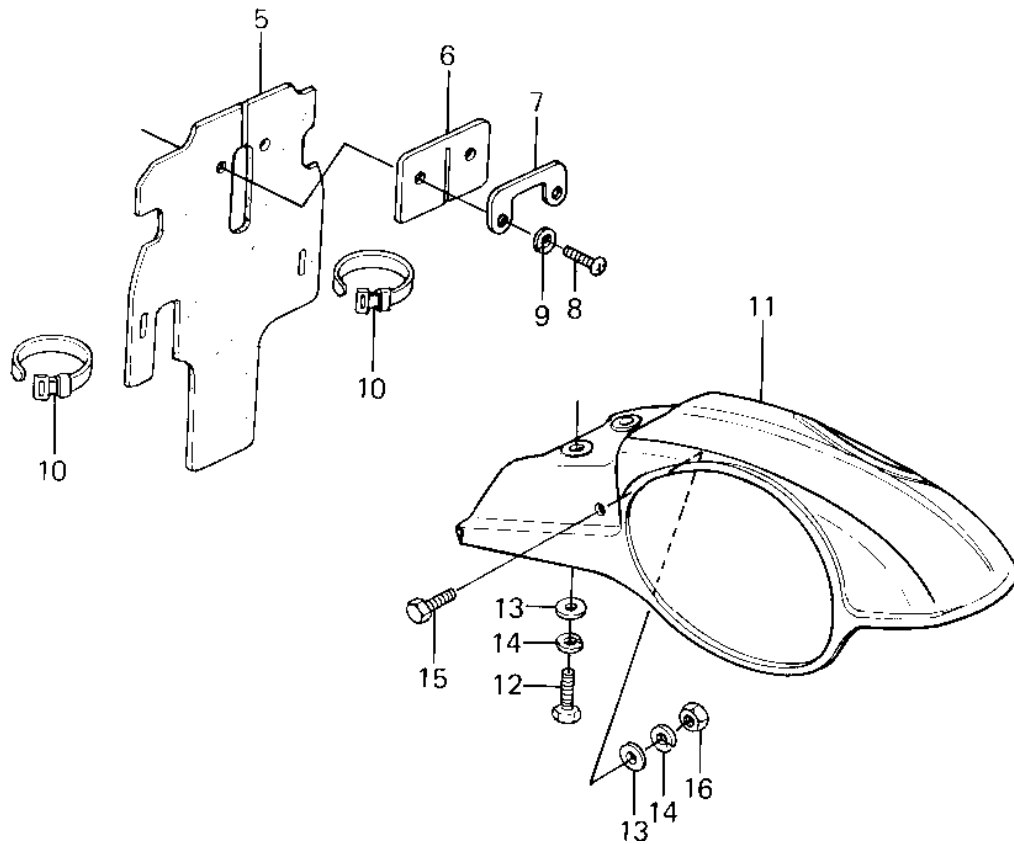
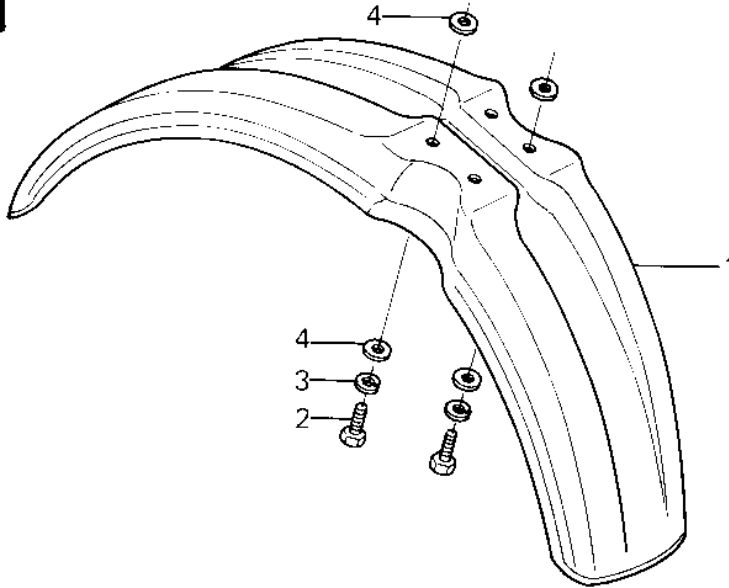

1982 KX80 PARTS LIST

FENDERS ('81 KX80-C1)

| ITEM NAME | PART NUMBER | QUANTITY |
|-------------------------------|---------------|----------|
| FENDER-FR,L.GREEN (Ref # 1) | 35004-1055-6W | 1 |
| BOLT-UPSET (Ref # 2) | 112G0618 | 4 |
| WASHER SPRING 6MM (Ref # 3) | 461F0600 | 4 |
| WASHER 6.5X20X1.6T (Ref # 4) | 92022-125 | 8 |
| FLAP,FENDER (Ref # 5) | 35019-1024 | 1 |
| FLAP,REAR FENDER (Ref # 6) | 35019-1019 | 1 |
| PLATE,REAR FLAP (Ref # 7) | 13169-1407 | 1 |
| SCREW PAN HEAD 6X14 (Ref # 8) | 220B0614 | 2 |
| WASHER SPRING 6MM (Ref # 9) | 461F0600 | 2 |
| BAND,SHORT (Ref # 10) | 92072-030 | 2 |
| FENDER-RR,L.GREEN (Ref # 11) | 35022-1089-AE | 1 |
| BOLT-UPSET,6X16 (Ref # 12) | 112G0616 | 2 |
| WASHER 6.5X20X1.6T (Ref # 13) | 92022-125 | 4 |
| WASHER SPRING 6MM (Ref # 14) | 461F0600 | 4 |
| BOLT-UPSET,6X20 (Ref # 15) | 112G0620 | 2 |
| NUT 6MM (Ref # 16) | 311B0600 | 2 |