

1968 Sidewinder PARTS DIAGRAM

HEADLIGHT

Rt
—

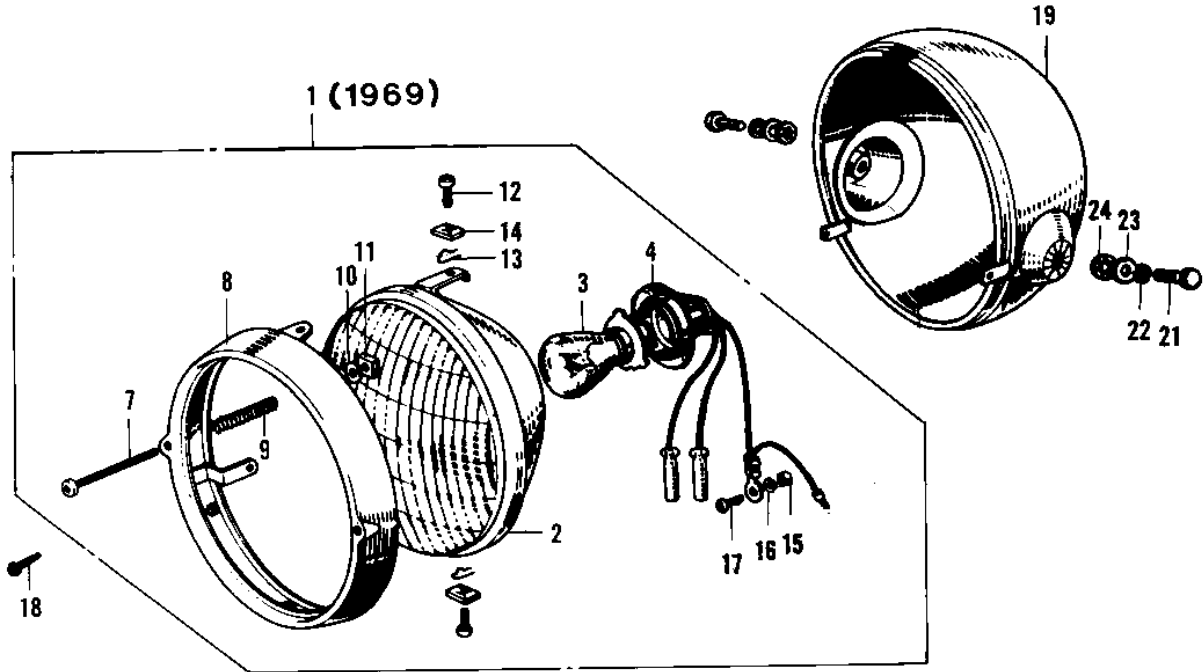

FRONT ←

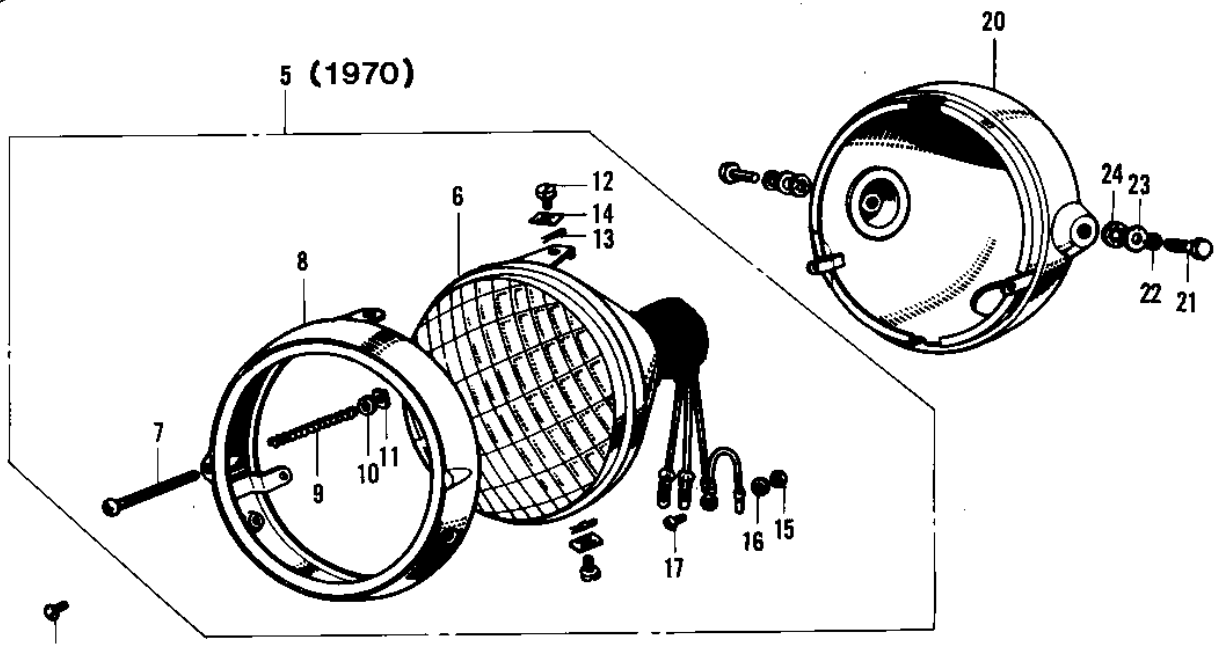

1008-1

1968 Sidewinder PARTS LIST

HEADLIGHT

ITEM NAME	PART NUMBER	QUANTITY
LAMP UNIT HEAD (Ref # 1)	23004-021	
LENS UNIT HEAD LAMP (Ref # 2)	23007-011	
BULB 12V 35/25W (Ref # 3)	92069-037	
SOCKET HEAD LAMP (Ref # 4)	23008-011	
LAMP UNIT HEAD (Ref # 5)	23003-010	
SEALED BEAM UNIT (Ref # 6)	23007-026	
SCREW FOCUS ADJUST (Ref # 7)	23019-017	
SCREW FORCUS ADJUST (Ref # 7)	23019-021	
RIM HEAD LAMP (Ref # 8)	23006-014	
SPRING FOCUS ADJUST (Ref # 9)	23014-005	
WASHER (Ref # 10)	23021-004	
NUT (Ref # 11)	23020-010	
NUT (Ref # 11)	23020-016	
SCREW LENS UNIT FITT (Ref # 12)	23019-018	
PIN LENS UNIT FITTING (Ref # 13)	23022-001	
NUT LENS UNIT FITTING (Ref # 14)	23020-009	
NUT-HEX (Ref # 15)	311B0300	
NUT-HEX (Ref # 15)	311B0300	
WASHER SPRING 3MM (Ref # 16)	461F0300	
SCREW PAN HEAD 3X6 (Ref # 17)	211B0306	
SCREW-PAN-HEAD 3X6 (Ref # 17)	220B0306	
SCREW OVL CNTSNK 5X8 (Ref # 18)	222E0508A	
SCREW OVL CNTSNK 5X10 (Ref # 18)	222E0510	
SCREW OVL CNTSNK 5X10 (Ref # 18)	222E0510	
BODY-HEAD LAMP,BLACK (Ref # 19)	23005-022-21	
UNAVAILABLE IN PRICE BOOK (Ref # 20)	23005-022-15	
BOLT,HEX HEAD,10X25 (Ref # 21)	92007-045	
WASHER SPRING 10MM (Ref # 22)	461F1000	
WASHER PLAIN 10MM (Ref # 23)	411B1000	