

# 1968 Sidewinder PARTS DIAGRAM

## CHASSIS ELECTRICAL EQUIPMENT

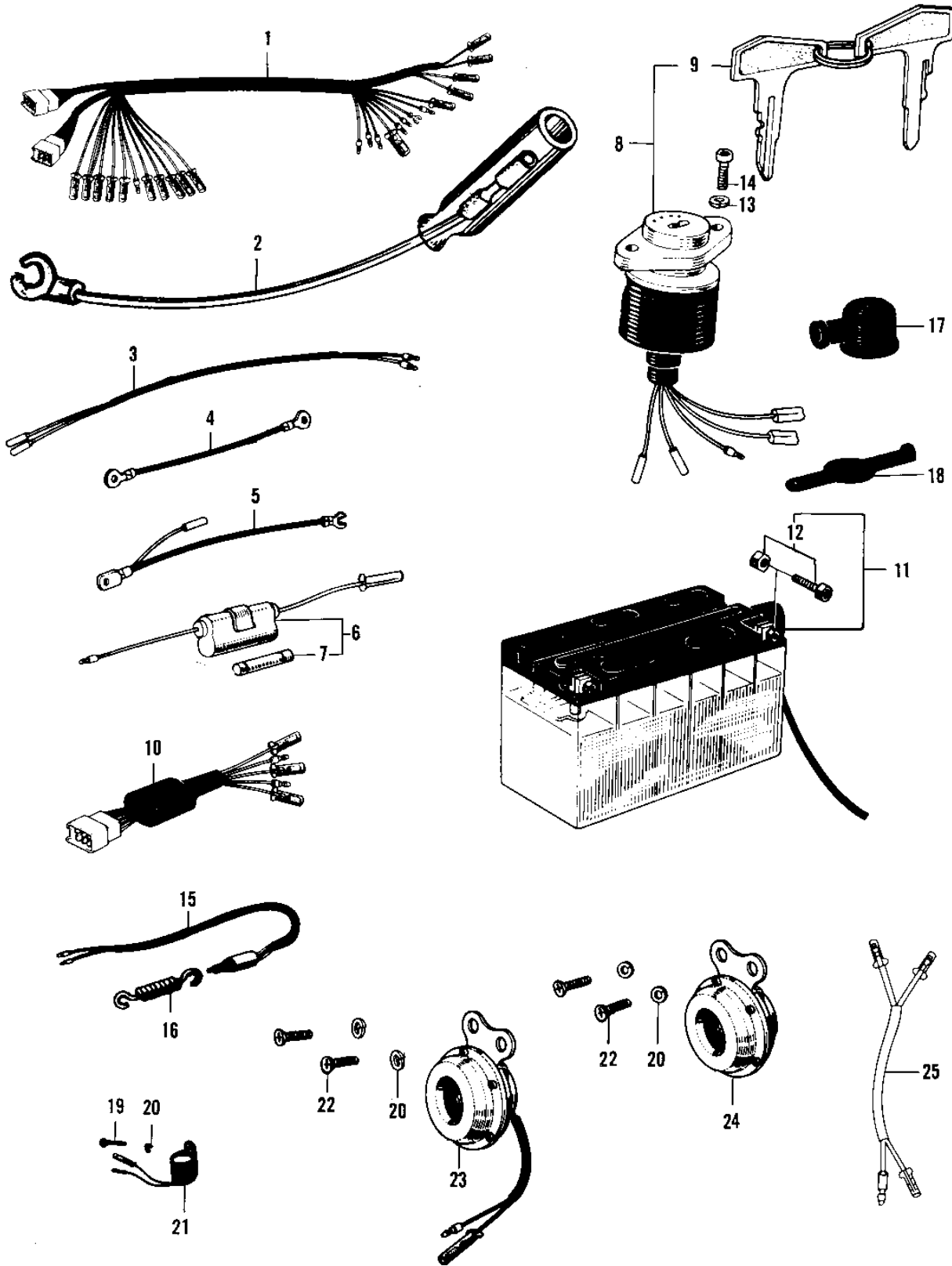

# 1968 Sidewinder PARTS LIST

## CHASSIS ELECTRICAL EQUIPMENT

ITEM NAME	PART NUMBER	QUANTITY
WIRING HARNESS MAIN (Ref # 1)	26001-035	
WIRE IGNITION LEAD (Ref # 2)	26011-014	
WIRING HARNESS REAR (Ref # 3)	26002-007	
WIRE BATTERY GROUND (Ref # 4)	26010-014	
WIRE BATTERY LEAD (Ref # 5)	26011-024	
FUSE ASSY (Ref # 6)	26004-026	
FUSE 10A (Ref # 7)	26006-001	
UNAVAILABLE IN PRICE BOOK (Ref # 8)	27006-029	
KEY SET NO121 (Ref # 9)	27008-026-21	
KEY SET NO122 (Ref # 9)	27008-026-22	
KEY SET NO123 (Ref # 9)	27008-026-23	
KEY SET NO124 (Ref # 9)	27008-026-24	
WIRING HARNESS HD LMP (Ref # 10)	26002-018	
YUA BAT 12N5.5-4A (Ref # 11)	K26012-022	
SCREW BATTERY TERMINAL (Ref # 12)	26013-001	
WASHER SPRING 5MM (Ref # 13)	461F0500	
SCREW PAN HEAD 5X8 (Ref # 14)	220B0508	
SCREW PAN HEAD 5X8 (Ref # 14)	220B0508	
SWITCH BRAKE LAMP (Ref # 15)	27010-006	
SPRING BRAKE LAMP SW (Ref # 16)	27011-006	
CAP BAT TERMINAL RUBB (Ref # 17)	92073-001	
BAND RUBBER (Ref # 18)	92072-013	
SCREW PAN HEAD 6X12 (Ref # 19)	220B0612	
WASHER SPRING 6MM (Ref # 20)	461F0600	
RELAY TURN SIGNAL (Ref # 21)	27002-008	
SCREW PAN HEAD 6X14 (Ref # 22)	220B0614	
HORN (Ref # 23)	27003-016	
HORN (Ref # 24)	27003-022	
LEAD WIRE-HORN (Ref # 25)	26002-022	