

1982 CSR Belt PARTS DIAGRAM

METERS

F2530-0090

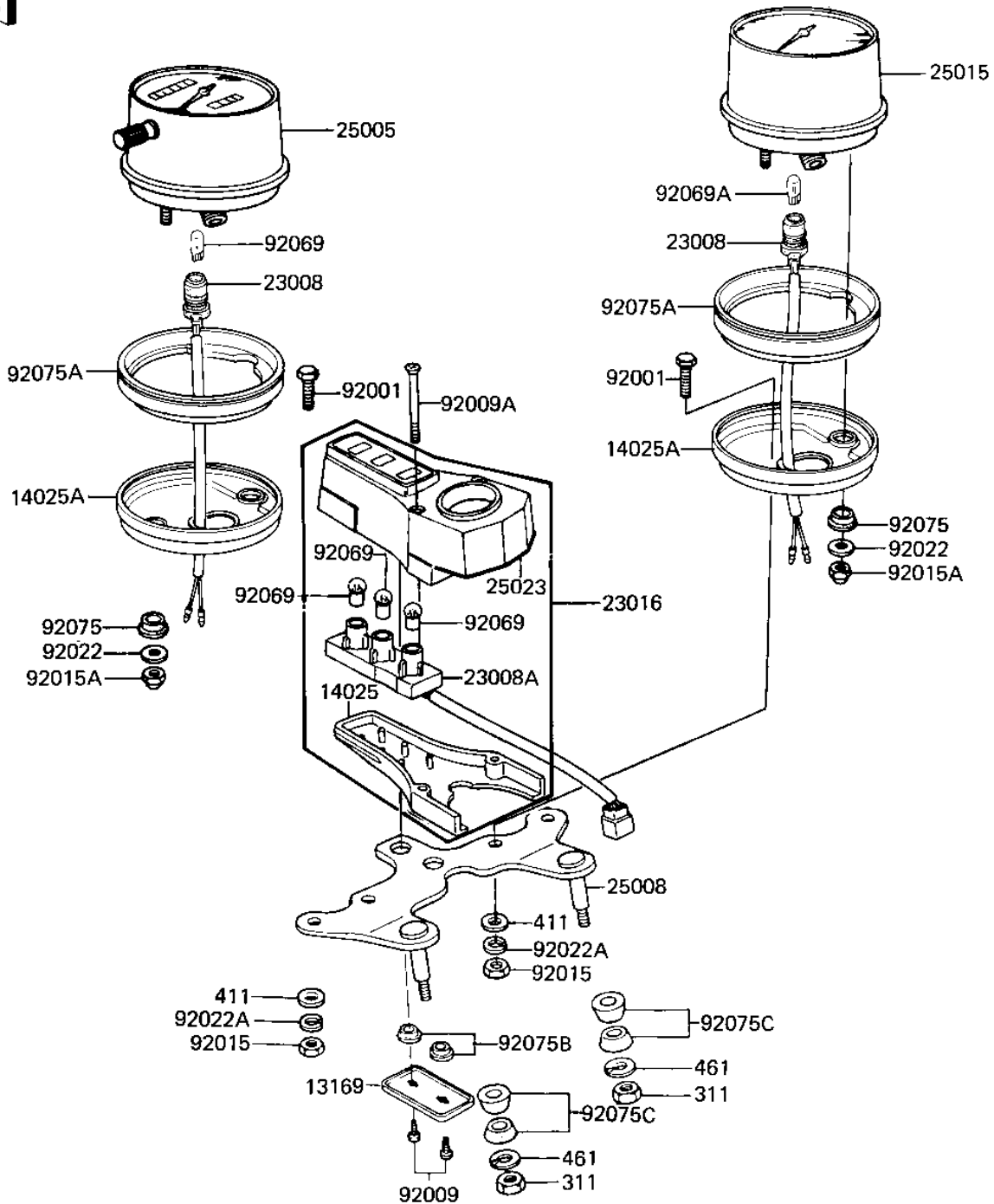

1982 CSR Belt PARTS LIST

METERS

ITEM NAME	PART NUMBER	QUANTITY
PLATE,PILOT LAMP (Ref # 13169)	13169-1136	1
COVER,METER BRACKET (Ref # 14025)	14025-1101	1
COVER,METER (Ref # 14025A)	25012-025	2
SOCKET-ASSY (Ref # 23008)	23008-1116	2
SOCKET ASSY,INDICATOR (Ref # 23008A)	25011-056	1
LAMP ASSY,PILOT (Ref # 23016)	23016-1017	1
SPEEDOMETER,MPH (Ref # 25005)	25005-1060	1
BRACKET,METER (Ref # 25008)	25008-1013	1
TACHOMETER ASSY (Ref # 25015)	25015-1016	1
COVER,INDICATOR LAMP (Ref # 25023)	25023-1018	1
BOLT,HEX HEAD,6X14 (Ref # 92001)	92003-204	4
SCREW,TAPPING,4X10 (Ref # 92009)	92009-1040	2
SCREW-CSK-RD-CROS,4X4 (Ref # 92009A)	222C0445	2
NUT (Ref # 92015)	92015-078	4
NUT-CAP,5MM (Ref # 92015A)	322C0500	4
WASHER,5.2X16X16X1.2T (Ref # 92022)	25009-004	4
WASHER-SPRING,6MM,BLA (Ref # 92022A)	461K0600	4
BULB 12V 3W (Ref # 92069)	92069-018	3
BULB,12V3.4W (Ref # 92069A)	92069-1007	2
DAMPER RUBBER-METER (Ref # 92075)	25019-013	4
SHOCK DAMPER,SPEEDMET (Ref # 92075A)	25019-031	2
DAMPER,PILOT LAMP (Ref # 92075B)	92075-1138	2
DAMPER RUBBER,METER (Ref # 92075C)	92075-248	4
NUT 6MM (Ref # 311)	311B0600	2
WASHER PLAIN 6MM (Ref # 411)	411B0600	4
WASHER SPRING 6MM (Ref # 461)	461F0600	2