

1982 KX125 PARTS DIAGRAM

CLUTCH

E1350-0061

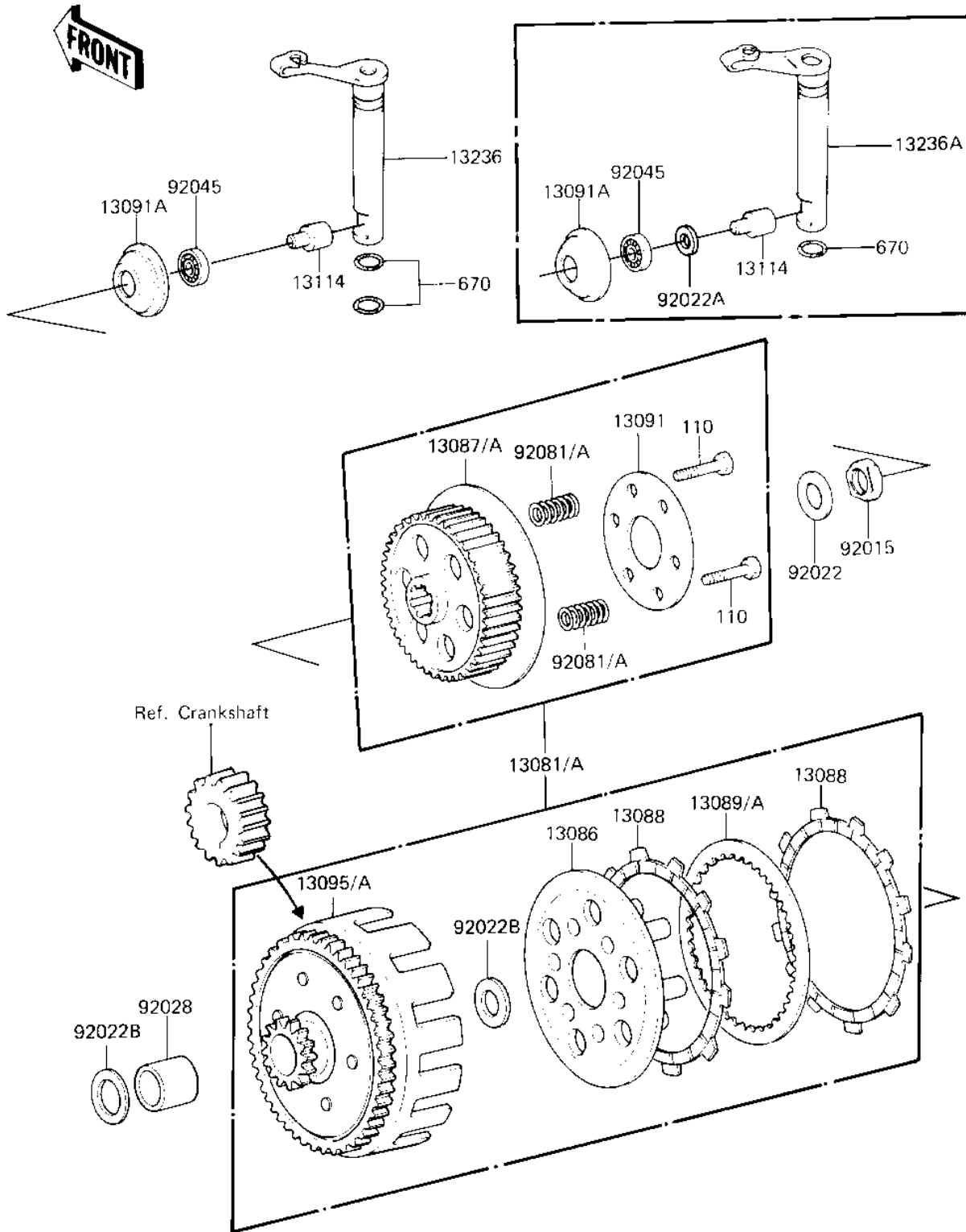

1982 KX125 PARTS LIST

CLUTCH

| ITEM NAME | PART NUMBER | QUANTITY |
|-------------------------------------|-------------|----------|
| CLUTCH-ASSY (Ref # 13081) | 13081-1072 | 1 |
| WHEEL,CLUTCH (Ref # 13086) | 13086-1001 | 1 |
| HUB,CLUTCH (Ref # 13087) | 13087-1002 | 1 |
| PLATE-FRICTION (Ref # 13088) | 13088-1015 | 6 |
| PLATE,CLUTCH STEEL (Ref # 13089A) | 13089-1002 | 5 |
| HOLDER,CLUTCH (Ref # 13091) | 13091-1011 | 1 |
| HOLDER,CLUTCH PUSHER (Ref # 13091A) | 13091-1134 | 1 |
| HOUSING-COMP-CLUTCH (Ref # 13095) | 13095-1041 | 1 |
| PUSHER,CLUTCH (Ref # 13114) | 13114-1008 | 1 |
| LEVER-COMP,CLUTCH REL (Ref # 13236) | 13236-1039 | 1 |
| NUT,16MM (Ref # 92015) | 92015-1176 | 1 |
| WASHER,16.8X32X1.6 (Ref # 92022) | 92022-1277 | 1 |
| WASHER,PLAIN (Ref # 92022B) | 92022-270 | 2 |
| BUSHING,17X22X21.1 (Ref # 92028) | 92028-1149 | 1 |
| BEARING,BALL #627 (Ref # 92045) | 92045-026 | 1 |
| SPRING,CLUTCH (Ref # 92081) | 92081-123 | 6 |
| BOLT (Ref # 110) | 110G0520 | 6 |
| "O"RING 10MM (Ref # 670) | 670B1510 | 2 |