

# 1983 KX125 PARTS DIAGRAM

## CLUTCH

E1350-0061

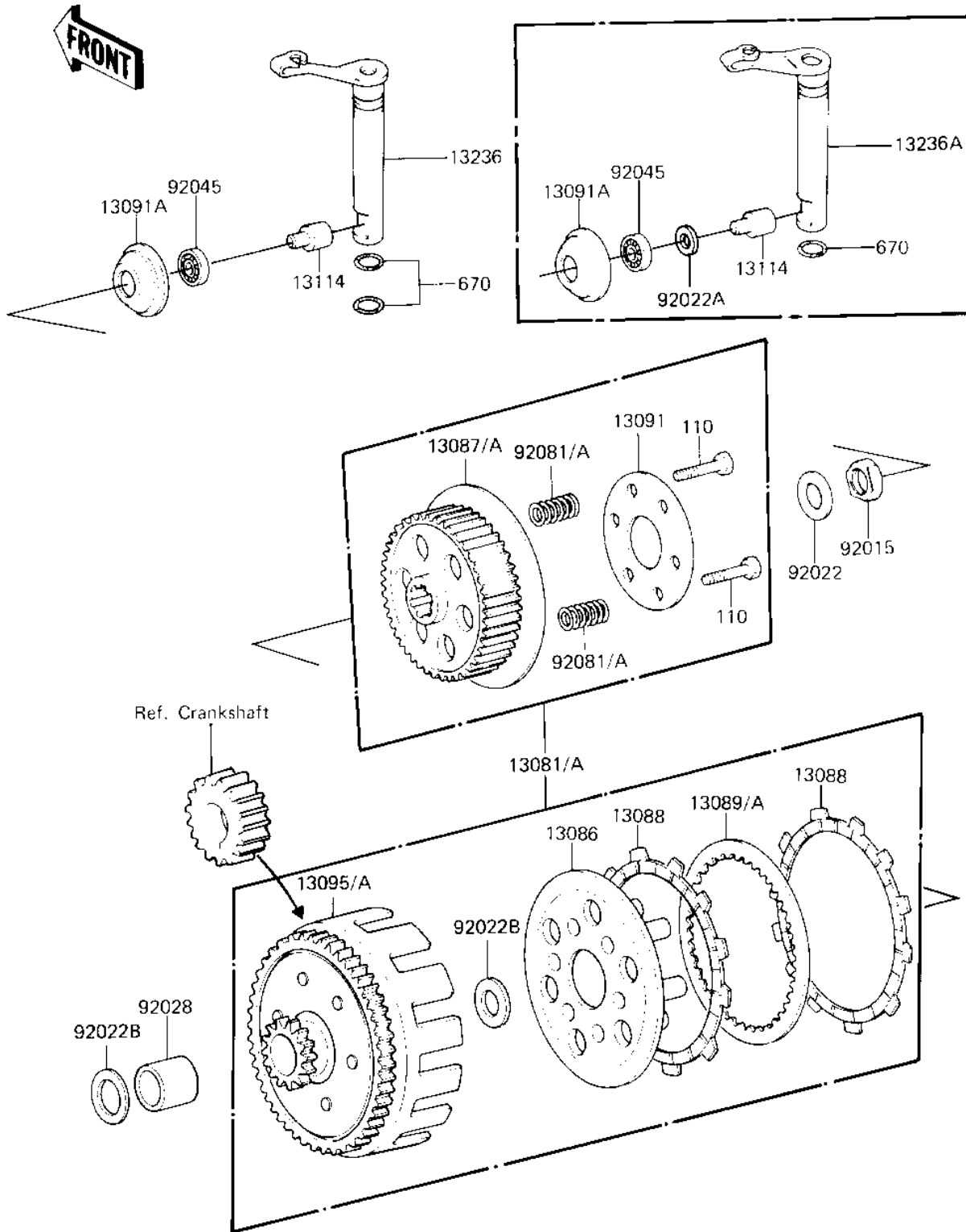

# 1983 KX125 PARTS LIST

## CLUTCH

ITEM NAME	PART NUMBER	QUANTITY
CLUTCH-ASSY (Ref # 13081A)	13081-1103	1
WHEEL,CLUTCH (Ref # 13086)	13086-1001	1
HUB-CLUTCH (Ref # 13087A)	13087-1022	1
PLATE-FRICTION (Ref # 13088)	13088-1015	7
PLATE CLUTCH STEEL (Ref # 13089)	13089-003	6
HOLDER,CLUTCH (Ref # 13091)	13091-1011	1
HOLDER,CLUTCH PUSHER (Ref # 13091A)	13091-1134	1
HOUSING-COMP-CLUTCH (Ref # 13095A)	13095-1058	1
PUSHER,CLUTCH (Ref # 13114)	13114-1008	1
LEVER-COMP,CLUTCH REL (Ref # 13236A)	13236-1057	1
NUT,16MM (Ref # 92015)	92015-1176	1
WASHER,16.8X32X1.6 (Ref # 92022)	92022-1277	1
WASHER,7X12.5X0.8 (Ref # 92022A)	92022-1290	1
WASHER,PLAIN (Ref # 92022B)	92022-270	2
BUSHING,17X22X21.1 (Ref # 92028)	92028-1149	1
BEARING,BALL #627 (Ref # 92045)	92045-026	1
SPRING,CLUTCH (Ref # 92081A)	92081-1506	6
BOLT (Ref # 110)	110G0520	6
"O"RING 10MM (Ref # 670)	670B1510	1