

# 1983 Spectre PARTS DIAGRAM

## MUFFLERS

E1140-0119

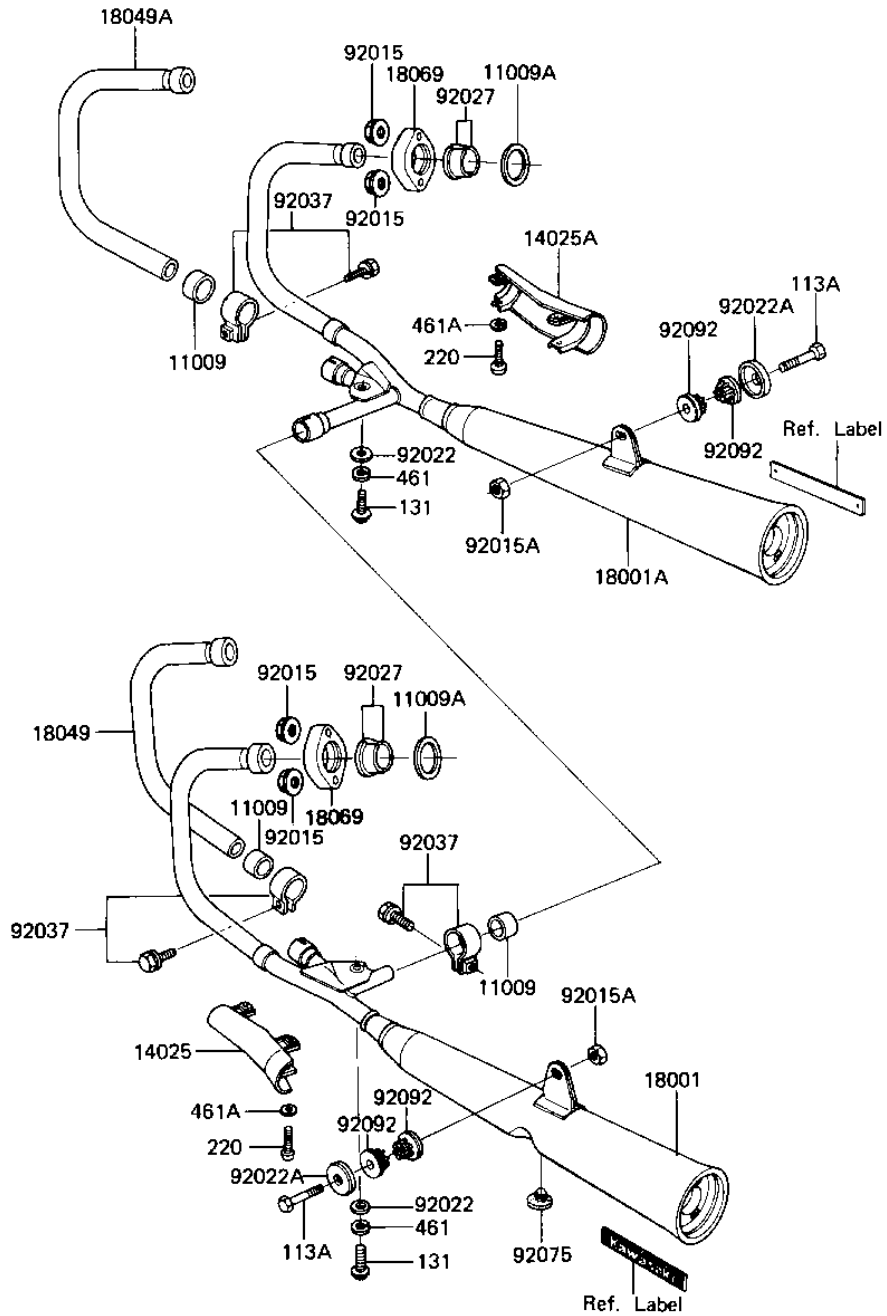

# 1983 Spectre PARTS LIST

## MUFFLERS

| ITEM NAME                            | PART NUMBER | QUANTITY |
|--------------------------------------|-------------|----------|
| GASKET,MANIFOLD EXHAU (Ref # 11009)  | 11060-1068  | 3        |
| GASKET,EXHAUST PIPE H (Ref # 11009A) | 11009-1906  | 4        |
| COVER,MUFFLER,LH,BLAC (Ref # 14025)  | 14025-1412  | 1        |
| COVER,MUFFLER,RH,BLAC (Ref # 14025A) | 14025-1413  | 1        |
| MUFFLER,L.H.BLACK (Ref # 18001)      | 18001-5080  | 1        |
| MUFFLER,RH,BLACK (Ref # 18001A)      | 18001-5081  | 1        |
| PIPE-EXHAUST,#2,BLACK (Ref # 18049)  | 18049-1192  | 1        |
| PIPE-EXHAUST,#3,BLACK (Ref # 18049A) | 18049-1193  | 1        |
| HOLDER-EXHAUST PIPE (Ref # 18069)    | 18069-1019  | 4        |
| NUT,CAP,8MM,BLACK (Ref # 92015)      | 92015-1174  | 8        |
| NUT,LOCK,10MM (Ref # 92015A)         | 92019-021   | 2        |
| WASHER,PLAIN (Ref # 92022)           | 92022-1022  | 2        |
| WASHER,CUP TYPE,BLACK (Ref # 92022A) | 92022-1313  | 2        |
| COLLAR,EXHAUST PIPE,B (Ref # 92027)  | 92027-1457  | 8        |
| CLAMP,MUFFLER,BLACK (Ref # 92037)    | 92037-1270  | 3        |
| DAMPER RUBBER,MAIN ST (Ref # 92075)  | 92075-1002  | 1        |
| BUSHING-RUBBER (Ref # 92092)         | 92092-1013  | 4        |
| BOLT HEX HEAD 10X80 (Ref # 113)      | 113B1080    | 2        |
| BOLT-FLANGED,10X55 (Ref # 131)       | 131J1055    | 2        |
| SCREW-PAN-CROS,6X45,B (Ref # 220)    | 220C0645    | 4        |
| WASHER SPRING 10MM (Ref # 461)       | 461F1000    | 2        |
| WASHER-SPRING,6MM,BLA (Ref # 461A)   | 461K0600    | 4        |