

1983 Spectre PARTS DIAGRAM

METERS (KZ1100-D2)

F2030-U109

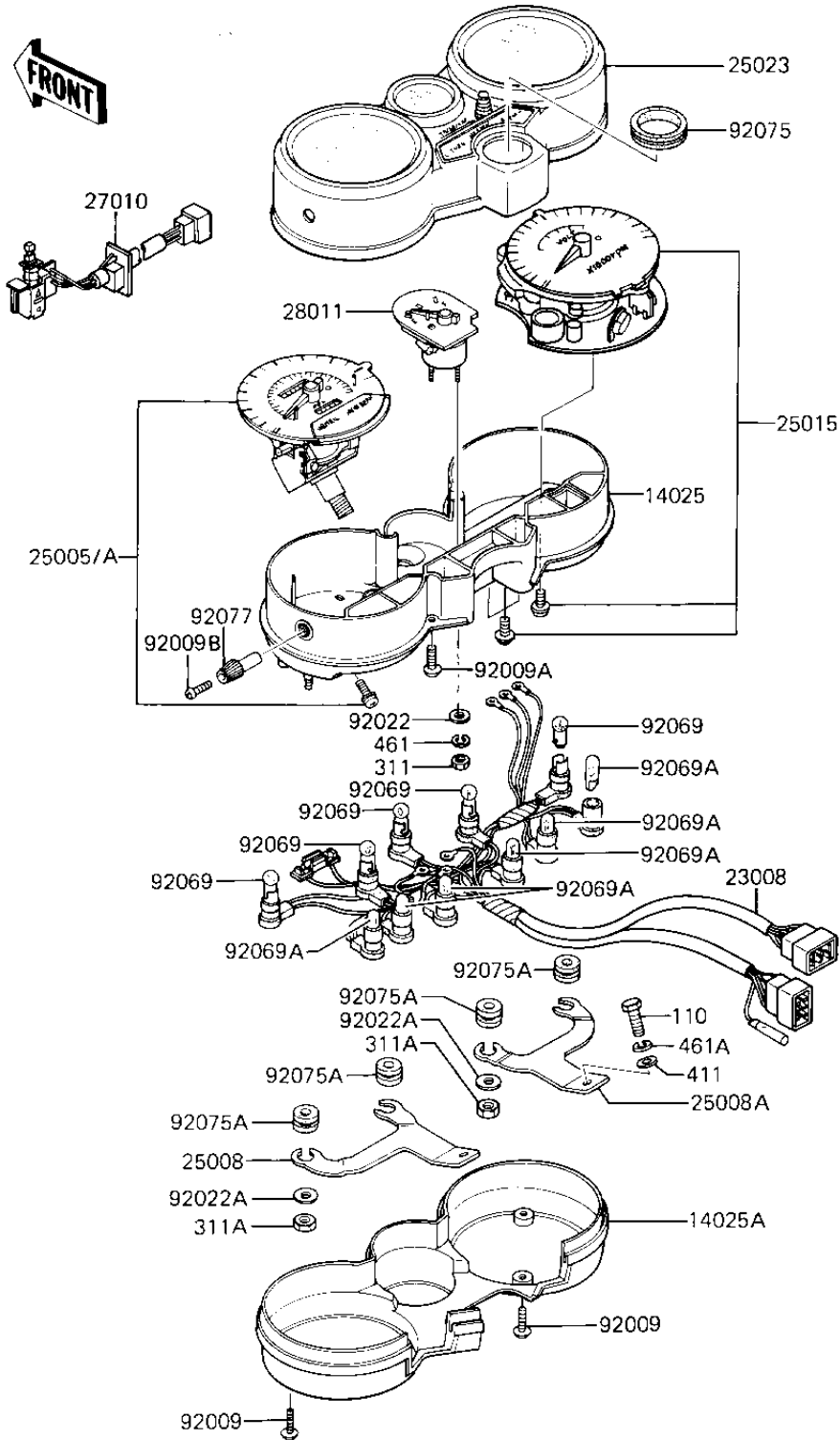

1983 Spectre PARTS LIST

METERS (KZ1100-D2)

ITEM NAME	PART NUMBER	QUANTITY
COVER,METER HOUSING (Ref # 14025)	14025-1594	1
COVER,METER CASE,LWR (Ref # 14025A)	14025-1595	1
SOCKET-ASSY,METER (Ref # 23008)	23008-1174	1
SPEEDOMETER,MPH (Ref # 25005)	25005-1202	1
SPEEDOMETER,KPH (Canada) (Ref # 25005A)	25005-1203	1
BRACKET-METER,LH (Ref # 25008)	25008-1053	1
BRACKET-METER,RH (Ref # 25008A)	25008-1054	1
TACHOMETER,X1000RPM (Ref # 25015)	25015-1136	1
COVER-METER CASE,UPP (Ref # 25023)	25023-1045	1
SWITCH TACHO/JOLT (Ref # 27010)	27010-1090	1
METER,FUEL (Ref # 28011)	28011-1033	1
SCREW,4X16,BLACK (Ref # 92009)	92009-1158	4
SCREW,TAPPING,4X16 (Ref # 92009A)	92009-1163	4
SCREW,2X6,BLACK (Ref # 92009B)	92009-1172	1
WASHER (Ref # 92022)	92022-1374	3
WASHER,PLAIN,6MM (Ref # 92022A)	92022-263	4
BULB 12V 1.5W (Ref # 92069)	92069-017	5
BULB,12V3.4W (Ref # 92069A)	92069-1007	6
DAMPER RUBBER (Ref # 92075)	92075-1256	1
DAMPER,METER BRACKET (Ref # 92075A)	92075-1435	4
KNOB,METER (Ref # 92077)	92077-1015	1
BOLT, 6X14, BLACK (Ref # 110)	112C0614	2
NUT-HEX (Ref # 311)	311B0300	3
NUT,5MM (Ref # 311A)	311B0500	4
WASHER PLAIN (Ref # 411)	411F0600	2
WASHER SPRING 3MM (Ref # 461)	461F0300	3
WASHER-SPRING,6MM,BLA (Ref # 461A)	461K0600	2