

2005 Prairie 360 4X4 Hardwoods Green HD PARTS DIAGRAM

Front Bevel Gear

E3131

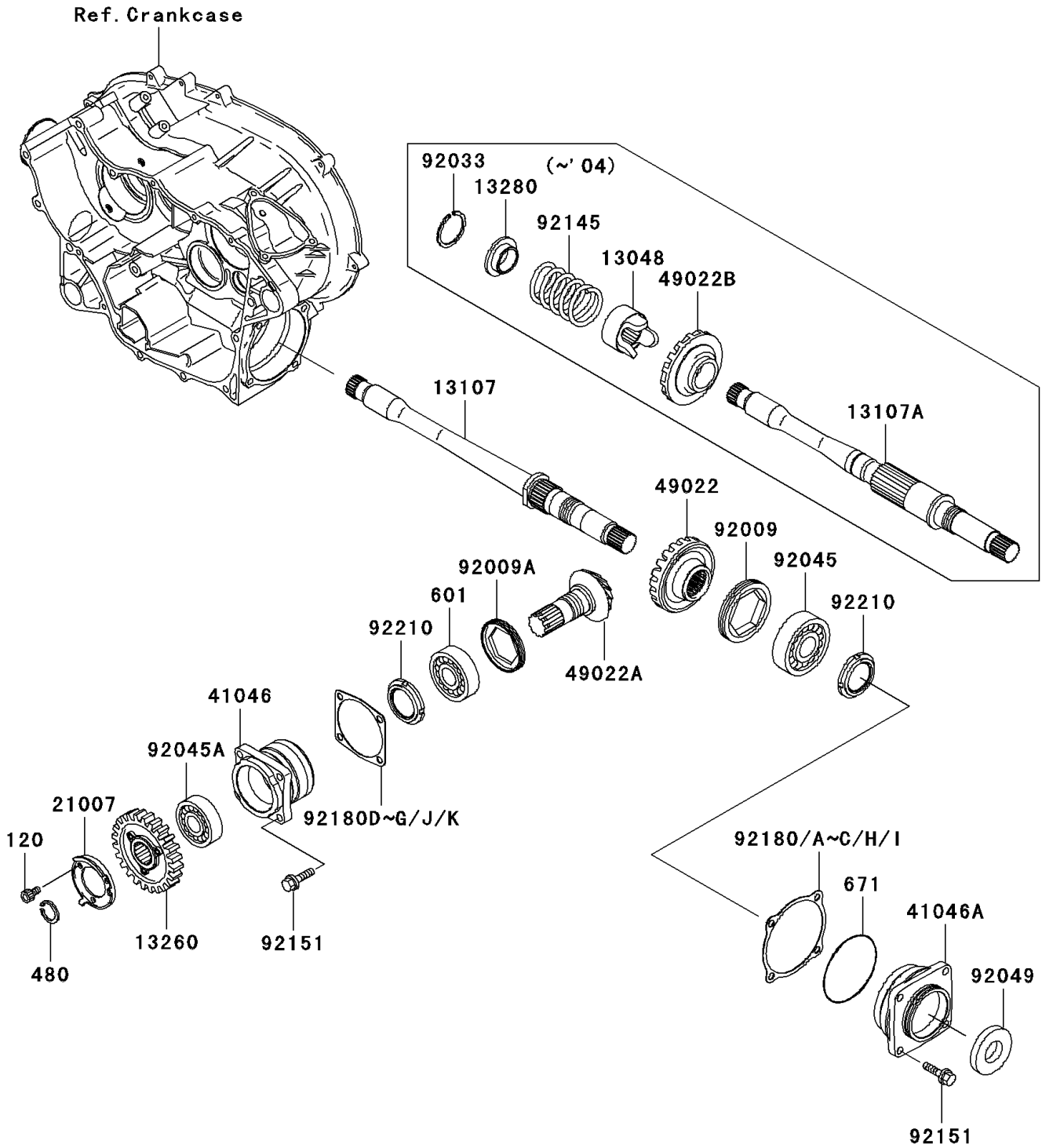

2005 Prairie 360 4X4 Hardwoods Green HD PARTS LIST

Front Bevel Gear

ITEM NAME	PART NUMBER	QUANTITY
BOLT-SOCKET,6X12 (Ref # 120)	120P0612	3
CIRCLIP-TYPE-C,28MM (Ref # 480)	480J2800	1
BEARING-BALL,#6206C3 (Ref # 601)	601B6206	1
O RING (Ref # 671)	671D2585	1
SHAFT (Ref # 13107)	13107-0027	1
GEAR,OUTPUT 29T (Ref # 13260)	13260-1922	1
ROTOR,REVERSE SENSOR (Ref # 21007)	21007-1416	1
HOUSING-BEARING (Ref # 41046)	41046-1101	1
HOUSING-BEARING (Ref # 41046A)	41046-1102	1
GEAR-BEVEL,DRIVEN,21T (Ref # 49022)	49022-0020	1
GEAR-BEVEL,DRIVE,20T (Ref # 49022A)	49022-1184	1
SCREW (Ref # 92009)	92009-1667	1
SCREW,64MM (Ref # 92009A)	92009-1914	1
BEARING-BALL,6306SH2 (Ref # 92045)	92045-1190	1
BEARING-BALL,62/28 (Ref # 92045A)	92045-1207	1
SEAL-OIL (Ref # 92049)	92049-1529	1
BOLT (Ref # 92151)	92151-1688	8
SHIM,DRIVEN,T=0.15 (Ref # 92180)	92180-1307	1
SHIM,DRIVEN,T=0.20 (Ref # 92180A)	92180-1308	1
SHIM,DRIVEN,T=0.50 (Ref # 92180B)	92180-1309	1
SHIM,DRIVEN,T=0.80 (Ref # 92180C)	92180-1310	1
SHIM,DRIVE,T=0.15 (Ref # 92180D)	92180-1311	1
SHIM,DRIVE,T=0.20 (Ref # 92180E)	92180-1312	1
SHIM,DRIVE,T=0.50 (Ref # 92180F)	92180-1313	1
SHIM,DRIVE,T=0.80 (Ref # 92180G)	92180-1314	1
SHIM,DRIVEN,T=1.00 (Ref # 92180H)	92180-1349	1
SHIM,DRIVEN,T=1.20 (Ref # 92180I)	92180-1350	1
SHIM,DRIVE,T=1.00 (Ref # 92180J)	92180-1351	1
SHIM,DRIVE,T=1.20 (Ref # 92180K)	92180-1352	1

2005 Prairie 360 4X4 Hardwoods Green HD PARTS LIST

Front Bevel Gear

ITEM NAME	PART NUMBER	QUANTITY
NUT,30MM (Ref # 92210)	92210-1294	2