

2009 Concoors™ 14 PARTS DIAGRAM

Transmission

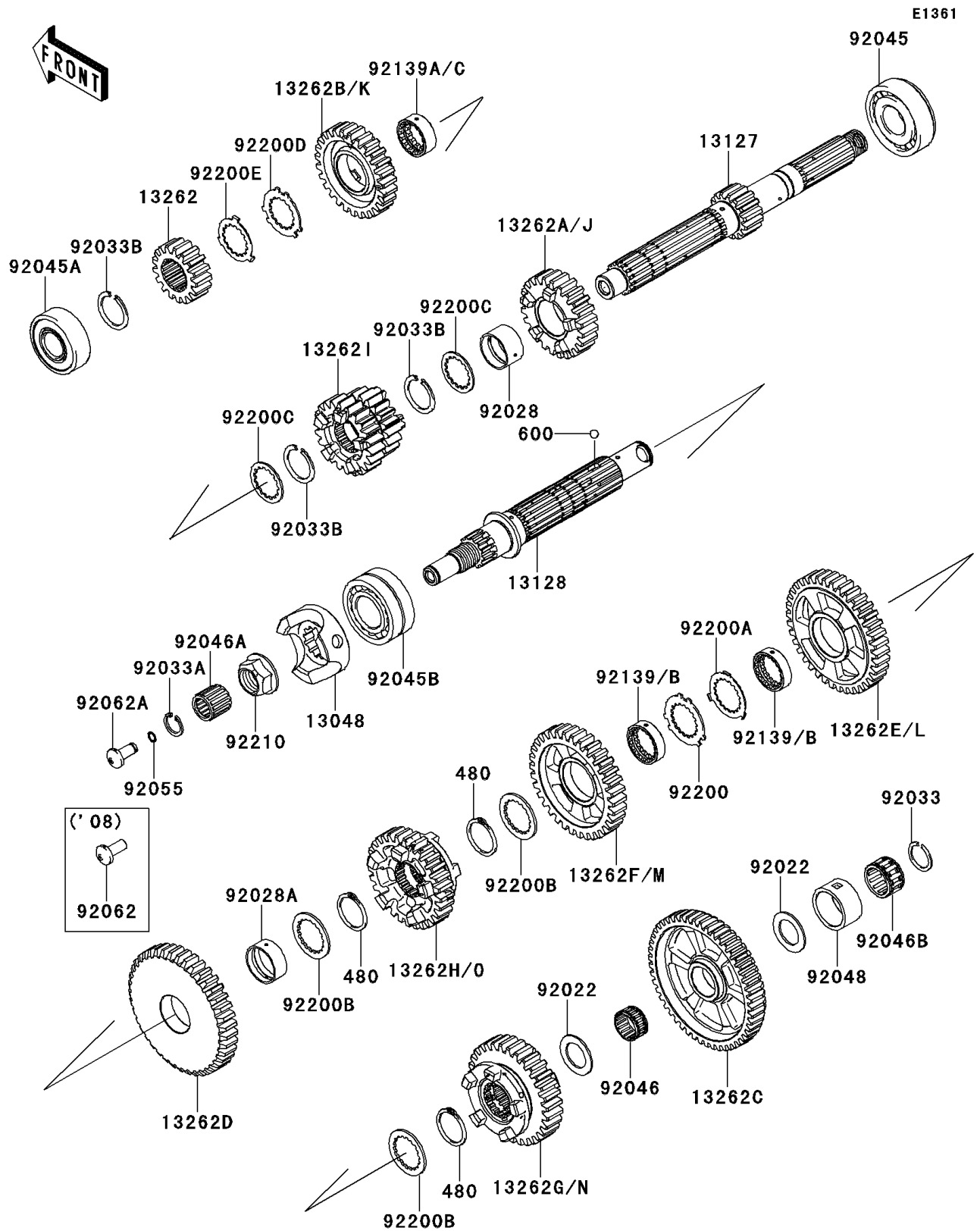

2009 Concours™ 14 PARTS LIST

Transmission

ITEM NAME	PART NUMBER	QUANTITY
CAM-DAMPER (Ref # 13048)	13048-0014	1
SHAFT-TRANSMISSION INPUT (Ref # 13127)	13127-0057	1
SHAFT-TRANSMISSION OUTPUT (Ref # 13128)	13128-0034	1
GEAR,INPUT 2ND,17T (Ref # 13262)	13262-0399	1
GEAR,OUTPUT LOW,50T (Ref # 13262C)	13262-0403	1
GEAR,OUTPUT 2ND,41T (Ref # 13262D)	13262-0404	1
GEAR,INPUT 3RD&4TH,20T&22T (Ref # 13262I)	13262-0588	1
GEAR,INPUT 5TH,24T (Ref # 13262J)	13262-0722	1
GEAR,INPUT 6TH,27T (Ref # 13262K)	13262-0723	1
GEAR,OUTPUT 3RD,38T (Ref # 13262L)	13262-0725	1
GEAR,OUTPUT 4TH,34T (Ref # 13262M)	13262-0726	1
GEAR,OUTPUT 5TH,31T (Ref # 13262N)	13262-0727	1
GEAR,OUTPUT 6TH,29T (Ref # 13262O)	13262-0728	1
WASHER,22.3X35X1.6 (Ref # 92022)	92022-212	2
BUSHING (Ref # 92028)	92028-1935	1
BUSHING (Ref # 92028A)	92028-1937	1
RING-SNAP,20X25.5X1.2 (Ref # 92033)	92033-025	1
RING-SNAP (Ref # 92033A)	92033-032	1
RING-SNAP,T=1.5 (Ref # 92033B)	92033-1249	3
BEARING-BALL,830045-5SH2 (Ref # 92045)	92045-0047	1
BEARING-BALL,DG2152RDDSH2 (Ref # 92045A)	92045-0048	1
BEARING-BALL (Ref # 92045B)	92045-0116	1
BEARING-NEEDLE,K22X26X13 (Ref # 92046)	92046-0018	1
BEARING-NEEDLE,FWF-162222 (Ref # 92046A)	92046-1260	1
BEARING-NEEDLE,K22X30X16.8X2 (Ref # 92046B)	92046-1268	1
RACE (Ref # 92048)	92048-0004	1
RING-O,6.5X1.0 (Ref # 92055)	92055-0171	1
NOZZLE (Ref # 92062A)	92062-0018	1
BUSHING (Ref # 92139B)	92139-0255	2

2009 Concours™ 14 PARTS LIST

Transmission

ITEM NAME	PART NUMBER	QUANTITY
BUSHING,INPUT 6TH,GEAR (Ref # 92139C)	92139-0256	1
CIRCLIP (Ref # 480)	480J2900	3
BALL-STEEL,5/32 (Ref # 600)	600A0500	3
WASHER,27.5X43X1.5 (Ref # 92200)	92200-0255	1
WASHER,27.5X39.7X1.0 (Ref # 92200A)	92200-0256	1
WASHER,TOOTHED,28X40X2 (Ref # 92200B)	92200-1277	3
WASHER,25.5X35.5X1.5 (Ref # 92200C)	92200-1340	2
WASHER,25.8X40.5X1.5 (Ref # 92200D)	92200-1522	1
WASHER,25.2X37.0X1.0 (Ref # 92200E)	92200-1523	1
NUT,20MM (Ref # 92210)	92210-0365	1